

PLEASANT TWP  
KENTON CORP

00350

Hardin County, Ohio  
Michael T. Bacon, Auditor

36-280098.0000  
YY29

RES  
2025

sale

Eff Rate:- 50.59 — 44.66 — 47.03 — 46.74 — a/r

2022	CARSON MICHAEL E	2010-06-11			
2023	CARSON MICHAEL E	2010-06-11			
2024	CARSON MICHAEL E	2010-06-11			
2025	CARSON MICHAEL E & TRIS	2024-02-02	KENTON COURT LOTS 98-100		
	303 GARFIELD AVE	2SD	VAC ALLEY		
	KENTON OH 43326	\$0			

Tax Year	2022	2023	2024	2025	CAMA
Prop Cls	510	510	510	510	510
Acres					
Land100%	7570	14400	14400	14400	14400
Bldg100%	119230	137940	137940	137940	137930
Totl100%	126800t	152340t	152340t	152340t	152330t
Cauv100%					
Tax Value:					
Land 35%	2650	5040	5040	5040	5040
Bldg 35%	41730	48280	48280	48280	48280
Totl 35%	44380t	53320t	53320t	53320t	53320t
Hmstd35%	41610	50320			
Owner Oc	40.36	44.54	44.48		
Hmstd RB					
Net Tax	2032.78	2147.80	2274.78	2303.98	
Sp-Asmnt	27.00	48.00	36.00	39.00	

SHB+	CONS	TYPE	FACT	SQ-FT	VALUE		
1 B	F	M		988		a	*MAIN
	F2	G		480	11520	b	GRAGE
	OFF	P		40	1200	c	PORCH
1	F/C	A		502		d	ADDTN
	PAT	P		457	1370	e	PORCH
	OFF	P		132	3960	f	PORCH

#: 99 100 L/W  
362800990000  
362801000000

Sale#	#p	sale date	To	Type/Invalid?	Sale\$	co:land	co:bldg
58	2	2024-02-02	CARSON MICHAEL E & TRISHA	2SD *	0	14400	137940
271	2	2010-06-11	CARSON MICHAEL E	2WD *	90000	5660	106860
31	2	2010-01-22	HOME SAVINGS & LOAN CO KE	2QC *	0	5660	106860
356	2	2002-07-11	LOHRBER PAUL A & SUSAN E	2WD	108000	4770	69710
379	6	1999-07-08	WILLIAMS THOMAS H & ROSA	ESD *	0	5030	48340
489	1	1991-06-25		LUN *	50000	0	35910
727	1	1989-08-30		LWD	30000	0	35910

Year	Land	Bldg	Total	Net Tax
2021	2650	41730	44380	2040.32
2020	2650	41730	44380	1766.58

project	ben acres	/ %	factor
131 BLANCHARD RIVER MAINT			XA/2025
500 HARDIN COUNTY LANDFILL			XA/2025
235 KELLOGG #983 - BLANCHARD			XA/2025
921 BLANCHARD RIVER MAINT			XA/2023
336 DULIN #1099 - BLANCHARD MAIN			XA/2025

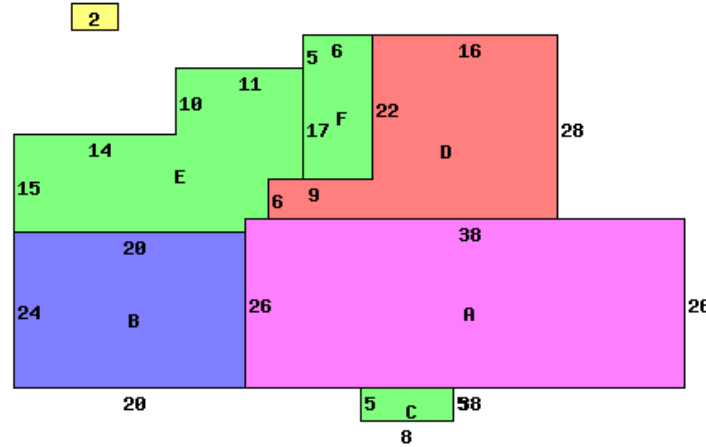

303 GARFIELD AVE 43326

Occupancy	1 Single Family	*DWELLING COMPUTATIONS	
		Sq-Ft	Value
Story Height	1		
Floor Level	Main	FRAME	1490 117280
	Basement		988 18430
	Subtotal		135710
Shingle	Roof	GABLE	
	B 1 2 U A		
Plaster/Drywall	D D	420 sq ft	Basement Finish 4740
Floor/Carpet	X X		Air Conditioning 2620
Floor/Tile-Lino	L		Plumbing 3500
Number of Rooms	3 5		Garages and Carports 11520
Bedrooms	2		Extra Features 6530
			Total Value 164620
Central Heat	A		
F-A/ELECT			
Central A/C	A		
Plumbing			Neighborhood: 3710
Standard	1		Code: 1.1800
Extra 3 Fixture	1		
Extra Fixture	2		

Bldg Type	SHB+Cons	DixHt	Unit	Blt/Renov	Replace	Phy	Fnc	True
1 DWELLING	1 B F	24X28	1910	C-	1988AV	.26		129370
2 Garage	F		672	C	2002AV	.55		8560
		acres/	effective	depth	effective	extended	true	
front lot		frontage	frontage	depth	rate	value	value	
		75.00	140	96	200	14400	14400	

Call Back:

Sign: PSN Date: 2015-02-06 Lister:

36-280098.0000-v082020R