

PLEASANT TWP
KENTON CORP

00350

Hardin County, Ohio
Michael T. Bacon, Auditor

36-250113.0000
H01

RES
2025

sale

Eff Rate:- 50.59 — 44.66 — 47.03 — 46.74 — a/r

2022 ROGERS REX D & SHARON	2016-09-13
2023 ROGERS REX D & SHARON	2016-09-13
2024 ROGERS REX D & SHARON	2016-09-13
2025 ROGERS REX D & SHARON A	2016-09-13 I G WMS PT OL 45
605 GROVE ST	1SD
KENTON OH 43326	\$75,000

Tax Year	2022	2023	2024	2025	CAMA
Prop Cls	510	510	510	510	510
Acres					
Land100%	4490	6460	6460	6460	6460
Bldg100%	70660	81800	81800	81800	81790
Totl100%	75140t	88260t	88260t	88260t	88250t
Cauv100%					
Tax Value:					
Land 35%	1570	2260	2260	2260	2260
Bldg 35%	24730	28630	28630	28630	28630
Totl 35%	26300t	30890t	30890t	30890t	30890t
Hmstd35%					
Owner Oc					
Hmstd RB					
Net Tax	1228.56	1270.10	1343.64	1334.78	
Sp-Asmnt	21.36	21.36	31.98	31.98	

SHB+	CONS	TYPE	FACT	SQ-FT	VALUE	a	*MAIN
1	F/C	M		960		b	GRAGE
	F	G		264	6340	c	PORCH
	STP	P		20	80	d	PORCH
	DK	P		198	2970		

Sale#	#p	sale date	To	Type/Invalid?	Sale\$	co:land	co:bldg
406	1	2016-09-13	ROGERS REX D & SHARON A	1SD	75000	5170	63000
467	1	2009-10-26	LANCE MARCIA M	1WD *	68500	4770	76400
155	1	1996-03-22	LANCE PAMELA F	1WD	48000	4310	37510
1013	1	1992-11-03		1WD *	45800	0	30510

Year	Land	Bldg	Total	Net Tax
2021	1570	24730	26300	1233.04
2020	1570	24730	26300	1070.98

Project
902 MAIN DISTRICT CONSERVANCY XA/2025
500 HARDIN COUNTY LANDFILL XA/2025

2

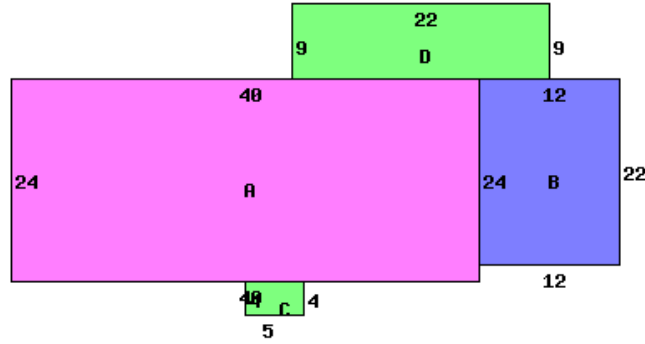

605 GROVE ST 43326

Occupancy 1 Single Family	*DWELLING COMPUTATIONS	
Story Height 1	Sq-Ft	Value
Floor Level	Main	FRAME
	Subtotal	100780
Shingle	Roof	GABLE
	B 1 2 U A	
Plaster/Drywall	D	Heating -1180
Floor/Carpet	X	Garages and Carports 6340
Number of Rooms	5	Extra Features 3050
Bedrooms	3	Total Value 108990
Plumbing Standard	1	PUB SIDEWALK
		Neighborhood:
		Code: 3670
		Dwl/Gar/NC% 1.0900

Bldg Type	SHB+Cons	DixHt	Unit	Blt/Renov	Replace	Phy	Fnc	True
1 DWELLING	1 F/C			Cond	Value	Dpr	Dpr	Value
2 Shed	*PP F	12X10	120	2002AV	92640	.19		81790
					0			0
front lot	100.0000	68.00	94	79	120	95	6460	6460