

PLEASANT TWP  
KENTON CORP

00350

Hardin County, Ohio  
Michael T. Bacon, Auditor

36-250017.0000  
E113

RES  
2025

sale

Eff Rate:- 50.59 — 44.66 — 47.03 — 46.74 — a/r

2022 MCCULLOUGH STEPHANIE	1986-11-07
2023 MCCULLOUGH STEPHANIE	1986-11-07
2024 MCCULLOUGH STEPHANIE	1986-11-07
2025 MCCULLOUGH STEPHANIE L	1986-11-07 IG WMS 64 PT 65
519 W CARROL ST	
KENTON OH 43326	\$43,500

Tax Year	2022	2023	2024	2025	CAMA
Prop Cls	510	510	510	510	510
Acres					
Land100%	9230	13230	13230	13230	13230
Bldg100%	58860	57260	57260	57260	57250
Totl100%	68090t	70490t	70490t	70490t	70480t
Cauv100%					
Tax Value:					
Land 35%	3230	4630	4630	4630	4630
Bldg 35%	20600	20040	20040	20040	20040
Totl 35%	23830t	24670t	24670t	24670t	24670t
Hmstd35%					
Owner Oc	23.12	21.84	21.80	21.74	
Hmstd RB					
Net Tax	1090.06	992.52	1051.28	1044.26	
Sp-Asmnt	24.16	24.16	31.17	31.17	

SHB+	CONS	TYPE	FACT	SQ-FT	VALUE		
1	F/C	M		1404		a	*MAIN
	PAT	P		140	420	b	PORCH
	STP	P		24	100	c	PORCH
	OPF	P		108	3240	d	PORCH
	PAT	P		200	600	e	PORCH

#: 18 & 19, L/W  
362500180000  
362500190000

Sale#	#p	sale date	To	Type/Invalid?	Sale\$	co:land	co:bldg
929	0	1986-11-07		*	43500	0	52510

Year	Land	Bldg	Total	Net Tax
2021	3230	20600	23830	1094.12
2020	3230	20600	23830	947.14

project	ben acres	/	%	factor
902 MAIN DISTRICT CONSERVANCY				
500 HARDIN COUNTY LANDFILL				
	XA/2025			
	XA/2025			

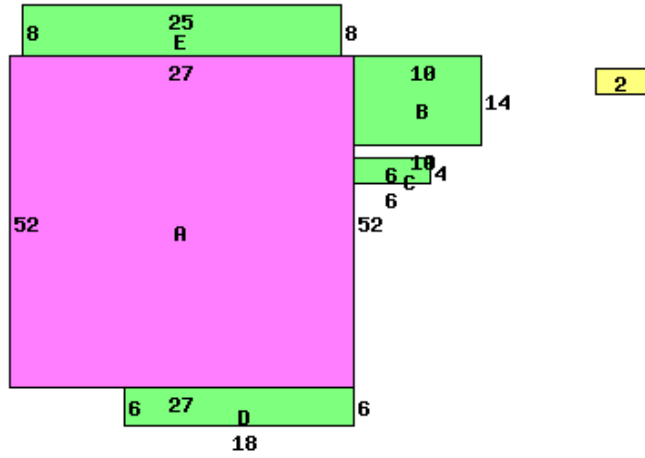

519 W CARROL ST 43326

Occupancy	1 Single Family	*DWELLING COMPUTATIONS
Story Height	1	Sq-Ft Value
Floor Level	Main	FRAME 1404 111000
	Subtotal	111000
Shingle	Roof	GABLE
Plaster/Drywall	D	Air Conditioning 2460
Floor/Hardwood	X	Plumbing 2100
Floor/Carpet	X	Extra Features 4360
Number of Rooms	6	Total Value 119920
Bedrooms	3	
Central Heat	A	PUB SIDEWALK
FORCED AIR		Neighborhood:
Central A/C	A	Code: 3670
Plumbing		Dwl/Gar/NC% 1.0900
Standard	1	
Extra 3 Fixture	1	

Bldg Type	SHB+Cons	DixHt	Unit	Blt/Renov	Replace	Phy	Fnc	True	
1 DWELLING	1 F/C	Area	Rate	Grade	Cond	Value	Dpr	Dpr	Value
2 Garage	CB 0	22X36	792	C	OLD/AV	19010	.65	.65	50000
	acres/	effective	depth	actual	effective	extended	true		
front lot	101.0000	101.00	180	109	120	131	13230	13230	