

PLEASANT TWP  
KENTON CORP

00350

Hardin County, Ohio  
Michael T. Bacon, Auditor

36-230058.0000  
A43

RES  
2025

sale

Eff Rate:- 50.59 — 44.66 — 47.03 — 46.74 — a/r

|                        |                                 |
|------------------------|---------------------------------|
| 2022 JAROS RON & VICKI | 2000-04-17                      |
| 2023 JAROS RON & VICKI | 2000-04-17                      |
| 2024 JAROS RON & VICKI | 2000-04-17                      |
| 2025 JAROS RON & VICKI | 2000-04-17 SHANAFELTS 2ND 14-15 |
| 926 W NORTH ST         | LWD                             |
| KENTON OH 43326        | \$58,500                        |

|            |         |        |        |        |                      |
|------------|---------|--------|--------|--------|----------------------|
| Tax Year   | 2022    | 2023   | 2024   | 2025   | CAMA                 |
| Prop Cls   | 510     | 510    | 510    | 510    | 510                  |
| Acres      |         |        |        |        |                      |
| Land100%   | 6690    | 9600   | 9600   | 9600   | 9610                 |
| Bldg100%   | 55910   | 56140  | 56140  | 56140  | 56150                |
| Totl100%   | 62600t  | 65740t | 65740t | 65740t | 65760t               |
| Cauvl00%   |         |        |        |        |                      |
| Tax Value: |         |        |        |        |                      |
| Land 35%   | 2340    | 3360   | 3360   | 3360   | 3360                 |
| Bldg 35%   | 19570   | 19650  | 19650  | 19650  | 19650                |
| Totl 35%   | 21910t  | 23010t | 23010t | 23010t | 23020t               |
| Hmstd35%   | 19810   | 20640  | 20640  | 20640  |                      |
| Owner Oc   | 19.22   | 18.26  | 18.24  | 18.20  | hmstd 3360 l 17280 b |
| Hmstd RB   |         |        |        |        |                      |
| Net Tax    | 1004.26 | 927.82 | 982.64 | 976.08 |                      |
| Sp-Asmnt   | 269.98  | 22.24  | 29.94  | 29.94  |                      |

| SHB+ | CONS | TYPE | FACT | SQ-FT | VALUE | a | *MAIN |
|------|------|------|------|-------|-------|---|-------|
| 1T   | F/C  | M    |      | 364   |       |   | ADDTN |
| 1    | F/C  | A    |      | 735   |       |   | PORCH |
|      | STP  | P    |      | 70    | 280   |   | PORCH |
|      | CAN  | P    |      | 96    | 770   |   | PORCH |
|      | BAY  | P    |      | 8     | 300   |   | PORCH |
|      | OFFP | P    |      | 83    | 2490  |   | PORCH |
|      | STP  | P    |      | 96    | 380   |   | PORCH |

#: 59, L/W  
362300590000

| Sale# | #p | sale date  | To                       | Type/Invalid? | Sale\$ | co:land | co:blgd |
|-------|----|------------|--------------------------|---------------|--------|---------|---------|
| 205   | 1  | 2000-04-17 | JAROS RON & VICKI        | LWD           | 58500  | 6060    | 37030   |
| 21    | 1  | 1993-01-12 | BAILEY JARVEY L & YVONNE | LWD *         | 45000  | 0       | 33000   |
| 246   | 0  | 1988-04-06 |                          |               | 18000  | 0       | 33000   |

| Year | Land | Bldg  | Total | Net Tax |
|------|------|-------|-------|---------|
| 2021 | 2340 | 19570 | 21910 | 1008.00 |
| 2020 | 2340 | 19570 | 21910 | 872.86  |

Project  
902 MAIN DISTRICT CONSERVANCY XA/2025  
500 HARDIN COUNTY LANDFILL XA/2025

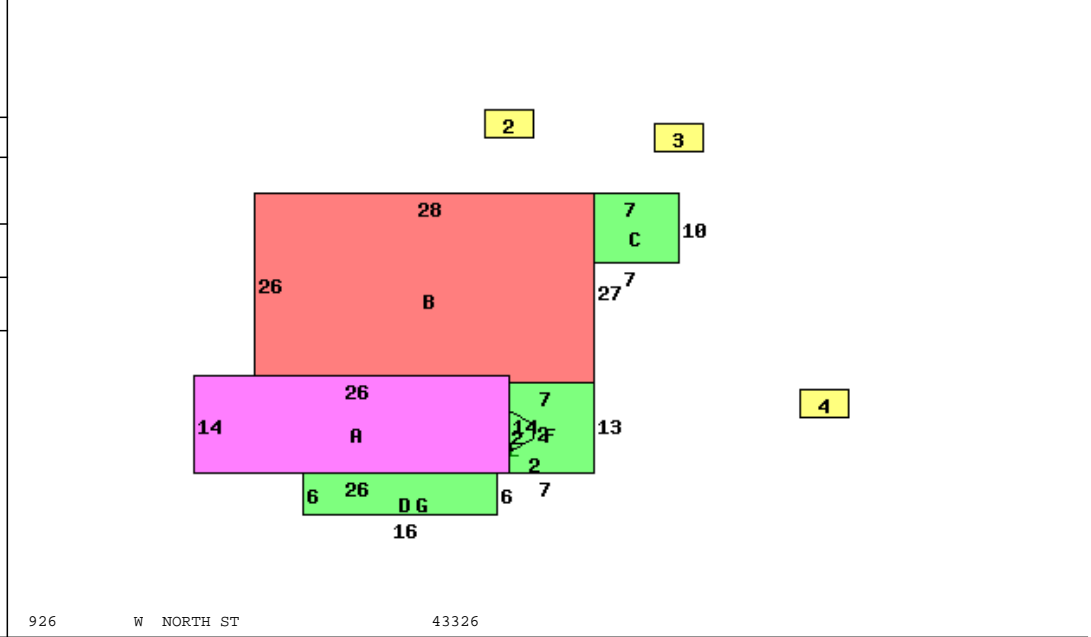

926 W NORTH ST 43326

| Occupancy 1 Single Family |            | *DWELLING COMPUTATIONS |             |
|---------------------------|------------|------------------------|-------------|
| Story Height              | 1T         | Sq-Ft                  | Value       |
| Floor Level               | Main       | FRAME                  | 1099 105720 |
|                           | Part Upper | FRAME                  | 364 24710   |
|                           | Subtotal   |                        | 130430      |
| Metal                     | Roof       | GABLE                  |             |
|                           | B 1 2 U A  |                        |             |
| Plaster/Drywall           | X X        | Extra Features         | 4220        |
| Floor/Pine                | X X        | Total Value            | 134650      |
| Number of Rooms           | 8          |                        |             |
| Bedrooms                  | 4          | PUB SIDEWALK           |             |
| Central Heat              | A          | Neighborhood:          |             |
| FORCED AIR                |            | Code:                  | 3670        |
| Plumbing                  |            | Dwl/Gar/NC%            | 1.0900      |
| Standard                  | 1          |                        |             |

| Bldg Type  | SHB+Cons | DixHt    | Unit      | Blt/Renov | Replace | Phy       | Fnc      | True       |
|------------|----------|----------|-----------|-----------|---------|-----------|----------|------------|
| 1 DWELLING | 1T F/C   |          |           | C-        | OLD/FR  | .65       |          | 46230      |
| 2 Garage   |          | 24X20    | 480       | C         | 1967FR  | .75       |          | 3140       |
| 3 Shed     | *PP F    | 10X12    | 120       |           | OLD/FR  | 0         |          | 0          |
| 4 Garage   |          | 36X24    | 864       | C         | 1967FR  | .70       |          | 6780       |
|            |          | acres/   | effective | depth     | actual  | effective | extended | true       |
| front lot  |          | frontage | frontage  | depth     | rate    | rate      | value    | value      |
|            |          | 100.00   | 132       | 94        | 120     | 113       | 11300    | 9610       |
|            |          |          |           |           |         |           |          | Shape / Si |