

PLEASANT TWP
KENTON CORP

00350

Hardin County, Ohio
Michael T. Bacon, Auditor

36-210033.0000
H114

EXM
2025

sale

Eff Rate:- 57.45 — 53.98 — 56.47 — 56.17 — a/r

2022	HARDIN COUNTY HOUSING	1997-09-11	
2023	HARDIN COUNTY HOUSING	1997-09-11	
2024	HARDIN COUNTY HOUSING	1997-09-11	
2025	HARDIN COUNTY HOUSING D	1997-09-11	BRUNSONS N END 9
	214 N LEIGHTON ST		LWD
	KENTON OH 43326		\$29,500

Tax Year	2022	2023	2024	2025	CAMA
Prop Cls	680	680	680	680	680
Acres					
Land100%	3510	4970	4970	4970	4960
Bldg100%	25310	34490	34490	34490	34480
Totl100%	28830t	39460t	39460t	39460t	39440t
Cauvl00%					
Tax Value:					
Land 35%	1230	1740	1740	1740	1740
Bldg 35%	8860	12070	12070	12070	12070
Totl 35%	10090t	13810t	13810t	13810t	13800t
Hmstd35%					
Owner Oc					
Hmstd RB					
Net Tax					
Sp-Asmnt	2.73	2.73	10.01	10.01	

SHB+	CONS	TYPE	FACT	SQ-FT	VALUE	a	*MAIN
1	F/C	M		1104			
	OFF	P		91	2730	b	PORCH
	PAT	P		77	230	c	PORCH

Sale#	#p	sale date	To	Type/Invalid?	Sale\$	co:land	co:blgd
548	1	1997-09-11	HARDIN COUNTY HOUSING DE	LWD	29500	2910	23860
717	1	1996-11-15	PLOTT MELINDA M	LWD	27000	2910	23860
366	0	1988-05-24		*	0	0	21310
940	0	1987-11-05		*	0	0	21310
881	0	1986-10-21		*	27000	0	21430
117	0	1986-02-20		*	0	0	21430

Year	Land	Bldg	Total	Net Tax
2021	1230	8860	10090	0.00
2020	1230	8860	10090	0.00

Project		ben acres	/ %	factor
902 MAIN DISTRICT CONSERVANCY				
		XA/2025		

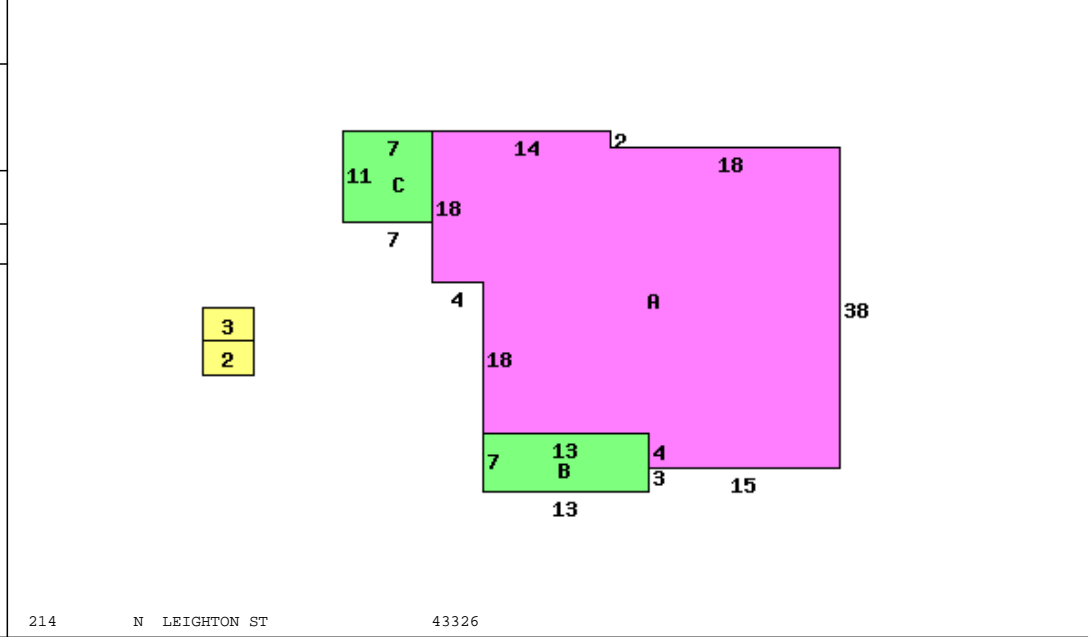

Occupancy 1 Single Family		*DWELLING COMPUTATIONS
Story Height 1		Sq-Ft Value
Floor Level	Main	FRAME 1104 101890
	Subtotal	101890
Shingle	Roof	GABLE
Plaster/Drywall	X	Extra Features 2960
Floor/Hardwood	X	Total Value 104850
Floor/Pine	X	
Number of Rooms	4	PUB SIDEWALK
Bedrooms	2	
Central Heat	A	Neighborhood: 3670
FORCED AIR		Code: 1.0900
Plumbing		Dwl/Gar/NC%
Standard	1	

Bldg Type	SHB+Cons	DixHt	Unit	Blt/Renov	Replace	Phy	Fnc	True
1 DWELLING	1 F/C			C-	OLD/AV	.65	Dpr	33030
2 Shed		12X14	168	D	1989FR	.60		640
3 P	OFF	6X14	84	D	1989FR	.60		810
front lot		acres/ frontage	effective depth	depth actual	effective rate	extended value	true value	
		68.0000	68.00 56	61	120 73	4960	4960	