

PLEASANT TWP
KENTON CORP

00350

Hardin County, Ohio
Michael T. Bacon, Auditor

36-010025.0000
U47

RES
2025

sale

2022 VAN HOOSE DOUGLAS & J
2023 VAN HOOSE DOUGLAS & J
2024 VAN HOOSE DOUGLAS & J
2025 VAN HOOSE DOUGLAS & JOY
228 S MARKET ST
KENTON OH 43326

ORIG PT 33 FT 141

\$0

Eff Rate:- 50.59 — 44.66 — 47.03 — 46.74 — a/r

Tax Year	2022	2023	2024	2025	CAMA
Prop Cls	510	510	510	510	510
Acres					
Land100%	2060	2940	2940	2940	2940
Bldg100%	30830	29770	29770	29770	29760
Totl100%	32890t	32710t	32710t	32710t	32700t
Cauv100%					
Tax Value:					
Land 35%	720	1030	1030	1030	1030
Bldg 35%	10790	10420	10420	10420	10420
Totl 35%	11510t	11450t	11450t	11450t	11450t
Hmstd35%	11510	11450	11450	11450	
Owner Oc	11.16	10.14	10.12	10.10	hmstd 1030 l 10420 b
Hmstd RB	400.22	368.96	417.58	429.66	
Net Tax	126.30	91.68	70.34	55.00	
Sp-Asmnt	20.71	20.71	27.60	27.60	

SHB+ 1T	CONS F/C	TYPE M	FACT P	SQ-FT	VALUE	a	*MAIN
1	OFF	P		126	3780	b	PORCH
1	F/C	A		252		c	ADDTN
1	EFF	P		60	2400	d	PORCH
1	F/C	A		192		e	ADDTN
	DK	P		72	1080	f	PORCH

Year	Land	Bldg	Total	Net Tax
2021	720	10790	11510	126.74
2020	720	10790	11510	109.72

project	ben acres	/	%	factor
902 MAIN DISTRICT CONSERVANCY				
500 HARDIN COUNTY LANDFILL				
	XA/2025			
	XA/2025			

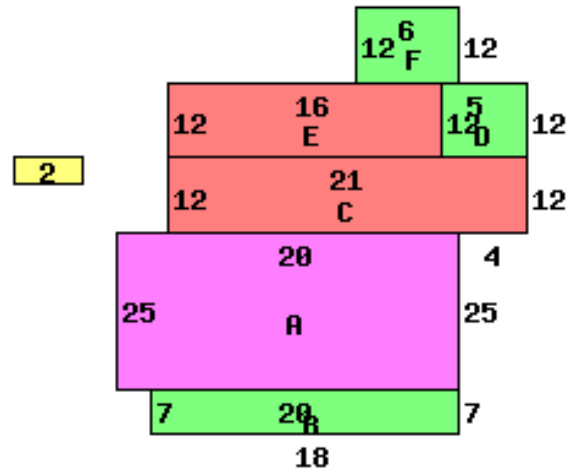

228 S MARKET ST 43326

Occupancy 1 Single Family	*DWELLING COMPUTATIONS	
Story Height 1T	Sq-Ft	Value
Floor Level		
	Main	FRAME
	Part Upper	FRAME
	Subtotal	135520
Shingle	Roof	GABLE
	B 1 2 U A	
Plaster/Drywall	D D	Extra Features
Panelled Wall	X	Total Value
Floor/Pine	X X	
Floor/Carpet	X	PUB ALLEY
Number of Rooms	3 2	
Bedrooms	1 2	Neighborhood:
Central Heat	A	Code:
SPACE GAS		Dwl/Gar/NC%
Plumbing		
Standard	1	

Bldg Type	SHB+Cons	DixHt	Unit	Grade	Blt/Renov	Replace	Phy Dpr	Fnc Dpr	True Value
1 DWELLING	LT F/C	1444		C-	OLD/PR	128500	.75	.15	29760
2 Shed	*NV M 0	8X8	64		1971	0			0
front lot	acres/ frontage	effective frontage	depth	actual factor	effective rate	extended value	true value		
	33.00	83	74	120	89	2940	2940		

Call Back:

Sign: PSN Date: 2015-01-20 Lister:

36-010025.0000-v082020R