

PLEASANT TWP
RIVERDALE SD

00330

Hardin County, Ohio
Michael T. Bacon, Auditor

35-111004.0000
M18

RES
2025

sale

Eff Rate:- 38.72 — 33.69 — 36.07 — 36.23 — a/r

| | |
|----------------------------|-------------------------------|
| 2022 COATS TERRY L & PAMEL | |
| 2023 COATS TERRY L & PAMEL | |
| 2024 COATS TERRY L & PAMEL | |
| 2025 HANEY DENNIS | 2024-11-01 PT NW 1/4 GRANT 11 |
| 16311 ELEVATOR (TR 82) RD | 1WD 2.819A |
| FOREST OH 45843 | \$215,000 |

| | | | | | |
|------------|---------|---------|---------|---------|----------------------|
| Tax Year | 2022 | 2023 | 2024 | 2025 | CAMA |
| Prop Cls | 511 | 511 | 511 | 511 | 511 |
| Acres | 2.8100 | 2.8100 | 2.8100 | 2.8100 | 27100 |
| Land100% | 18030 | 27060 | 27060 | 27110 | 27100 |
| Bldg100% | 103830 | 135630 | 135630 | 135630 | 135630 |
| Totl100% | 121860t | 162690t | 162690t | 162740t | 162730t |
| Cauv100% | | | | | |
| Tax Value: | | | | | |
| Land 35% | 6310 | 9470 | 9470 | 9490 | 9490 |
| Bldg 35% | 36340 | 47470 | 47470 | 47470 | 47470 |
| Totl 35% | 42650t | 56940t | 56940t | 56960t | 56960t |
| Hmstd35% | 40330 | 53380 | 53110 | 53110 | |
| Owner Oc | 34.02 | 40.08 | 40.04 | 39.40 | hmstd 6300 l 46810 b |
| Hmstd RB | | | | | |
| Net Tax | 1473.34 | 1707.40 | 1843.16 | 1855.10 | |
| Sp-Asmnt | 24.00 | 28.00 | 24.00 | 27.00 | |

| SHB+ | CONS | TYPE | FACT | SQ-FT | VALUE | a | *MAIN |
|------|------|------|------|-------|-------|---|-------|
| 2 | B | M | | 1204 | | | |
| 1 | B/C | A | | 180 | | b | ADDTN |
| 1 | F/C | A | | 120 | | c | ADDTN |
| | STP | P | | 80 | 320 | d | PORCH |
| | STP | P | | 60 | 240 | e | PORCH |

| Sale# | #p | sale date | To | Type/Invalid? | Sale\$ | co:land | co:blgd |
|-------|----|------------|--------------|---------------|--------|---------|---------|
| 483 | 1 | 2024-11-01 | HANEY DENNIS | 1WD | 215000 | 27060 | 135630 |

| Year | Land | Bldg | Total | Net Tax |
|------|------|-------|-------|---------|
| 2021 | 6310 | 36340 | 42650 | 1603.60 |
| 2020 | 6310 | 36340 | 42650 | 1607.38 |

| project | ben acres | % | factor |
|------------------------------|-----------|---|---------|
| 131 BLANCHARD RIVER MAINT | | | XA/2025 |
| 235 KELLOGG #983 - BLANCHARD | | | XA/2025 |
| 500 HARDIN COUNTY LANDFILL | | | XA/2025 |
| 921 BLANCHARD RIVER MAINT | | | XA/2023 |
| 306 BLOOM #1043 - BLANCHARD | | | XA/2025 |

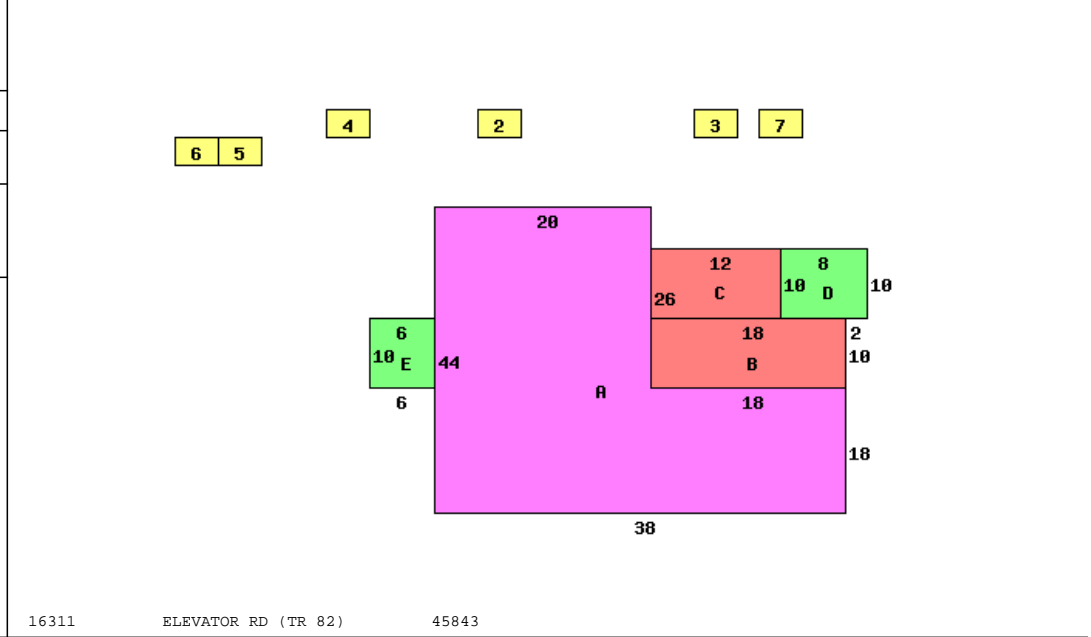

16311 ELEVATOR RD (TR 82) 45843

| Occupancy 1 Single Family | | | | *DWELLING COMPUTATIONS | |
|---------------------------|-------|------------|-------|------------------------|--------|
| Story Height | 2 | | | Sq-Ft | Value |
| Floor Level | | Main | BRICK | 1504 | 128660 |
| | | Full Upper | BRICK | 1204 | 67940 |
| | | Basement | | 903 | 16860 |
| | | Subtotal | | | 213460 |
| Shingle | | Roof | HIP | | |
| | | B 1 2 U A | | | |
| Plaster/Drywall | | X X | | Heating | -3230 |
| Panelled Wall | | X | | Plumbing | 1400 |
| Unfinished Wall | | X | | Extra Features | 560 |
| Floor/Pine | | X X | | Total Value | 212190 |
| Number of Rooms | 1 4 4 | | | | |
| Bedrooms | 1 2 | | | | |
| Plumbing | | | | PUB ELECTRIC | |
| Standard | 1 | | | PRIV WATER | |
| Extra 2 Fixture | 1 | | | PRIV SEWER | |
| | | | | PUB PAVED ST/RD | |
| | | | | Neighborhood: | |
| | | | | Code: | 3300 |
| | | | | Dwl/Gar/NC% | 1.3400 |

| Bldg Type | SHB+Cons | DixHt | Unit | Blt/Renov | Replace | Phy | Fnc | True |
|---------------|----------|-----------|--------|-----------|-----------|----------|-------|--------|
| 1 DWELLING | 2 B B | 2708 | | C | OLD/AV | .55 | | 127950 |
| 2 Garage | | 20X30 | 600 | C | OLD/FR | .70 | | 5790 |
| 3 Shed | *SV 0 | 12X16 | 192 | | 1995AV | | | 200 |
| 4 POND | *.25A | | 0 | | OLD/AV | | | 0 |
| 5 Shed | F | 12X16 | 192 | D | 2006AV | .50 | | 920 |
| 6 P | OFF | 4X16 | 64 | D | 2006AV | .50 | | 770 |
| 7 Shed | *PP | 10X10 | 100 | | OLD/ | | | 0 |
| homesite | 1.0000 | effective | depth | actual | effective | extended | true | |
| small acreage | 1.8190 | frontage | depth | rate | rate | value | value | |
| | | | factor | 18000 | 18000 | 18000 | 18000 | |
| | | | | 5000 | 5000 | 9100 | 9100 | |