

PLEASANT TWP
NORTHERN SD

00340

Hardin County, Ohio
Michael T. Bacon, Auditor

34-050033.0000
J42.02

RES
2025

sale

Eff Rate:- 48.97 — 39.04 — 41.32 — 41.39 — a/r

2022 MOORE SHAWN P & SHAWN	2021-07-09
2023 MOORE SHAWN P & SHAWN	2021-07-09
2024 MOORE SHAWN P & SHAWN	2021-07-09
2025 MOORE SHAWN P & SHAWN A	2021-07-09 N PT NW4 NW4 S5 5.759A
6056 TR 145	ISD
KENTON OH 43326	\$0

Tax Year	2022	2023	2024	2025	CAMA
Prop Cls	511	511	511	511	511
Acres	5.7590	5.7590	5.7590	5.7590	
Land100%	22630	34770	34770	34770	34770
Bldg100%	115570	312800	312800	408140	408130
Totl100%	138200t	347570t	347570t	442910t	442900t
Cauvl00%					

Orig Tax Year 2022
Parent: 34-050017.0000

Tax Value:	7920	12170	12170	12170	12170
Land 35%	40450	109480	109480	142850	142850
Bldg 35%	48370t	121650t	121650t	155020t	155020t
Totl 35%		108120	108120	141480	
Hmstd35%		94.82	94.44	122.14	
Owner Oc					hmstd 6300 l 135180 b
Hmstd RB					
Net Tax	3067.10	4228.08	4507.84	5758.06	
Sp-Asmnt	18.00	22.00	18.00	18.00	

SHB+ 1 B	CONS F	TYPE M	FACT	SQ-FT 2220	VALUE 2270	a *MAIN
	PAT P			758	2270	b PORCH
	OFF P			111	3330	c PORCH
	F G			528	12670	d GRAGE
1	F/C A			1654		e ADDTN

Sale# 300	#p 1	sale date 2021-07-09	To MOORE SHAWN P & SHAWN A	Type/Invalid? LSD *	Sale\$ 0	co:land 0	co:bldg 0
-----------	------	----------------------	----------------------------	---------------------	----------	-----------	-----------

Year 2021	Land 2820	Bldg 0	Total 2820	Net Tax 126.48
-----------	-----------	--------	------------	----------------

Project 921 BLANCHARD RIVER MAINT	XA/2023	ben acres / %	factor
500 HARDIN COUNTY LANDFILL	XA/2025		

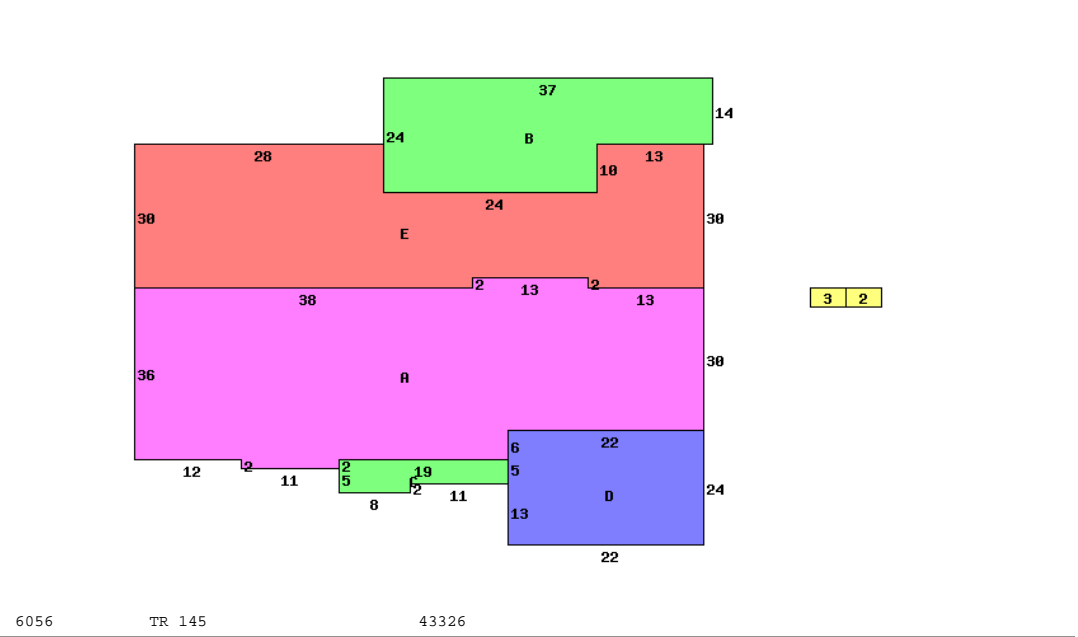

6056 TR 145 43326

Occupancy 1 Single Family	*DWELLING COMPUTATIONS
Story Height 1	Sq-Ft Value
Floor Level	Main FRAME 3874 224650
	Basement 2220 40920
	Subtotal 265570

Bldg Type	SHB+Cons	DixHt	Unit	Grade	Blt/Renov	Replace	Phy	Fnc	True
1 DWELLING	1 B F	3874		C	2021AV	294120	.02		386240
2 Pole Build	OF P	32X32	1024	C	2022AV	15360	.05		14590
3 P		8X32	256	C	2022AV	7680	.05		7300

Shingle	B 1 2 U A		
Plaster/Drywall	D	Air Conditioning	6780
Unfinished Wall	X	Plumbing	3500
Floor/Hardwood	X	Garages and Carports	12670
Floor/Carpet	X	Extra Features	5600
Floor/Tile-Lino	T	Total Value	294120
Number of Rooms	1 6		
Bedrooms	3		
Central Heat	A	Neighborhood:	
FORCED AIR		Code:	3300
Central A/C	A	Dwl/Gar/NC%	1.3400
Plumbing			
Standard	1		
Extra 3 Fixture	1		
Extra 2 Fixture	1		

homesite	1.0000	effective	depth	actual	effective	extended	true
road	.5029	frontage	depth	rate	rate	value	value
small acreage	4.2561		factor	18000	18000	18000	18000
				5000	3940	16770	16770