

PLEASANT TWP  
KENTON SD

00320

Hardin County, Ohio  
Michael T. Bacon, Auditor

33-391015.0000  
L19

RES  
2025

sale

Eff Rate:- 49.60 — 43.46 — 45.84 — 45.76 — a/r

2022 FLEMING WALTER L	
2023 FLEMING WALTER L	
2024 FLEMING WALTER L	
2025 FLEMING WALTER L	PT NE 1/4 FRAC 2 .50A
16361 CR 144	
KENTON OH 43326	\$0

Tax Year	2022	2023	2024	2025	CAMA
Prop Cls	511	511	511	511	511
Acres	.5000	.5000	.5000	.5000	
Land100%	13740	15710	15710	15710	15720
Bldg100%	82940	111140	111140	111140	111140
Totl100%	96690t	126860t	126860t	126860t	126860t
Cauv100%					
Tax Value:					
Land 35%	4810	5500	5500	5500	5500
Bldg 35%	29030	38900	38900	38900	38900
Totl 35%	33840t	44400t	44400t	44400t	44400t
Hmstd35%					
Owner Oc	31.96	38.02	37.98	37.58	
Hmstd RB	392.70	359.26	407.30	421.50	
Net Tax	1126.10	1380.30	1438.04	1422.50	
Sp-Asmnt	21.36	21.36	32.98	32.98	

SHB+	CONS	TYPE	FACT	SQ-FT	VALUE	a	*MAIN
1	F/C	M		1344			
	F2	G		676	16220	b	GRAGE
	EFP	P		180	7200	c	PORCH
	CAN	P		42	340	d	PORCH
	STP	P		42	170	e	PORCH

Year	Land	Bldg	Total	Net Tax
2021	4810	29030	33840	1130.40
2020	4810	29030	33840	975.60

Project  
902 MAIN DISTRICT CONSERVANCY      XA/2025      ben acres / % factor  
500 HARDIN COUNTY LANDFILL      XA/2025

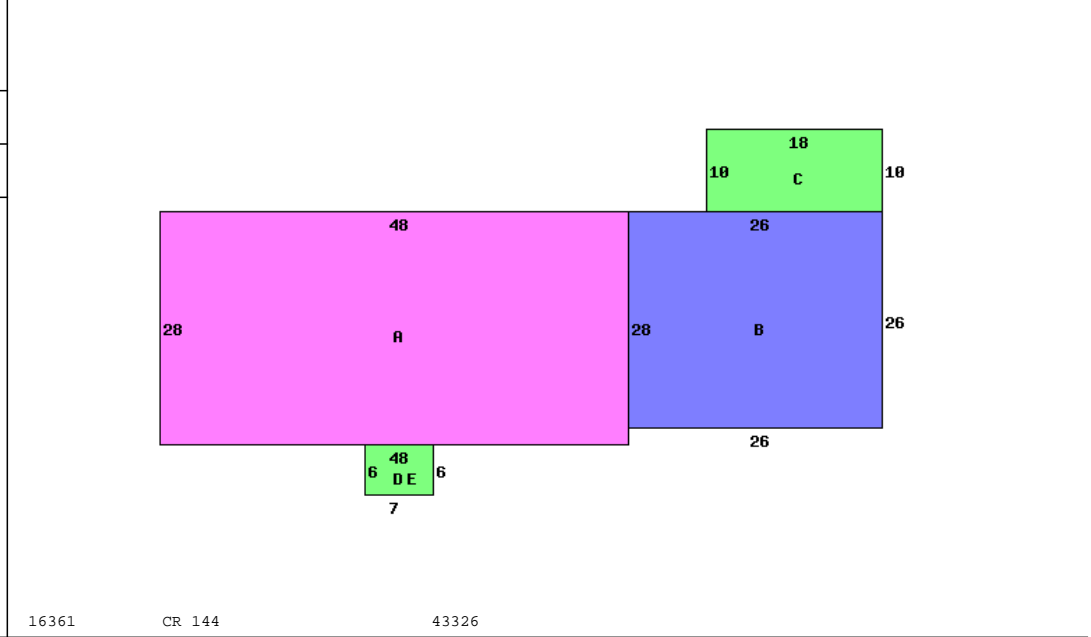

Occupancy 1 Single Family	*DWELLING COMPUTATIONS
Story Height 1	Sq-Ft Value
Floor Level	1344 107720
Shingle	Main Subtotal 107720
	Roof GABLE
Plaster/Drywall	X
Floor/Hardwood	X
Floor/Carpet	X
Number of Rooms	6
Bedrooms	3
Central Heat	A
ELECTRIC	
Plumbing	
Standard	1
	Garages and Carports 16220
	Extra Features 7710
	Total Value 131650
	PUB ELECTRIC
	PUB GAS
	PRIV WATER
	PRIV SEWER
	PUB PAVED ST/RD
	Neighborhood:
	Code: 3300
	Dwl/Gar/NC% 1.3400

Bldg Type	SHB+Cons	DixHt	Unit	Blt/Renov	Replace	Phy Fnc	True
1 DWELLING	1 F/C	FtxFt	Area	Grade	Cond Value	Dpr Dpr	Value
		1344		C	1960GD 131650	.37	111140
front lot	acres/	effective	depth	depth	actual	effective	extended
	frontage	frontage	depth	factor	rate	rate	value
		120.00	180	109	120	131	15720
							15720

Call Back: Sign: PSN Date: 2015-08-17 Lister: 33-391015.0000-v082020R