

PLEASANT TWP  
KENTON SD

00320

Hardin County, Ohio  
Michael T. Bacon, Auditor

33-341057.0000  
N49

RES  
2025

sale

Eff Rate:- 49.60 — 43.46 — 45.84 — 45.76 — a/r

|      |                     |                                  |
|------|---------------------|----------------------------------|
| 2022 | BARNETT DEBORAH     | 2004-10-18                       |
| 2023 | BARNETT DEBORAH     | 2004-10-18                       |
| 2024 | BARNETT DEBORAH     | 2004-10-18                       |
| 2025 | COY CASEY LEE & AMY | 2024-08-07 MYERS PARKVIEW SUB 45 |
|      | 11908 HILLCREST DR  | LWD                              |
|      | KENTON OH 43326     | \$198,500                        |

|            |         |         |         |         |         |
|------------|---------|---------|---------|---------|---------|
| Tax Year   | 2022    | 2023    | 2024    | 2025    | CAMA    |
| Prop Cls   | 510     | 510     | 510     | 510     | 510     |
| Acres      |         |         |         |         |         |
| Land100%   | 18600   | 25310   | 25310   | 25310   | 25300   |
| Bldg100%   | 84970   | 106660  | 106660  | 106660  | 106650  |
| Totl100%   | 103570t | 131970t | 131970t | 131970t | 131950t |
| Cauv100%   |         |         |         |         |         |
| Tax Value: |         |         |         |         |         |
| Land 35%   | 6510    | 8860    | 8860    | 8860    | 8860    |
| Bldg 35%   | 29740   | 37330   | 37330   | 37330   | 37330   |
| Totl 35%   | 36250t  | 46190t  | 46190t  | 46190t  | 46180t  |
| Hmstd35%   |         |         |         |         |         |
| Owner Oc   | 34.22   | 39.56   | 39.52   | 39.10   |         |
| Hmstd RB   | 392.70  | 359.26  | 407.30  |         |         |
| Net Tax    | 1234.28 | 1450.42 | 1512.42 | 1918.34 |         |
| Sp-Asmnt   | 24.60   | 24.60   | 37.06   | 37.06   |         |

|      |      |      |      |       |       |   |       |
|------|------|------|------|-------|-------|---|-------|
| SHB+ | CONS | TYPE | FACT | SQ-FT | VALUE | a | *MAIN |
| 1    | F/C  | M    |      | 1252  |       |   |       |
| 1    | F/C  | A    |      | 120   |       | b | ADDTN |
|      | F2   | G    |      | 548   | 13150 | c | GRAGE |
|      | RFX  | P    |      | 72    | 720   | d | PORCH |
|      | OPF  | P    |      | 120   | 3600  | e | PORCH |
| 1    | F/C  | A    |      | 410   |       | f | ADDTN |

| Sale# | #p | sale date  | To                       | Type/Invalid? | Sale\$ | co:land | co:bldg |
|-------|----|------------|--------------------------|---------------|--------|---------|---------|
| 329   | 1  | 2024-08-07 | COY CASEY LEE & AMY      | LWD           | 198500 | 25310   | 106660  |
| 670   | 1  | 2004-10-18 | BARNETT DEBORAH          | LWD           | 140000 | 14630   | 50910   |
| 556   | 1  | 2000-09-20 | BURGBACHER RICHARD L & M | LWD           | 90000  | 14660   | 44540   |
| 682   | 1  | 1998-11-30 | JENNINGS MATTHEW T & MAR | LSD           | 67500  | 13970   | 38510   |

| Year | Land | Bldg  | Total | Net Tax |
|------|------|-------|-------|---------|
| 2021 | 6510 | 29740 | 36250 | 1238.96 |
| 2020 | 6510 | 29740 | 36250 | 1069.32 |

| p r o j e c t                    |         | ben acres / % factor |  |
|----------------------------------|---------|----------------------|--|
| 902 MAIN DISTRICT CONSERVANCY    | XA/2025 |                      |  |
| 500 HARDIN COUNTY LANDFILL       | XA/2025 |                      |  |
| 254 WARD #1013 SCIOTO RIVER MAIN | XA/2025 |                      |  |

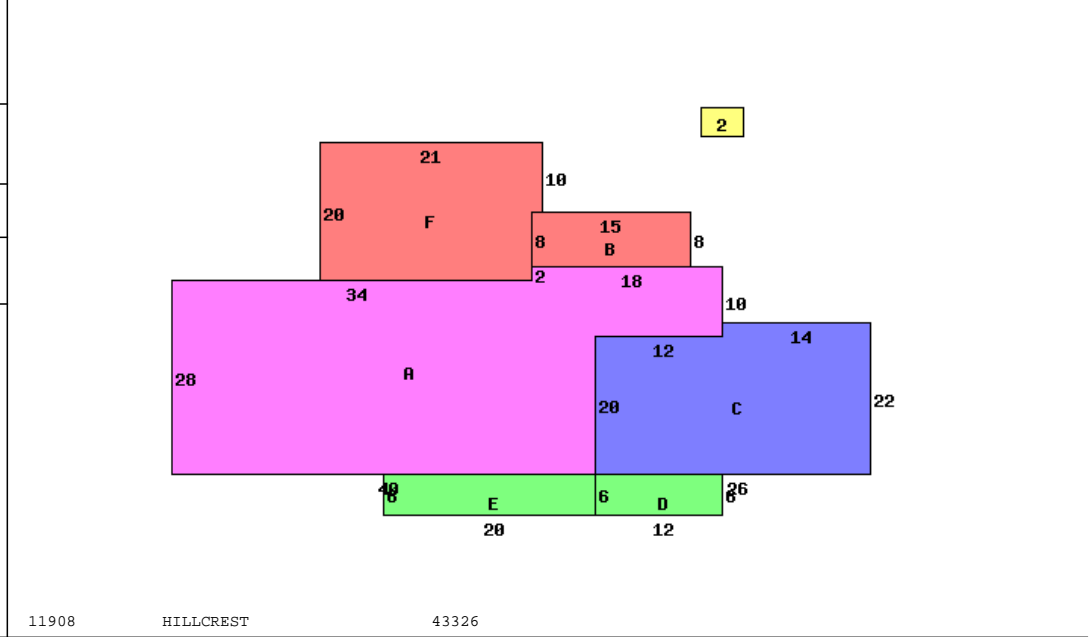

11908 HILLCREST 43326

|                           |                        |                      |        |
|---------------------------|------------------------|----------------------|--------|
| Occupancy 1 Single Family | *DWELLING COMPUTATIONS |                      |        |
| Story Height 1            | Sq-Ft Value            |                      |        |
| Floor Level               | 1782 130070            |                      |        |
| Shingle                   | 130070                 |                      |        |
| Plaster/Drywall           | D                      | Air Conditioning     | 3100   |
| Floor/Hardwood            | X                      | Garages and Carports | 13150  |
| Floor/Carpet              | X                      | Extra Features       | 4320   |
| Floor/Tile-Lino           | L                      | Total Value          | 150640 |
| Number of Rooms           | 5                      |                      |        |
| Bedrooms                  | 2                      | PUB ELECTRIC         |        |
| Central Heat              | A                      | PUB GAS              |        |
| ELECTRIC                  |                        | PRIV WATER           |        |
| Central A/C               | A                      | PRIV SEWER           |        |
| Plumbing                  |                        | PUB PAVED ST/RD      |        |
| Standard                  | 1                      | Neighborhood:        |        |
|                           |                        | Code:                | 3320   |
|                           |                        | Dwl/Gar/NC%          | 1.1800 |

| Bldg Type  | SHB+Cons        | DixHt              | Unit  | Blt/Renov    | Replace        | Phy            | Fnc        | True   |
|------------|-----------------|--------------------|-------|--------------|----------------|----------------|------------|--------|
| 1 DWELLING | 1 F/C           | 1782               |       | Cond         | Value          | Dpr            | Dpr        | Value  |
| 2 Shed     | *PP             | 10X14              | 80    | OLD/         | 150640         | .40            |            | 106650 |
|            |                 |                    |       |              | 0              |                |            | 0      |
| front lot  | acres/ frontage | effective frontage | depth | actual depth | effective rate | extended value | true value |        |
|            | 110.0000        | 110.00             | 220   | 115          | 200            | 230            | 25300      | 25300  |