

PLEASANT TWP
KENTON SD

00320

Hardin County, Ohio
Michael T. Bacon, Auditor

33-280077.0000
D97

RES
2025

sale

2022 JEFFRIES SARAH D & SC	2003-03-07	
2023 JEFFRIES SARAH D & SC	2003-03-07	
2024 JEFFRIES SARAH D & SC	2003-03-07	
2025 JEFFRIES SARAH D & SCOT	2003-03-07 PT NE1/4 SW1/4 28 1.00A	
14410 TR 114	1WD	
KENTON OH 43326	\$56,000	

Eff Rate:-	49.60	43.46	45.84	45.76	a/r	
Tax Year	2022	2023	2024	2025	2025	CAMA
Prop Cls	511	511	511	511	511	511
Acres	1.0000	1.0000	1.0000	1.0000	1.0000	
Land100%	12600	18000	18000	18000	18000	18000
Bldg100%	159830	201260	201260	201260	201260	201270
Totl100%	172430t	219260t	219260t	219260t	219260t	219270t
Cauvl00%						
Tax Value:						
Land 35%	4410	6300	6300	6300	6300	6300
Bldg 35%	55940	70440	70440	70440	70440	70440
Totl 35%	60350t	76740t	76740t	76740t	76740t	76740t
Hmstd35%						
Owner Oc	56.98	65.72	65.66	64.96	64.96	
Hmstd RB						
Net Tax	2708.62	3006.62	3189.42	3187.10	3187.10	
Sp-Asmnt	21.00	25.00	21.00	24.00		

SHB+	CONS	TYPE	FACT	SQ-FT	VALUE		
1 B	F	M		1767		a	*MAIN
	F2	G		600	14400	b	GRAGE
	RFX	P		144	1440	c	PORCH
	PAT	P		420	1260	d	PORCH
	STP	P		144	580	e	PORCH

Sale#	#p	sale date	To	Type/Invalid?	Sale\$	co:land	co:bldg
110	1	2003-03-07	JEFFRIES SARAH D & SCOTT	1WD	56000	8000	86600

Year	Land	Bldg	Total	Net Tax
2021	4410	55940	60350	2718.86
2020	4410	55940	60350	2346.64

project	ben acres	/	%	factor
131 BLANCHARD RIVER MAINT				XA/2025
500 HARDIN COUNTY LANDFILL				XA/2025
921 BLANCHARD RIVER MAINT				XA/2023
235 KELLOGG #983 - BLANCHARD				XA/2025

2

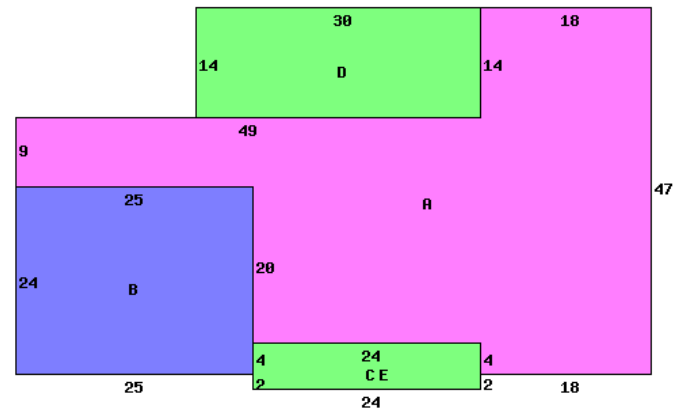

14410 TR 114 43326

Occupancy 1 Single Family	*DWELLING COMPUTATIONS	
Story Height 1	Sq-Ft	Value
Floor Level		
Main	FRAME	1767 128970
Basement		1325 24530
Subtotal		153500
Shingle	Roof	GABLE
B 1 2 U A		
Plaster/Drywall	X	Fireplaces 4000
Unfinished Wall	X	Air Conditioning 3080
Floor/Carpet	X	Plumbing 1400
Floor/Concrete	X	Garages and Carports 14400
Floor/Tile-Lino	L	Extra Features 3280
Number of Rooms	1 5	Total Value 179660
Bedrooms	3	
Fireplace		PUB ELECTRIC
Openings	2	PRIV WATER
Stacks	1	PRIV SEWER
Central Heat	A	PUB PAVED ST/RD
FORCED AIR		
Central A/C	A	Neighborhood:
Plumbing		Code: 3300
Standard	1	Dwl/Gar/NC% 1.3400
Extra 2 Fixture	1	

Bldg Type	SHB+Cons	DixHt	Unit	Blt/Renov	Replace	Phy	Fnc	True
1 DWELLING	1 B F	FtxFt	Area	Grade	Cond	Value	Dpr	Value
2 Shed	*PP	8X10	1767	C+	1976VG	197630	.24	201270
			80		OLD/	0		0
homesite	acres/	effective	depth	actual	effective	extended	true	
	frontage	frontage	depth	rate	rate	value	value	
	1.0000			18000	18000	18000	18000	

Call Back:

Sign: PSN Date: 2015-11-20 Lister:

33-280077.0000-v082020R