

PLEASANT TWP  
KENTON SD

00320

Hardin County, Ohio  
Michael T. Bacon, Auditor

33-280077.0000  
D97

RES  
2023

sale

Eff Rate:- 43.64 — 49.77 — 49.60 — 43.46 — a/r

|                              |                                    |
|------------------------------|------------------------------------|
| 2020 JEFFRIES SARAH D & SC   | 2003-03-07                         |
| 2021 JEFFRIES SARAH D & SC   | 2003-03-07                         |
| 2022 JEFFRIES SARAH D & SC   | 2003-03-07                         |
| 2023 JEFFRIES SARAH D & SCOT | 2003-03-07 PT NE1/4 SW1/4 28 1.00A |
| 14410 TR 114                 | 1WD                                |
| \$56,000                     |                                    |
| KENTON OH 43326              | 07.0-05-28-077                     |

|            |         |         |         |         |         |
|------------|---------|---------|---------|---------|---------|
| Tax Year   | 2020    | 2021    | 2022    | 2023    | CAMA    |
| Prop Cls   | 511     | 511     | 511     | 511     | 511     |
| Acres      | 1.0000  | 1.0000  | 1.0000  | 1.0000  |         |
| Land100%   | 12600   | 12600   | 12600   | 18000   | 18000   |
| Bldg100%   | 159830  | 159830  | 159830  | 201260  | 201270  |
| Totl100%   | 172430t | 172430t | 172430t | 219260t | 219270t |
| Cauv100%   |         |         |         |         |         |
| Tax Value: |         |         |         |         |         |
| Land 35%   | 4410    | 4410    | 4410    | 6300    | 6300    |
| Bldg 35%   | 55940   | 55940   | 55940   | 70440   | 70440   |
| Totl 35%   | 60350t  | 60350t  | 60350t  | 76740t  | 76740t  |
| Hmstd35%   |         |         |         |         |         |
| Owner Oc   | 57.42   | 56.98   | 56.98   | 65.72   |         |
| Hmstd RB   |         |         |         |         |         |
| Net Tax    | 2346.64 | 2718.86 | 2708.62 | 3006.62 |         |
| Sp-Asmnt   | 21.00   | 21.00   | 21.00   | 25.00   |         |

|      |      |      |      |       |       |   |       |  |
|------|------|------|------|-------|-------|---|-------|--|
| SHB+ | CONS | TYPE | FACT | SQ-FT | VALUE |   |       |  |
| 1 B  | F    | M    |      | 1767  |       | a | *MAIN |  |
|      | F2   | G    |      | 600   | 14400 | b | GRAGE |  |
|      | RFX  | P    |      | 144   | 1440  | c | PORCH |  |
|      | PAT  | P    |      | 420   | 1260  | d | PORCH |  |
|      | STP  | P    |      | 144   | 580   | e | PORCH |  |

|       |    |            |                          |               |        |         |         |
|-------|----|------------|--------------------------|---------------|--------|---------|---------|
| Sale# | #p | sale date  | To                       | Type/Invalid? | Sale\$ | co:land | co:bldg |
| 110   | 1  | 2003-03-07 | JEFFRIES SARAH D & SCOTT | 1WD           | 56000  | 8000    | 86600   |

|      |      |       |       |         |
|------|------|-------|-------|---------|
| Year | Land | Bldg  | Total | Net Tax |
| 2019 | 4200 | 44830 | 49030 | 1829.30 |
| 2018 | 4200 | 44830 | 49030 | 1831.28 |

|                            |           |   |   |         |
|----------------------------|-----------|---|---|---------|
| project                    | ben acres | / | % | factor  |
| 131 BLANCHARD RIVER MAINT  |           |   |   | XA/2023 |
| 500 HARDIN COUNTY LANDFILL |           |   |   | XA/2023 |
| 921 BLANCHARD RIVER MAINT  |           |   |   | XA/2023 |

2

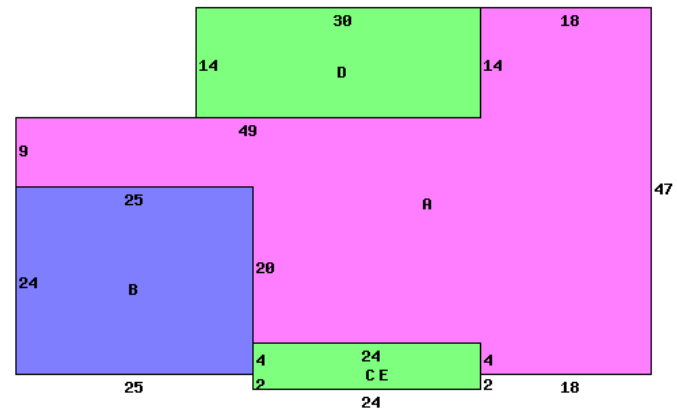

14410 TR 114 43326

|                           |                        |                            |
|---------------------------|------------------------|----------------------------|
| Occupancy 1 Single Family | *DWELLING COMPUTATIONS |                            |
| Story Height 1            | Sq-Ft                  | Value                      |
| Floor Level               |                        |                            |
| Main                      | FRAME                  | 1767 128970                |
| Basement                  |                        | 1325 24530                 |
| Subtotal                  |                        | 153500                     |
| Shingle                   | Roof                   | GABLE                      |
| B 1 2 U A                 |                        |                            |
| Plaster/Drywall           | X                      | Fireplaces 4000            |
| Unfinished Wall           | X                      | Air Conditioning 3080      |
| Floor/Carpet              | X                      | Plumbing 1400              |
| Floor/Concrete            | X                      | Garages and Carports 14400 |
| Floor/Tile-Lino           | L                      | Extra Features 3280        |
| Number of Rooms           | 1 5                    | Total Value 179660         |
| Bedrooms                  | 3                      |                            |
| Fireplace                 |                        | PUB ELECTRIC               |
| Openings                  | 2                      | PRIV WATER                 |
| Stacks                    | 1                      | PRIV SEWER                 |
| Central Heat              | A                      | PUB PAVED ST/RD            |
| FORCED AIR                |                        |                            |
| Central A/C               | A                      | Neighborhood:              |
| Plumbing                  |                        | Code: 3300                 |
| Standard                  | 1                      | Dwl/Gar/NC% 1.3400         |
| Extra 2 Fixture           | 1                      |                            |

|            |          |           |       |           |           |          |       |        |
|------------|----------|-----------|-------|-----------|-----------|----------|-------|--------|
| Bldg Type  | SHB+Cons | DixHt     | Unit  | Blt/Renov | Replace   | Phy      | Fnc   | True   |
| 1 DWELLING | 1 B F    | 1767      |       | Grade     | Cond      | Value    | Dpr   | Dpr    |
| 2 Shed     | *PP      | 8X10      | 80    | C+        | 1976VG    | 197630   | .24   | 201270 |
|            |          |           |       | OLD/      |           | 0        |       | 0      |
| homesite   | acres/   | effective | depth | actual    | effective | extended | true  |        |
|            | frontage | frontage  | depth | rate      | rate      | value    | value |        |
|            | 1.0000   |           |       | 18000     | 18000     | 18000    | 18000 |        |

Call Back:

Sign: PSN Date: 2015-11-20 Lister:

33-280077.0000-v082020R