

PLEASANT TWP
KENTON SD

00320

Hardin County, Ohio
Michael T. Bacon, Auditor

33-140023.0000
F35

RES
2025

sale

Eff Rate:- 49.60 — 43.46 — 45.84 — 45.76 — a/r

| | |
|-----------------------------------------|--------------------------------|
| 2022 CANNODE TODD MICHAEL | 2006-10-04 |
| 2023 CANNODE TODD MICHAEL | 2006-10-04 |
| 2024 CANNODE TODD MICHAEL | 2023-11-21 |
| 2025 CANNODE TODD MICHAEL & 8216 CR 175 | 2023-11-21 PT N2 NW4 S14 5.00A |
| | 1QC SEE PCL 33-140023.01 FOR |
| | \$0 REST OF SPECIAL ASSESS |

| | | | | | |
|----------|---------|---------|---------|---------|---------|
| Tax Year | 2022 | 2023 | 2024 | 2025 | CAMA |
| Prop Cls | 511 | 511 | 511 | 511 | 511 |
| Acres | 5.0000 | 5.0000 | 5.0000 | 5.0000 | |
| Land100% | 22200 | 34000 | 34000 | 34000 | 34000 |
| Bldg100% | 191940 | 217140 | 217140 | 217140 | 217150 |
| Totl100% | 214140t | 251140t | 251140t | 251140t | 251150t |
| Cauvl00% | | | | | |

Orig Tax Year 2007
Parent: 33-140002.0000

| | | | | | |
|------------|---------|---------|---------|---------|----------------------|
| Tax Value: | | | | | |
| Land 35% | 7770 | 11900 | 11900 | 11900 | 11900 |
| Bldg 35% | 67180 | 76000 | 76000 | 76000 | 76000 |
| Totl 35% | 74950t | 87900t | 87900t | 87900t | 87900t |
| Hmstd35% | | 82300 | 82300 | 82300 | |
| Owner Oc | | | 70.42 | 69.68 | |
| Hmstd RB | | | | | hmstd 6300 l 76000 b |
| Net Tax | 3434.66 | 3519.12 | 3658.04 | 3655.32 | |
| Sp-Asmnt | 28.88 | 33.45 | 29.45 | 35.45 | |

| SHB+ | CONS | TYPE | FACT | SQ-FT | VALUE | | |
|------|------|------|------|-------|-------|---|-------|
| 1 B | F | M | | 1683 | | a | *MAIN |
| | F | G | | 648 | 15550 | b | GRAGE |
| | STP | P | | 46 | 180 | c | PORCH |
| | CAN | P | | 54 | 430 | d | PORCH |
| | DK | P | | 240 | 3600 | e | PORCH |

| Sale# | #p | sale date | To | Type/Invalid? | Sale\$ | co:land | co:bldg |
|-------|----|------------|------------------------|---------------|--------|---------|---------|
| 518 | 1 | 2023-11-21 | CANNODE TODD MICHAEL & | 1QC * | 0 | 34000 | 217140 |
| 615 | 1 | 2006-10-04 | CANNODE TODD MICHAEL | 1WD | 5000 | 0 | 0 |

| Year | Land | Bldg | Total | Net Tax |
|------|------|-------|-------|---------|
| 2021 | 7770 | 67180 | 74950 | 3447.42 |
| 2020 | 7770 | 67180 | 74950 | 2985.64 |

| Project | ben acres | % | factor |
|----------------------------------|-----------|---|---------|
| 131 BLANCHARD RIVER MAINT | | | XA/2025 |
| 235 KELLOGG #983 - BLANCHARD | | | XA/2025 |
| 253 BAUGHMAN #1012 BLANCHARD RIV | | | XA/2025 |
| 921 BLANCHARD RIVER MAINT | | | XA/2023 |
| 500 HARDIN COUNTY LANDFILL | | | XA/2025 |
| 306 BLOOM #1043 - BLANCHARD | | | XA/2025 |
| 332 LONG #1097 - BLANCHARD RIVER | | | XA/2025 |

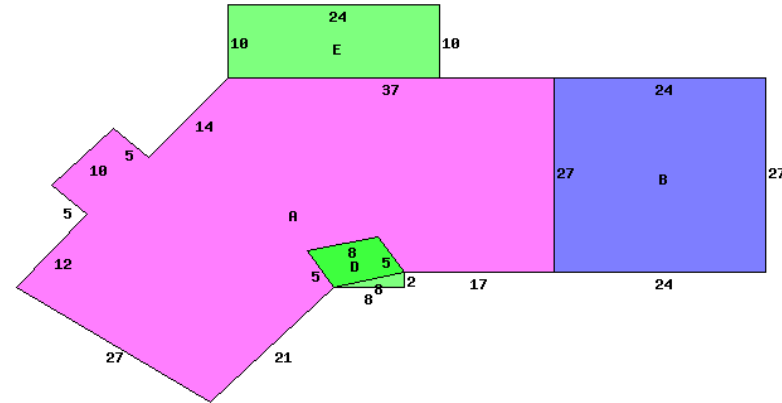

8216 CR 175 43326

| | | | |
|---------------------------|------------------------|----------------------|-------------|
| Occupancy 1 Single Family | *DWELLING COMPUTATIONS | Sq-Ft | Value |
| Story Height 1 | | | |
| Floor Level | Main | FRAME | 1683 126070 |
| | Basement | | 1683 31140 |
| | Subtotal | | 157210 |
| Shingle | Roof | GABLE | |
| | B 1 2 U A | | |
| Plaster/Drywall | D | Air Conditioning | 3010 |
| Unfinished Wall | X | Plumbing | 2100 |
| Floor/Hardwood | X | Garages and Carports | 15550 |
| Floor/Carpet | X | Extra Features | 4210 |
| Floor/Concrete | X | Total Value | 182080 |
| Floor/Tile-Lino | T | | |
| Number of Rooms | 1 5 | PUB ELECTRIC | |
| Bedrooms | 2 | PRIV WATER | |
| | | PRIV SEWER | |
| Central Heat | A | PUB PAVED ST/RD | |
| Heat Pump | A | Neighborhood: | |
| Central A/C | A | Code: | 3300 |
| Plumbing | | Dwl/Gar/NC% | 1.3400 |
| Standard | 1 | | |
| Extra 3 Fixture | 1 | | |

| Bldg Type | SHB+Cons | DixHt | Area | Unit | Grade | Blt/Renov | Replace | Phy | Fnc | True |
|---------------|----------|-----------|-------|--------|--------|-----------|----------|-------|-----|-------|
| 1 DWELLING | 1 B F | FtxFt | 1683 | Rate | C | 2010GD | 182080 | .11 | Dpr | Value |
| | acres/ | effective | depth | depth | actual | effective | extended | true | | |
| homesite | 1.0000 | frontage | depth | factor | rate | rate | value | value | | |
| small acreage | 4.0000 | | | | 18000 | 4000 | 18000 | 18000 | | 16000 |

Call Back:

Sign: PSN Date: 2015-11-23 Lister:

33-140023.0000-v082020R