

PLEASANT TWP
KENTON SD

00320

Hardin County, Ohio
Michael T. Bacon, Auditor

33-140021.0000
F39

RES
2023

sale

Eff Rate:- 43.64 — 49.77 — 49.60 — 43.46 — a/r

| | |
|---------------------------|--------------------------------------|
| 2020 CIRCLE R CORPORATION | 2004-01-20 |
| 2021 CIRCLE R CORPORATION | 2004-01-20 |
| 2022 CIRCLE R CORPORATION | 2004-01-20 |
| 2023 CIRCLE R CORPORATION | 2004-01-20 |
| 8844 CR 175 | 2004-01-20 PT SW1/4 SW1/4 S14 3.012A |
| | 6WD SEE PCL 33-140021.01 FOR |
| | \$0 REST OF SPECIAL ASSESS |
| | 07.0-05-14-021 |
| KENTON OH 43326 | |

| | | | | | |
|------------|---------|---------|---------|---------|---------|
| Tax Year | 2020 | 2021 | 2022 | 2023 | CAMA |
| Prop Cls | 511 | 511 | 511 | 511 | 511 |
| Acres | 3.0100 | 3.0100 | 3.0100 | 3.0100 | |
| Land100% | 18630 | 18630 | 18630 | 18630 | 28050 |
| Bldg100% | 182940 | 182940 | 182940 | 236490 | 236480 |
| Totl100% | 201570t | 201570t | 201570t | 264540t | 264530t |
| Cauvl00% | | | | | |
| Tax Value: | | | | | |
| Land 35% | 6520 | 6520 | 6520 | 9820 | 9820 |
| Bldg 35% | 64030 | 64030 | 64030 | 82770 | 82770 |
| Totl 35% | 70550t | 70550t | 70550t | 92590t | 92590t |
| Hmstd35% | | | | | |
| Owner Oc | | | | | |
| Hmstd RB | | | | | |
| Net Tax | 2810.38 | 3245.02 | 3233.04 | 3706.90 | |
| Sp-Asmnt | 27.00 | 27.00 | 27.00 | 31.00 | |

| SHB+ | CONS | TYPE | FACT | SQ-FT | VALUE | a | *MAIN |
|------|------|------|------|-------|-------|---|-------|
| 1 | F/C | M | | 1620 | | | GRAGE |
| | F2 | G | | 576 | 13820 | b | GRAGE |
| | OFFP | P | | 224 | 6720 | c | PORCH |
| | OFFP | P | | 192 | 5760 | d | PORCH |
| | F | G | | 408 | 9790 | e | GRAGE |
| | PAT | P | | 99 | 300 | f | PORCH |
| | OFFP | P | | 154 | 4620 | g | PORCH |
| | F | G | | 960 | 23040 | h | GRAGE |
| | EFP | P | | 160 | 6400 | i | PORCH |
| | DK | P | | 252 | 3780 | j | PORCH |

| gas fireplace | | | | | | | |
|---------------|------|------------|------------------------|---------------|--------|---------|---------|
| Sale# | #p | sale date | To | Type/Invalid? | Sale\$ | co:land | co:blgd |
| 19 | 6 | 2004-01-20 | CIRCLE R CORPORATION | 6WD * | 0 | 14030 | 101400 |
| 1197 | 1 | 1993-12-03 | RAREY FRED F & KAREN L | 1WD * | 3000 | 0 | 0 |
| Year | Land | Bldg | Total | Net Tax | | | |
| 2019 | 6310 | 51520 | 57830 | 2215.06 | | | |
| 2018 | 6310 | 51520 | 57830 | 2217.40 | | | |

| p r o j e c t | | ben acres | / | % | factor |
|---------------|------------------------------|-----------|---|---|---------|
| 131 | BLANCHARD RIVER MAINT | | | | XA/2023 |
| 306 | BLOOM #1043 - BLANCHARD | | | | XA/2023 |
| 332 | LONG #1097 - BLANCHARD RIVER | | | | XA/2023 |
| 500 | HARDIN COUNTY LANDFILL | | | | XA/2023 |
| 921 | BLANCHARD RIVER MAINT | | | | XA/2023 |

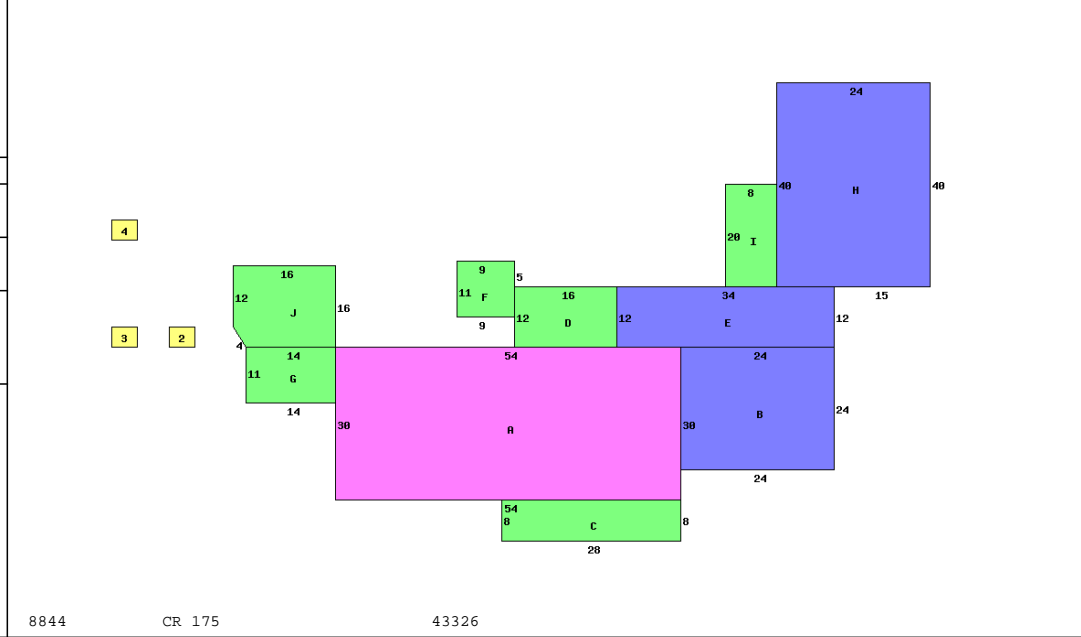

8844 CR 175 43326

| Occupancy 1 Single Family | | | | *DWELLING COMPUTATIONS | |
|---------------------------|---|----------------------|--------|------------------------|-----------|
| Story Height | 1 | Sq-Ft | Value | Bldg Type | SHB+Cons |
| Floor Level | | 1620 | 124290 | 1 DWELLING | 1 F/C |
| Metal | | | 124290 | 2 Pool | *PP |
| | | | | 3 Shed | *PP |
| | | | | 4 Shed | |
| Plaster/Drywall | D | Air Conditioning | 2880 | acres/ | effective |
| Floor/Carpet | X | Plumbing | 2100 | frontage | frontage |
| Floor/Tile-Lino | T | Garages and Carports | 46650 | depth | depth |
| Number of Rooms | 4 | Extra Features | 28700 | factor | factor |
| Bedrooms | 3 | Total Value | 204620 | actual | effective |
| Central Heat | A | PUB ELECTRIC | | rate | rate |
| FORCED AIR | | PRIV WATER | | 18000 | 18000 |
| Central A/C | A | PRIV SEWER | | 5000 | 5000 |
| Plumbing | | PUB PAVED ST/RD | | 10050 | 10050 |
| Standard | 1 | Neighborhood: | | | |
| Extra 3 Fixture | 1 | Code: | 3300 | | |
| | | Dwl/Gar/NC% | 1.3400 | | |

| | | | | | | | | | |
|---|----------|-----|-------|------|----|--------|--------|-----|--------|
| 1 | DWELLING | 1 | F/C | 1620 | C+ | 1993GD | 225080 | .22 | 235250 |
| 2 | Pool | *PP | | 0 | | OLD/ | 0 | | 0 |
| 3 | Shed | *PP | 8X8 | 64 | | OLD/ | 0 | | 0 |
| 4 | Shed | | 10X16 | 160 | D | 2017AV | 1540 | .20 | 1230 |

Call Back: Sign: PSN Date: 2015-11-23 Lister: 33-140021.0000-v082020R