

MCDONALD TWP
UPPER SCIOTO SD

00300

Hardin County, Ohio
Michael T. Bacon, Auditor

31-210022.0000
I49

RES
2025

sale

Eff Rate:- 44.45 — 40.66 — 39.34 — 39.29 — a/r

| | | | |
|--------------------------------|------------|--------------|--|
| 2022 BOECHER RICHARD L & J | 2020-05-05 | | |
| 2023 BOECHER RICHARD L & J | 2020-05-05 | | |
| 2024 BOECHER RICHARD L & J | 2020-05-05 | | |
| 2025 BOECHER RICHARD L & JULIE | 2020-05-05 | 10056 1.801A | |
| 5776 CR 150 | 2SD | | |
| | \$0 | | |
| KENTON OH 43326 | | | |

| | | | | | |
|------------|---------|---------|---------|---------|-----------------------|
| Tax Year | 2022 | 2023 | 2024 | 2025 | |
| Prop Cls | 511 | 511 | 511 | 511 | CAMA |
| Acres | 1.8000 | 1.8000 | 1.8000 | 1.8000 | 511 |
| Land100% | 15000 | 22000 | 22000 | 22000 | 22000 |
| Bldg100% | 251710 | 316000 | 316000 | 316000 | 315990 |
| Totl100% | 266710t | 338000t | 338000t | 338000t | 337990t |
| Cauvl00% | | | | | |
| Tax Value: | | | | | |
| Land 35% | 5250 | 7700 | 7700 | 7700 | 7700 |
| Bldg 35% | 88100 | 110600 | 110600 | 110600 | 110600 |
| Totl 35% | 93350t | 118300t | 118300t | 118300t | 118300t |
| Hmstd35% | 92510 | 116900 | 116900 | 116680 | |
| Owner Oc | 96.84 | 101.84 | 96.76 | 96.60 | hmstd 6300 l 110380 b |
| Hmstd RB | | | | | |
| Net Tax | 3661.38 | 4296.24 | 4165.42 | 4159.72 | |
| Sp-Asmnt | 35.00 | 35.00 | 95.08 | 95.08 | |

| | | | | | | | |
|----------------------------------|------------------------|-------------------------|---------------------------------|----------------------------|-----------------------|------------------|-------------------------|
| SHB+ 1 B | CONS B E2 STP | TYPE M G F | FACT | SQ-FT 3039 676 44 | VALUE 18930 180 | a b c | *MAIN GRAGE PORCH |
| Sale# 194 | #p 2 | sale date 2020-05-05 | To BOECHER RICHARD L & JULIE | Type/Invalid? 2SD * | Sale\$ 0 | co:land 14400 | co:bldg 225570 |
| Year | Land | Bldg | Total | Net Tax | | | |
| 2021 | 5250 | 88100 | 93350 | 3972.02 | | | |
| 2020 | 5250 | 88100 | 93350 | 3922.80 | | | |
| p r o j e c t | | | | ben acres | / | % | factor |
| 902 MAIN DISTRICT CONSERVANCY | | | | | | | XA/2025 |
| 135 BADER #888 SCIOTO RIVER MCDO | | | | | | | XA/2025 |
| 500 HARDIN COUNTY LANDFILL | | | | | | | XA/2025 |

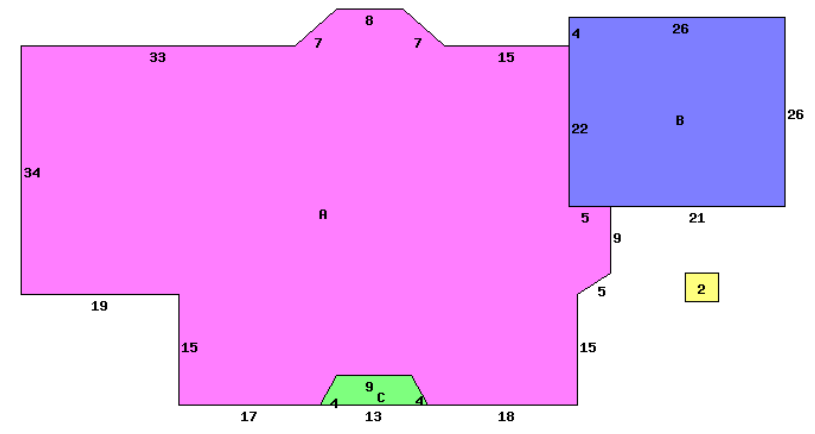

5776 CR 150 43326

| | | |
|---------------------------|------------------------|----------------------------|
| Occupancy 1 Single Family | *DWELLING COMPUTATIONS | |
| Story Height 1 | Sq-Ft | Value |
| Floor Level | Main BRICK | 3039 207320 |
| | Basement | 3039 55770 |
| | Subtotal | 263090 |
| Shingle | Roof HIP | |
| | B 1 2 U A | |
| Plaster/Drywall | X | Fireplaces 2000 |
| Unfinished Wall | X | Air Conditioning 5320 |
| Floor/Carpet | X | Plumbing 2100 |
| Floor/Tile-Lino | X | Garages and Carports 18930 |
| Number of Rooms | 1 7 | Extra Features 990 |
| Bedrooms | 3 | Total Value 292430 |
| Fireplace | | PUB ELECTRIC |
| Openings | 1 | PRIV WATER |
| Stacks | 1 | PRIV SEWER |
| Central Heat | A | PUB PAVED ST/RD |
| FORCED AIR | | |
| Central A/C | A | Neighborhood: |
| Plumbing | | Code: 3100 |
| Standard | 1 | Dwl/Gar/NC% 1.1800 |
| Extra 3 Fixture | 1 | |

| | | | | | | | | | | |
|---------------|----------|-----------|-------|--------|-----------|-----------|---------|-----|-----|--------|
| Bldg Type | SHB+Cons | DixHt | Area | Unit | Grade | Blt/Renov | Replace | Phy | Fnc | True |
| 1 DWELLING | 1 B B | FtxFt | 3039 | Rate | B | Cond | Value | Dpr | Dpr | Value |
| 2 P | PAT | | 597 | | C | 1987GD | 380160 | .26 | .05 | 315360 |
| | | | | | | 1987AV | 1790 | .65 | | 630 |
| homesite | acres/ | effective | depth | actual | effective | extended | true | | | |
| small acreage | frontage | frontage | depth | rate | rate | value | value | | | |
| | 1.0000 | | | 18000 | 18000 | 18000 | 18000 | | | |
| | .8000 | | | 5000 | 5000 | 4000 | 4000 | | | |

| | | | |
|------------|----------------------------|---------|-------------------------|
| Call Back: | Sign: PSN Date: 2014-11-04 | Lister: | 31-210022.0000-v082020R |
|------------|----------------------------|---------|-------------------------|