

MARION TWP  
UPPER SCIOTO SD

00270

Hardin County, Ohio  
Michael T. Bacon, Auditor

28-520036.0000  
M18

RES  
2025

sale

Eff Rate:- 42.84 — 38.85 — 37.53 — 37.48 — a/r

2022 STEINKE JEFFREY J & P	2015-09-04
2023 STEINKE JEFFREY J & P	2015-09-04
2024 STEINKE JEFFREY J & P	2015-09-04
2025 STEINKE JEFFREY J & PAM	2015-09-04
1706 CR 80	HARRIMANS TR 29 PT S8
	1QC 1.00A
ALGER OH 45812	\$0

Tax Year	2022	2023	2024	2025	CAMA
Prop Cls	511	511	511	511	511
Acres	1.0000	1.0000	1.0000	1.0000	
Land100%	12600	18000	18000	18000	18000
Bldg100%	75800	71340	71340	71340	71330
Totl100%	88400t	89340t	89340t	89340t	89330t
Cauvl00%					

2026 STEINKE JEFFREY J & PAM	2025-09-10
1706 CR 80	1AF
ALGER OH 45812	

Tax Value:					
Land 35%	4410	6300	6300	6300	6300
Bldg 35%	26530	24970	24970	24970	24970
Totl 35%	30940t	31270t	31270t	31270t	31270t
Hmstd35%	30600	30900	30900	30900	
Owner Oc	30.80	25.52	24.18	24.18	hmstd 6300 l 24600 b
Hmstd RB	330.82	318.38	329.46	340.70	
Net Tax	839.28	767.64	721.98	709.16	
Sp-Asmnt	29.68	29.68	46.28	46.28	

2027 CHILE JENNIFER L & PAM	2026-04-03
SHB+ 1706 CR 80	FACT
1 B	1244
OP	100
F	330
DK	286
G	372
P	3000
M	7920
FACT	6860
FACT	5580

a *MAIN	1WD
b PORCH	
c GRAGE	
d GRAGE	
e PORCH	

Sale#	#p	sale date	To	Type/Invalid?	Sale\$	co:land	co:bldg
110	1	2026-04-03	CHILE JENNIFER L & PAM	1WD *	160000	18000	71340
406	1	2025-09-10	STEINKE JEFFREY J & PAMEL	1AF *	0	18000	71340
345	1	2015-09-04	STEINKE JEFFREY J & PAMEL	1QC *	0	10510	55910
106	1	2013-03-15	STEINKE MARGARET	1CT *	0	10510	61110

Year	Land	Bldg	Total	Net Tax
2021	4410	26530	30940	888.78
2020	4410	26530	30940	901.46

Project	ben acres	%	factor
902 MAIN DISTRICT CONSERVANCY			
150 NEWLAND - SCIOTO			
171 COTTONWOOD JT. DITCH #958 -			
910 COTTONWOOD CONSERVANCY			
500 HARDIN COUNTY LANDFILL			

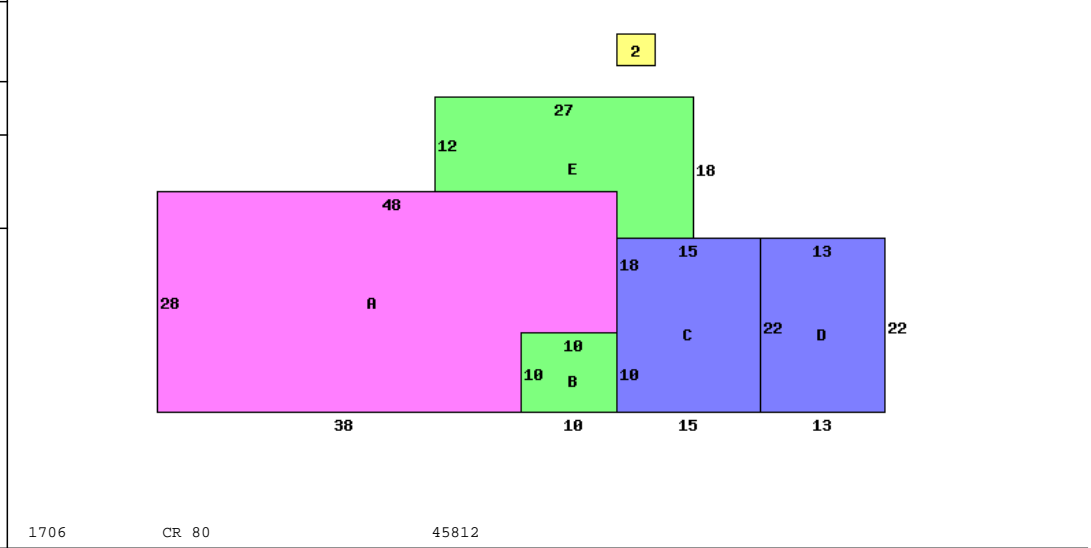

Occupancy	1 Single Family
*DWELLING COMPUTATIONS	
Sq-Ft	
Value	
Story Height	1
Floor Level	Main
	Basement
	Roof
Shingle	B 1 2 U A
Plaster/Drywall	D
Unfinished Wall	X
Floor/Carpet	X
Floor/Concrete	X
Floor/Tile-Lino	X
Number of Rooms	1 5
Bedrooms	3
Fireplace	
Openings	1
Stacks	1
Central Heat	A
FORCED AIR	
Plumbing	
Standard	1
Fireplaces	2000
Garages and Carports	14780
Extra Features	9530
Total Value	144620
PUB ELECTRIC	
PUB GAS	
PRIV WATER	
PRIV SEWER	
PUB PAVED ST/RD	
Topo: ROLLING	
Neighborhood:	
Code:	2800
Dwl/Gar/NC%	1.2000

Bldg Type	1 DWELLING
SHB+Cons	1 B F
DixHt	F 0
Area	1244
Unit Rate	12X16
Grade	C
Blt/Renov	1948AV
Cond	130160
Replace Value	2300
Phy Dpr	.55
Fnc Dpr	.55
True Value	70290
homesite	
acres/ frontage	1.0000
effective frontage	
depth	
actual factor	
effective rate	18000
extended rate	18000
value	18000
true value	18000

1706	CR 80	45812
------	-------	-------

Call Back:

Sign: PSN Date: 2015-06-29 Lister:

28-520036.0000-v082020R