

MARION TWP
UPPER SCIOTO SD

00270

Hardin County, Ohio
Michael T. Bacon, Auditor

28-140031.0000
E20

RES
2025

sale

Eff Rate:- 42.84 — 38.85 — 37.53 — 37.48 — a/r

2022 BEAMAN BRICE	1999-02-11				
2023 BEAMAN BRICE	1999-02-11				
2024 BEAMAN BRICE	1999-02-11				
2025 BEAMAN BRICE	1999-02-11	PT S2 NE4 S14	1.00A		
8315 SR 195	1QC				
ALGER OH 45812	\$0				

Tax Year	2022	2023	2024	2025	CAMA
Prop Cls	511	511	511	511	511
Acres	1.0000	1.0000	1.0000	1.0000	
Land100%	12600	18000	18000	18000	18000
Bldg100%	117770	169260	169260	169260	169260
Totl100%	130370t	187260t	187260t	187260t	187260t
Cauvl00%					

Orig Tax Year 2000
Parent: 28-140003.0000

Tax Value:					
Land 35%	4410	6300	6300	6300	6300
Bldg 35%	41220	59240	59240	59240	59240
Totl 35%	45630t	65540t	65540t	65540t	65540t
Hmstd35%	42370	62150	62150	59860	
Owner Oc	42.64	51.32	48.62	46.84	hmstd 6300 l 53560 b
Hmstd RB					
Net Tax	1728.42	2278.40	2205.82	2204.28	
Sp-Asmnt	27.70	27.70	60.33	60.33	

SHB+	CONS	TYPE	FACT	SQ-FT	VALUE				
1	F/C	M		1568		a	*MAIN		
	FFP	P		224	8960	b	PORCH		
1	F	A		486		c	ADDTN		
	EBW	P		220	8800	d	PORCH		
	F2	G		644	15460	e	GRAGE		
	OFFP	P		240	7200	f	PORCH		

Sale#	#p	sale date	To	Type/Invalid?	Sale\$	co:land	co:bldg
49	1	1999-02-11	BEAMAN BRICE	1QC *	0	0	0
Year	Land	Bldg	Total	Net Tax			
2021	4410	41220	45630	1830.42			
2020	4410	41220	45630	1856.46			

project
500 HARDIN COUNTY LANDFILL XA/2025
902 MAIN DISTRICT CONSERVANCY XA/2025
136 COONEY - SCIOTO XA/2025

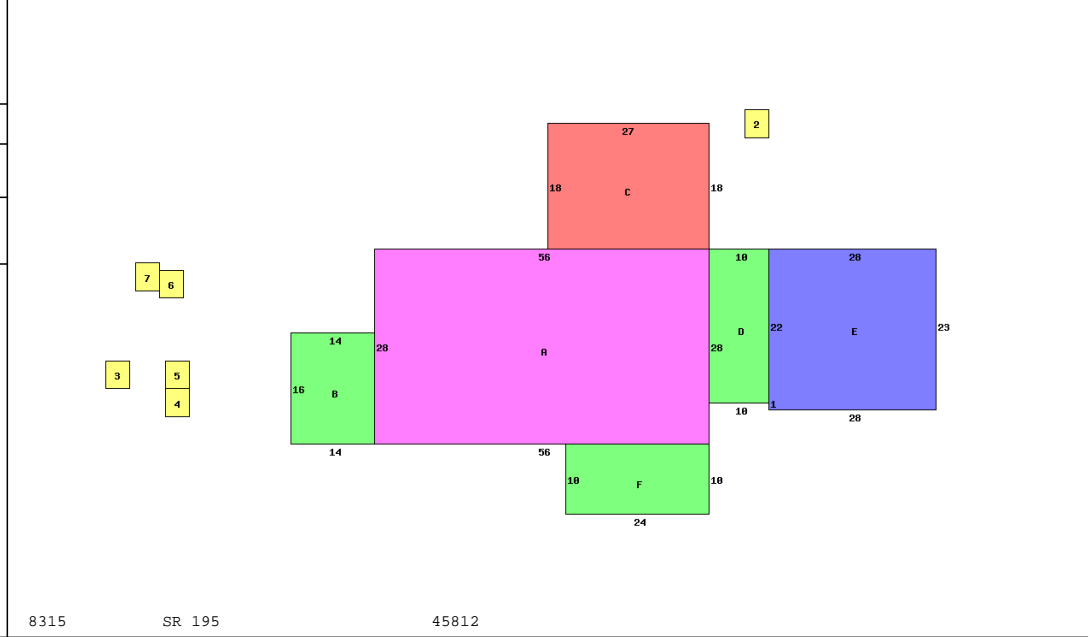

8315 SR 195 45812

Occupancy 1 Single Family		*DWELLING COMPUTATIONS	
Story Height 1		Sq-Ft	Value
Floor Level	Main	FRAME	2054 139900
Metal	Subtotal		139900
	Roof	GABLE	
Plaster/Drywall	X	Air Conditioning	3660
Floor/Carpet	X	Garages and Carports	15460
Number of Rooms	5	Extra Features	27440
Bedrooms	3	Total Value	186460
Central Heat	A	PUB ELECTRIC	
FORCED AIR		PRIV WATER	
Central A/C	A	PRIV SEWER	
Plumbing		PUB PAVED ST/RD	
Standard	1		
		Neighborhood:	
		Code:	2800
		Dwl/Gar/NC%	1.2000

Bldg Type	SHB+Cons	DixHt	Unit	Grade	Blt/Renov	Replace	Phy	Fnc	True
1 DWELLING	1 F/C	2054		C-	1990GD	167810	.24	Dpr	153040
2 Shed	*PP	8X15	120		OLD/	0			0
3 POOLHSE		20X24	480	20.00	2011AV	9600	.20		7680
4 Shed		10X30	300		2013AV	2880	.30		2020
5 P	OFFP	4X10	40		2013AV	960	.30		670
6 Pool	*PP		0		2010	0			0
7 P	DK		650		2010AV	9750	.40		5850

homesite	acres/ frontage	effective frontage	depth	depth factor	actual rate	effective rate	extended value	true value
	1.0000				18000	18000	18000	18000

Call Back: Sign: PSN Date: 2018-05-30 Lister: 28-140031.0000-v082020R