

MARION TWP
UPPER SCIOTO SD

00270

Hardin County, Ohio
Michael T. Bacon, Auditor

28-080006.0000
M16

RES
2025

sale

Eff Rate:- 42.84 — 38.85 — 37.53 — 37.48 — a/r

| | |
|----------------------------|-----------------------------------|
| 2022 DICUS RICHARD D & ELI | 1997-02-24 |
| 2023 DICUS RICHARD D & ELI | 1997-02-24 |
| 2024 DICUS RICHARD D | 2023-11-09 |
| 2025 DICUS RICHARD D | 2023-11-09 SW PT SW 1/4 SE 1/4 S8 |
| 1551 CR 92 | 3AF 8.00A |
| ALGER OH 45812 | \$0 |

| | | | | | |
|------------|--------|--------|--------|--------|--------|
| Tax Year | 2022 | 2023 | 2024 | 2025 | CAMA |
| Prop Cls | 561 | 561 | 561 | 561 | 561 |
| Acres | 8.0000 | 8.0000 | 8.0000 | 8.0000 | |
| Land100% | 17060 | 26490 | 26490 | 26490 | 26490 |
| Bldg100% | 13630 | 15290 | 15290 | 15290 | 15280 |
| Totl100% | 30690t | 41770t | 41770t | 41770t | 41770t |
| Cauv100% | | | | | |
| Tax Value: | | | | | |
| Land 35% | 5970 | 9270 | 9270 | 9270 | 9270 |
| Bldg 35% | 4770 | 5350 | 5350 | 5350 | 5350 |
| Totl 35% | 10740t | 14620t | 14620t | 14620t | 14620t |
| Hmstd35% | | | | | |
| Owner Oc | | | | | |
| Hmstd RB | | | | | |
| Net Tax | 416.86 | 519.70 | 502.90 | 502.16 | |
| Sp-Asmnt | 41.40 | 41.40 | 75.35 | 75.35 | |

| | | | | | | | |
|------|------|------|------|-------|-------|---|-------|
| SHB+ | CONS | TYPE | FACT | SQ-FT | VALUE | | |
| 1 | F/C | M | | 936 | | a | *MAIN |
| | OFF | P | | 120 | 3600 | b | PORCH |

1972 Gallery
This mobile home sits behind the house in the field (used for storage only)
for 2010 n/c check to see if both mhs are gone they are being stripped and
scrapped.

| Sale# | #p | sale date | To | Type/Invalid? | Sale\$ | co:land | co:bdg |
|-------|----|------------|--------------------------|---------------|--------|---------|--------|
| 491 | 3 | 2023-11-09 | DICUS RICHARD D | 3AF * | 0 | 26490 | 15290 |
| 93 | 2 | 1997-02-24 | DICUS RICHARD D & ELIZAB | 2WD | 29000 | 14970 | 10230 |

| Year | Land | Bldg | Total | Net Tax |
|------|------|------|-------|---------|
| 2021 | 5970 | 4770 | 10740 | 441.46 |
| 2020 | 5970 | 4770 | 10740 | 447.76 |

| Project | | ben acres | / % | factor |
|---------|-----------------------------|-----------|-----|--------|
| 902 | MAIN DISTRICT CONSERVANCY | | | |
| 171 | COTTONWOOD JT. DITCH #958 - | | | |
| 910 | COTTONWOOD CONSERVANCY | | | |
| 500 | HARDIN COUNTY LANDFILL | | | |

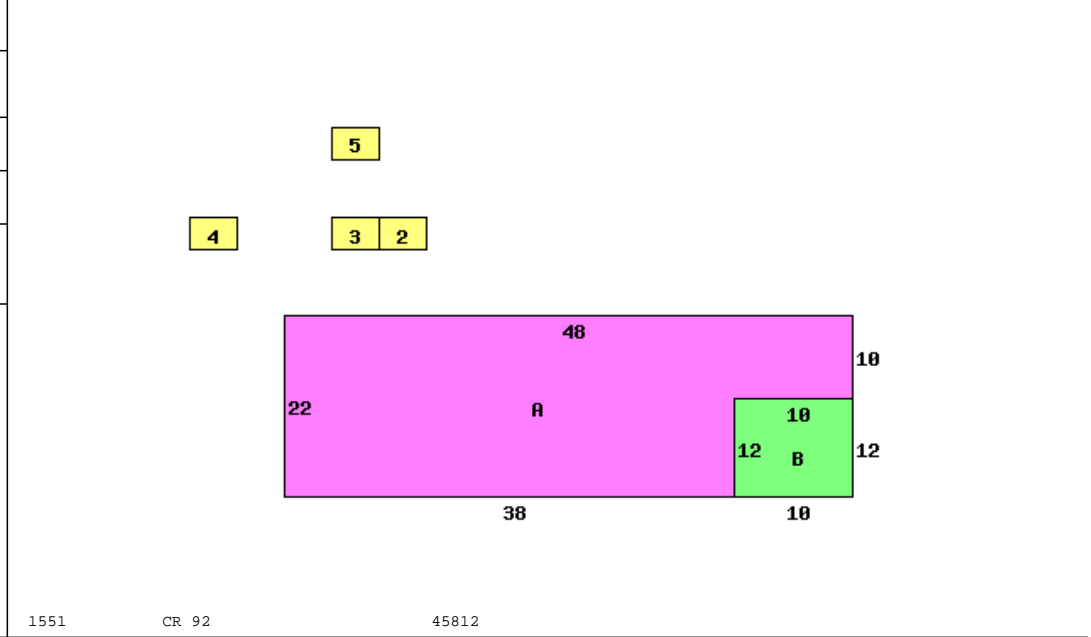

| 1551 | CR 92 | 45812 |
|-----------------|----------------------|------------------------|
| Occupancy | 4 M/H on Real Estate | *DWELLING COMPUTATIONS |
| Story Height | 1 | Sq-Ft Value |
| Floor Level | Main | FRAME 936 102510 |
| Shingle | Roof | GABLE 102510 |
| Plaster/Drywall | X | Extra Features 3600 |
| Floor/Pine | X | Total Value 106110 |
| Number of Rooms | 4 | |
| Bedrooms | 2 | PUB ELECTRIC |
| Central Heat | A | PUB GAS |
| FORCED AIR | | PRIV WATER |
| Plumbing | | PRIV SEWER |
| Standard | 1 | PUB PAVED ST/RD |
| | | Topo: LOW |
| | | Topo: SWAMPY |
| | | Neighborhood: |
| | | Code: 2800 |
| | | Dwl/Gar/NC% 1.2000 |