

MARION TWP
UPPER SCIOTO SD

00270

Hardin County, Ohio
Michael T. Bacon, Auditor

28-050027.0000
N15.01

RES
2023

sale

Eff Rate:- 46.02 — 45.38 — 42.84 — 38.85 — a/r

2020 HUNSICKER TROY	2015-04-16
2021 HUNSICKER TROY	2015-04-16
2022 HUNSICKER TROY	2015-04-16
2023 KING MARIA E & ALLEN E	2022-07-06 PT E2 NE4 S5 4.00A
1890 SR 309	1WD
ALGER OH 45812	\$500,000
	05.0-04-05-027

Tax Year	2020	2021	2022	2023	CAMA
Prop Cls	511	511	511	511	511
Acres	4.0000	4.0000	4.0000	4.0000	
Land100%	21600	21600	21600	33000	33000
Bldg100%	226230	226230	226230	341540	341530
Totl100%	247830t	247830t	247830t	374540t	374530t
Cauv100%					

2024 KING MARIA E & ALLEN JR	0824-05x08ear	2016
1890 SR 309	Parent:1Q28-050004.0000	
ALGER OH 45812		

Tax Value:					
Land 35%	7560	7560	7560	11550	11550
Bldg 35%	79180	79180	79180	119540	119540
Totl 35%	86740t	86740t	86740t	131090t	131090t
Hmstd35%	83170	83170	83170	125410	
Owner Oc	90.02	88.78	83.72	103.58	
Hmstd RB					
Net Tax	3526.20	3476.70	3282.98	4556.22	
Sp-Asmnt	34.29	42.94	40.93	47.57	

SHB+ 1 B	CONS F	TYPE M	FACT G	SQ-FT 2089	VALUE 13820	a *MAIN
	F	G	P	576	13820	b GRAGE
	STP	P	P	24	100	c PORCH
	PAT	P	P	410	1230	d PORCH

Sale#	#p	sale date	To	Type/Invalid?	Sale\$	co:land	co:bldg
319	1	2024-07-08	KING MARIA E & ALLEN JR	C 1QC *	0	33000	341540
344	1	2022-07-06	KING MARIA E & ALLEN E JR	1WD	500000	21600	226230
167	1	2015-04-16	HUNSICKER TROY	1QC	0	0	0

Year	Land	Bldg	Total	Net Tax
2019	7350	63760	71110	2653.78
2018	7350	63760	71110	2666.40

Project	ben acres	%	factor
107 GRASS RUN #933 - HOG CREEK			XA/2023
110 HOG CREEK MAINLINE - HOG CR.			XA/2023
260 SMITH DITCH #1018 - HOG CREE			XA/2023
577 OTTAWA RIVER PROJECT MAINT			XA/2021
500 HARDIN COUNTY LANDFILL			XA/2023

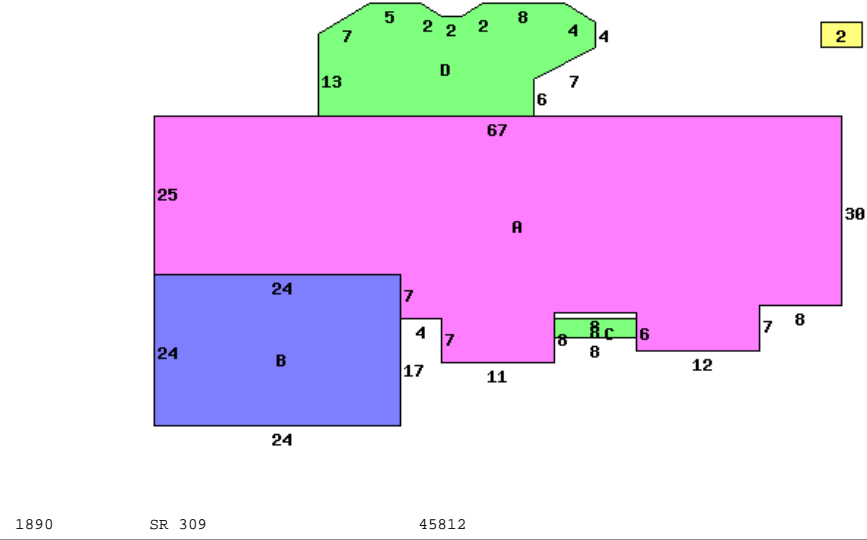

Occupancy 1 Single Family	*DWELLING COMPUTATIONS
Story Height 1	Sq-Ft Value
Floor Level	2089 142280
Main	2089 38500
Basement	180780
Subtotal	
Shingle	Roof GABLE
B 1 2 U A	
Plaster/Drywall	D Air Conditioning 3720
Unfinished Wall	X Plumbing 3500
Floor/Hardwood	X Garages and Carports 13820
Floor/Carpet	X Extra Features 1330
Floor/Concrete	X Total Value 203150
Number of Rooms	1 7
Bedrooms	3
Central Heat	A PUB ELECTRIC
PROPANE	PRIV WATER
Central A/C	A PRIV SEWER
Plumbing	PUB PAVED ST/RD
Standard	1 Neighborhood:
Extra 3 Fixture	1 Code: 2800
Extra 2 Fixture	1 Dwl/Gar/NC% 1.2000

Bldg Type	SHB+Cons	DixHt	Area	Unit	Grade	Blt/Renov	Replace	Phy	Fnc	True
1 DWELLING	1 B F	10X16	2089		C+	2016AV	223470	.06	-.35	340300
2 Shed			160		D	2017AV	1540	.20		1230
homesite	acres/	effective	depth	actual	effective	extended	true			
small acreage	1.0000	frontage	depth	rate	rate	value	value			
	3.0000	frontage	depth	5000	5000	18000	18000			