

MARION TWP
UPPER SCIOTO SD

00270

Hardin County, Ohio
Michael T. Bacon, Auditor

28-020014.0000
T39

RES
2025

sale

Eff Rate:- 42.84 — 38.85 — 37.53 — 37.48 — a/r

2022 WEIHRAUCH SOLOMON P &	2018-02-26
2023 WEIHRAUCH SOLOMON P &	2018-02-26
2024 WEIHRAUCH SOLOMON P &	2018-02-26
2025 WEIHRAUCH SOLOMON P & A	2018-02-26
6795 SR 195	PT E2 NE4 SE4 SE4 S2
	1SD 2.83A SEE 28-020014.01
ALGER OH 45812	\$121,300 FOR AUX SPECIAL ASSESSMEN

Tax Year	2022	2023	2024	2025	CAMA
Prop Cls	511	511	511	511	511
Acres	2.8300	2.8300	2.8300	2.8300	
Land100%	18090	27140	27140	27140	27150
Bldg100%	100800	141510	141510	141510	141520
Totl100%	118890t	168660t	168660t	168660t	168670t
Cauv100%					

2026 JACOMET ELI JORDAN &	2025-09-22
6795 SR 195	1SD
ALGER OH 45812	

Tax Value:					
Land 35%	6330	9500	9500	9500	9500
Bldg 35%	35280	49530	49530	49530	49530
Totl 35%	41610t	59030t	59030t	59030t	59030t
Hmstd35%					
Owner Oc					
Hmstd RB					
Net Tax	1615.04	2098.32	2030.50	2027.50	
Sp-Asmnt	32.79	32.79	29.79	44.37	

SHB+	CONS	TYPE	FACT	SQ-FT	VALUE	a	*MAIN
1	B/C	M		1948			
	B2	G		484	13550	b	GRAGE
	OFF	P		180	5400	c	PORCH
	EFF	P		120	4800	d	PORCH
	DK	P		144	2160	e	PORCH

Sale#	#p	sale date	To	Type/Invalid?	Sale\$	co:land	co:blgd
419	1	2025-09-22	JACOMET ELI JORDAN &	1SD	250000	27140	141510
70	1	2018-02-26	WEIHRAUCH SOLOMON P & ADR	1SD	121300	17490	81060
234	1	2014-06-06	KOELSCH CHRISTOPHER P &	1SD *	97500	16000	110460
525	1	2013-11-21	FRY NORMA J	1CT *	0	16000	110460

Year	Land	Bldg	Total	Net Tax
2021	6330	35280	41610	1710.40
2020	6330	35280	41610	1734.72

Project	ben acres	/ %	factor
500 HARDIN COUNTY LANDFILL			XA/2025
110 HOG CREEK MAINLINE - HOG CR.			XA/2025
120 STOLL - HOG CREEK			XA/2025
291 GRIFFITH DITCH - HOG CREEK M			XA/2025
321 POWELL - HOG CREEK			XA/2025
577 OTTAWA RIVER PROJECT MAINT			XA/2021

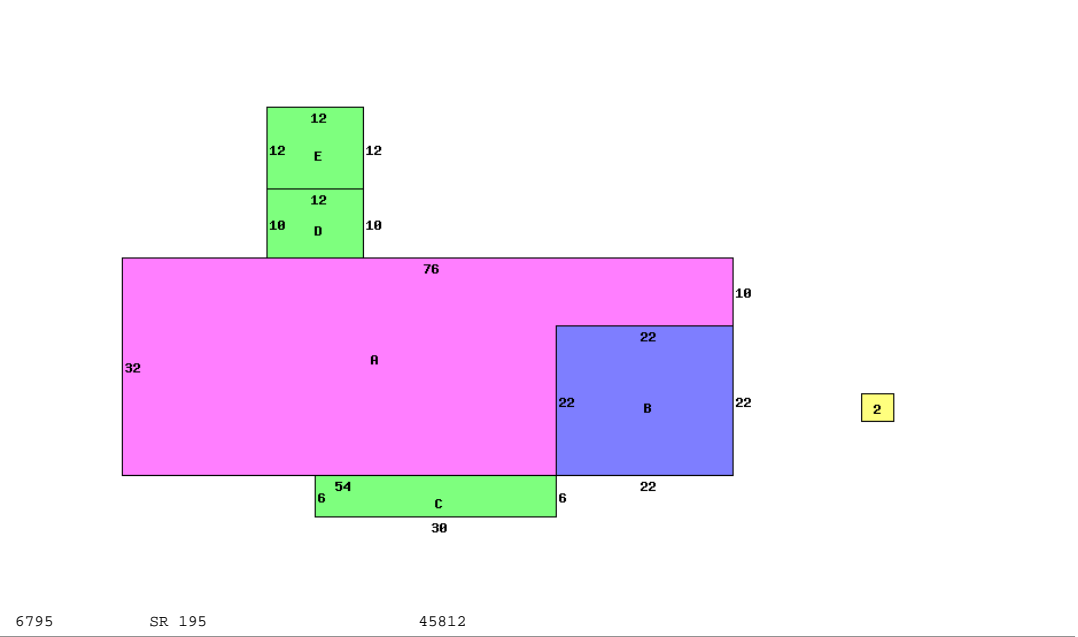

6795 SR 195 45812

Occupancy 1 Single Family				*DWELLING COMPUTATIONS	
Story Height	1			Sq-Ft	Value
Floor Level		Main	BRICK	1948	149820
		Subtotal			149820
Metal		Roof	GABLE		
Plaster/Drywall	D			Air Conditioning	3330
Floor/Carpet	X			Plumbing	1400
Floor/Tile-Lino	X			Garages and Carports	13550
Number of Rooms	5			Extra Features	12360
Bedrooms	2			Total Value	180460
Central Heat	A			PUB ELECTRIC	
FORCED AIR				PRIV WATER	
Heat Pump	A			PRIV SEWER	
Central A/C	A				
Plumbing				Neighborhood:	
Standard	1			Code:	2800
Extra 2 Fixture	1			Dwl/Gar/NC%	1.2000

Bldg Type	SHB+Cons	DixHt	Unit	Blt/Renov	Replace	Phy	Fnc	True
1 DWELLING	1 B/C	1948		D+	1980GD	.28		132530
2 Garage		26X30	780	C	1984GD	.60		8990
homesite	acres/	effective	depth	actual	effective	extended	true	
small acreage	frontage	frontage	depth	rate	rate	value	value	
	1.0000	18000		18000	18000	18000	18000	
	1.8300	5000		5000	5000	9150	9150	