

MARION TWP
UPPER SCIOTO SD

00270

Hardin County, Ohio
Michael T. Bacon, Auditor

28-010032.0000
V04

RES
2025

sale

Eff Rate:- 42.84 — 38.85 — 37.53 — 37.48 — a/r

| | |
|---------------------|---------------------------------|
| 2022 NAU DAVID PAUL | 2020-01-15 |
| 2023 NAU DAVID PAUL | 2020-01-15 |
| 2024 NAU DAVID PAUL | 2020-01-15 |
| 2025 NAU DAVID PAUL | 2020-01-15 PT NE4 NE4 S1 4.168A |
| 6097 CR 75 | LWD |
| ADA OH 45810 | \$368,500 |

| | | | | | |
|----------|---------|---------|---------|---------|---------|
| Tax Year | 2022 | 2023 | 2024 | 2025 | CAMA |
| Prop Cls | 511 | 511 | 511 | 511 | 511 |
| Acres | 4.1680 | 4.1680 | 4.1680 | 4.1680 | |
| Land100% | 20600 | 31340 | 31340 | 31340 | 31340 |
| Bldg100% | 339370 | 373660 | 373660 | 373660 | 373670 |
| Totl100% | 359970t | 405000t | 405000t | 405000t | 405010t |
| Cauvl00% | | | | | |

Orig Tax Year 2001
Parent: 28-010004.0000

| | | | | | |
|------------|---------|---------|---------|---------|-----------------------|
| Tax Value: | 7210 | 10970 | 10970 | 10970 | 10970 |
| Land 35% | 118780 | 130780 | 130780 | 130780 | 130780 |
| Bldg 35% | 125990t | 141750t | 141750t | 141750t | 141750t |
| Totl 35% | 120050 | 133160 | 133160 | 133160 | 133160 |
| Hmstd35% | 120.84 | 109.98 | 104.20 | 104.22 | |
| Owner Oc | | | | | hmstd 6300 l 126860 b |
| Hmstd RB | | | | | |
| Net Tax | 4769.28 | 4928.74 | 4771.72 | 4764.48 | |
| Sp-Asmnt | 37.74 | 42.32 | 39.32 | 42.32 | |

| SHB+ | CONS | TYPE | FACT | SQ-FT | VALUE | | |
|------|------|------|------|-------|-------|---|-------|
| 2 B | F | M | | 874 | | a | *MAIN |
| 1 B | F | A | | 324 | | b | ADDN |
| 1 B | F | A | | 632 | | c | ADDN |
| 1 B | F | A | | 223 | | d | ADDN |
| | F | G | | 946 | 22700 | e | GRAGE |
| | OFFP | P | | 154 | 4620 | f | PORCH |
| | EFP | P | | 192 | 7680 | g | PORCH |

| Sale# | #p | sale date | To | Type/Invalid? | Sale\$ | co:land | co:bldg |
|-------|----|------------|--------------------------|---------------|--------|---------|---------|
| 18 | 1 | 2020-01-15 | NAU DAVID PAUL | LWD | 368500 | 20000 | 273540 |
| 251 | 1 | 2006-04-28 | MORGAN BILLY T & AMY J | LWD | 312000 | 17910 | 267690 |
| 22 | 1 | 2000-01-07 | BOLEN KEITH & YOLANDA SU | LWD | 23500 | 0 | 0 |

| Year | Land | Bldg | Total | Net Tax |
|------|------|--------|--------|---------|
| 2021 | 7210 | 118780 | 125990 | 5178.88 |
| 2020 | 7210 | 118780 | 125990 | 5122.62 |

| Project | ben acres | % | factor |
|----------------------------------|-----------|---|---------|
| 500 HARDIN COUNTY LANDFILL | | | XA/2025 |
| 110 HOG CREEK MAINLINE - HOG CR. | | | XA/2025 |
| 120 STOLL - HOG CREEK | | | XA/2025 |
| 321 POWELL - HOG CREEK | | | XA/2025 |
| 577 OTTAWA RIVER PROJECT MAINT | | | XA/2021 |

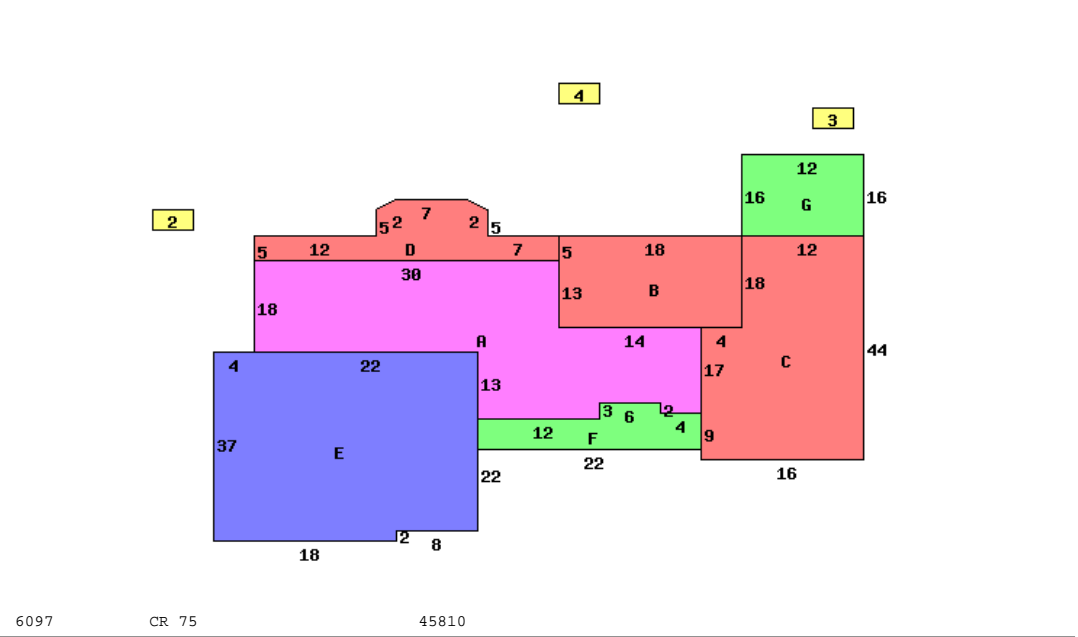

| Occupancy 1 Single Family | | | | *DWELLING COMPUTATIONS | |
|---------------------------|------------|-----------|----------------------|------------------------|--|
| Story Height | 2 | Sq-Ft | Value | | |
| Floor Level | Main | FRAME | 2053 | 139830 | |
| | Full Upper | FRAME | 874 | 59680 | |
| | Basement | | 2053 | 37840 | |
| | Subtotal | | | 237350 | |
| Shingle | Roof | HIP | | | |
| Plaster/Drywall | D D | 500 sq ft | Basement Finish | 5570 | |
| Unfinished Wall | X | | Air Conditioning | 5240 | |
| Floor/Carpet | X X | | Plumbing | 5600 | |
| Floor/Concrete | X | | Garages and Carports | 22700 | |
| Floor/Tile-Lino | X | | Extra Features | 13980 | |
| Number of Rooms | 3 7 4 | | Total Value | 290440 | |
| Bedrooms | 1 3 | | | | |
| Central Heat | A | | PUB ELECTRIC | | |
| FORCED AIR | | | PRIV WATER | | |
| Central A/C | A | | PRIV SEWER | | |
| Plumbing | | | PUB PAVED ST/RD | | |
| Standard | 1 | | Neighborhood: | | |
| Extra 3 Fixture | 2 | | Code: | 2800 | |
| Extra 2 Fixture | 1 | | Dwl/Gar/NC% | 1.2000 | |

| Bldg Type | SHB+Cons | DixHt | Area | Unit | Grade | Blt/Renov | Replace | Phy | Fnc | True |
|---------------|----------|----------|-----------|--------|--------|-----------|----------|-------|-----|--------|
| 1 DWELLING | 2 B F | FtxFt | 3427 | Rate | B | 2003AV | 377570 | .20 | Dpr | 362470 |
| 2 Shed | *NV | | 0 | | | OLD/ | 0 | | | 0 |
| 3 Shed | *NV | | 0 | | | OLD/ | 0 | | | 0 |
| 4 Pool | | | 640 | | C | 2006AV | 32000 | .50 | .30 | 11200 |
| homesite | | acres/ | effective | depth | actual | effective | extended | true | | |
| small acreage | | frontage | frontage | depth | rate | rate | value | value | | |
| | | 1.0000 | | factor | 18000 | 18000 | 18000 | 18000 | | |
| | | 3.1680 | | | 5000 | 4210 | 13340 | 13340 | | |

Call Back: Sign: PSN Date: 2015-07-08 Lister: 28-010032.0000-v082020R