

LYNN TWP
UPPER SCIOTO SD

00260

Hardin County, Ohio
Michael T. Bacon, Auditor

27-180010.0000
M36

RES
2025

sale

Eff Rate:- 45.67 — 37.90 — 38.58 — 38.48 — a/r

2022 YATES BOBBY G & DINAH	2000-11-06				
2023 YATES BOBBY G & DINAH	2000-11-06				
2024 YATES BOBBY G & DINAH	2000-11-06				
2025 YATES BOBBY G & DINAH L	2000-11-06	PRICES 2ND 16 & PT VAC			
9664-9668 CR 89	2WD	ALLEY			
ALGER OH 45812	\$0				

Tax Year	2022	2023	2024	2025	2025	CAMA
Prop Cls	520	520	520	520	520	520
Acres						
Land100%	2770	4430	4430	4430	4430	4420
Bldg100%	30000	40490	40490	40490	40490	40480
Totl100%	32770t	44910t	44910t	44910t	44910t	44900t
Cauv100%						
Tax Value:						
Land 35%	970	1550	1550	1550	1550	1550
Bldg 35%	10500	14170	14170	14170	14170	14170
Totl 35%	11470t	15720t	15720t	15720t	15720t	15710t
Hmstd35%						
Owner Oc						
Hmstd RB						
Net Tax	476.68	541.72	555.08	553.58	553.58	
Sp-Asmnt	44.23	43.27	54.65	56.58		

SHB+	CONS	TYPE	FACT	SQ-FT	VALUE	a	*MAIN
1H	F/C	M		408		b	ADDTN
1	F/C	A		376		c	ADDTN
1	F/C	A		120		d	PORCH
	STP	P		90	360	e	PORCH
	DK	P		48	720		

L/C JESSICA L NICHOLS 6-22-21 \$57,145 INCLUDES 27-180009

Sale#	#p	sale date	To	Type/Invalid?	Sale\$	co:land	co:bldg
658	2	2000-11-06	YATES BOBBY G & DINAH L	2WD	0	2630	23710
858	1	1995-09-08	ALLEN MICHAEL	1AF *	0	3710	12510
156	1	1990-03-05		1WD	15000	0	17400

Year	Land	Bldg	Total	Net Tax
2021	970	10500	11470	503.00
2020	970	10500	11470	509.72

Project	ben acres	%	factor
902 MAIN DISTRICT CONSERVANCY			XA/2025
156 MCCOY 937 - SCIOTO			XA/2025
500 HARDIN COUNTY LANDFILL			XA/2025

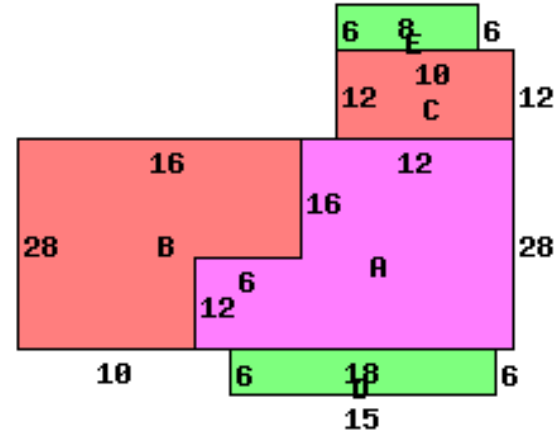

9664 - 9668 CR 89 45812

Occupancy 1 Single Family		*DWELLING COMPUTATIONS	
Story Height	1H	Sq-Ft	Value
Floor Level	Main	FRAME	904 99010
	Part Upper	FRAME	408 22520
	Subtotal		121530
Shingle	Roof	GABLE	
	B 1 2 U A		
Plaster/Drywall	X	X	Air Conditioning 2330
Panelled Wall	X		Extra Features 1080
Floor/Pine	X	X	Total Value 124940
Floor/Carpet	X		
Floor/Tile-Lino	L		PUB ELECTRIC
Number of Rooms	4	2	PRIV WATER
Bedrooms	1	2	PRIV SEWER
			PUB ALLEY
Central Heat	A		
FORCED AIR			Neighborhood:
Central A/C	A		Code: 2610
Plumbing			Dwl/Gar/NC% .8000
Standard	1		

Bldg Type	SHB+Cons	DixHt	Unit	Grade	Blt/Renov	Replace	Phy	Fnc	True
1 DWELLING	1H F/C				C-	OLD/AV	.55		40480
	acres/	effective	depth	depth	actual	effective	extended	true	
front lot	frontage	frontage	factor	factor	rate	rate	value	value	
	60.0000	85.00	160	103	50	52	4420	4420	

Call Back:

Sign: PSN Date: 2015-04-01 Lister:

27-180010.0000-v082020R