

LYNN TWP
KENTON SD

00250

Hardin County, Ohio
Michael T. Bacon, Auditor

26-130049.0000
E30.01

RES
2025

sale

Eff Rate:- 49.68 — 43.90 — 46.27 — 45.98 — a/r

2022	PEMBERTON RICHARD L	2010-08-25		
2023	PEMBERTON RICHARD L	2010-08-25		
2024	PEMBERTON RICHARD L	2010-08-25		
2025	PEMBERTON RICHARD L	2010-08-25	10664	2.00A
	8994 CR 150	LWD		
		\$30,000		
	KENTON OH 43326			

Tax Year	2022	2023	2024	2025	CAMA
Prop Cls	511	511	511	511	511
Acres	2.0000	2.0000	2.0000	2.0000	
Land100%	15600	20000	20000	20000	20000
Bldg100%	75940	98770	98770	98770	98780
Totl100%	91540t	118770t	118770t	118770t	118780t
Cauvl00%					
Tax Value:					
Land 35%	5460	7000	7000	7000	7000
Bldg 35%	26580	34570	34570	34570	34570
Totl 35%	32040t	41570t	41570t	41570t	41570t
Hmstd35%	30610	39370	39370	39370	
Owner Oc	29.62	34.74	34.70	34.60	hmstd 5250 l 34120 b
Hmstd RB					
Net Tax	1438.20	1643.32	1742.34	1730.50	
Sp-Asmnt	26.35	25.48	40.01	41.76	

Orig Tax Year 2011
Parent: 26-130012.0000

SHB+	CONS	TYPE	FACT	SQ-FT	VALUE	a	*MAIN
1HB	F	M		848		b	ADDN
1 B	F	A		288		c	ADDN
1	F/C	A		288		d	PORCH
	OFF	P		112	3360	e	PORCH
	OFF	P		100	3000	f	PORCH
	PAT	P		35	110	g	PORCH
	DK	P		352	5280		

Sale#	#p	sale date	To	Type/Invalid?	Sale\$	co:land	co:bldg
400	1	2010-08-25	PEMBERTON RICHARD L	LWD *	30000	0	0
278	1	2010-07-20	WOLFE BRENDA K	LQC *	0	0	0

Year	Land	Bldg	Total	Net Tax
2021	5460	26580	32040	1443.68
2020	5460	26580	32040	1246.02

Project
500 HARDIN COUNTY LANDFILL XA/2025
902 MAIN DISTRICT CONSERVANCY XA/2025
156 MCCOY 937 - SCIOTO XA/2025
ben acres / % factor

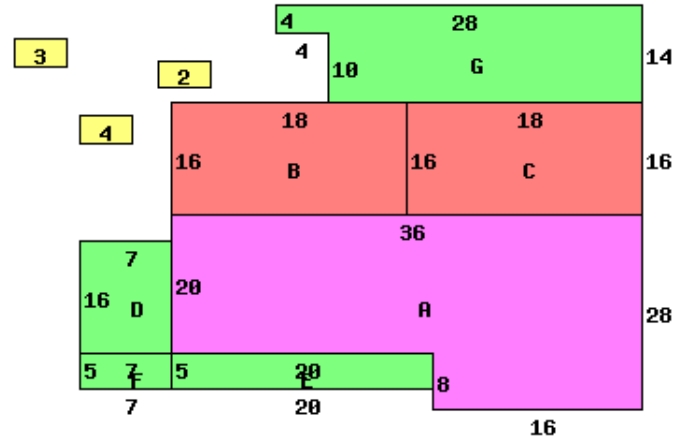

8994 CR 150 43326

Occupancy 1 Single Family	*DWELLING COMPUTATIONS	
Story Height 1H	Sq-Ft	Value
Floor Level		
Main	FRAME	1424 112580
Part Upper	FRAME	848 37140
Basement		1136 21160
Subtotal		170880
Metal Roof	GABLE	
Plaster/Drywall	X X	Extra Features 11750
Unfinished Wall	X	Total Value 182630
Floor/Pine	X X	
Floor/Carpet	X	
Floor/Concrete	X	PUB ELECTRIC
Floor/Tile-Lino	X	PRIV WATER
Number of Rooms	1 6 2	PRIV SEWER
Bedrooms	1 2	PUB PAVED ST/RD
Central Heat	A	Neighborhood:
HOT WATER		Code: 2600
Plumbing		Dwl/Gar/NC% 1.1100
Standard	1	

Bldg Type	SHB+Cons	DixHt	Unit	Grade	Blt/Renov	Replace	Phy	Fnc	True
1 DWELLING	1H F/C	2272		C	OLD/AV	182630	.55	Dpr	91220
2 Garage		24X28 672		C	1972AV	16130	.65		6270
3 Shed		16X24 384		D	OLD/AV	3690	.65		1290
4 Shed	*PP	10X12 0			OLD/	0			0
homesite	acres/	effective	depth	actual	effective	extended	true		
small acreage	frontage	frontage	depth	rate	rate	value	value		
	1.0000	1.0000		15000	15000	15000	15000		
	1.0000			5000	5000	5000	5000		