

LYNN TWP  
KENTON SD

00250

Hardin County, Ohio  
Michael T. Bacon, Auditor

26-110012.0000  
H18

RES  
2025

sale

Eff Rate:- 49.68 — 43.90 — 46.27 — 45.98 — a/r

2022 WILCOX RODNEY H	2005-07-26				
2023 WILCOX RODNEY H	2005-07-26				
2024 WILCOX RODNEY H	2005-07-26				
2025 WILCOX RODNEY H	2005-07-26	6315	1.002A		
12489 TR 95	1QC				
KENTON OH 43326	\$0				

Tax Year	2022	2023	2024	2025	CAMA
Prop Cls	511	511	511	511	511
Acres	1.0020	1.0020	1.0020	1.0020	15010
Land100%	12600	15000	15000	15000	122960
Bldg100%	81510	122970t	122970t	122970t	137970t
Totl100%	94110t	137970t	137970t	137970t	
Cauvl00%					
Tax Value:					
Land 35%	4410	5250	5250	5250	5250
Bldg 35%	28530	43040	43040	43040	43040
Totl 35%	32940t	48290t	48290t	48290t	48290t
Hmstd35%					
Owner Oc	31.88	42.62	42.56	42.44	
Hmstd RB					
Net Tax	1477.14	1906.68	2021.74	2007.98	
Sp-Asmnt	25.73	25.73	46.40	46.76	

Orig Tax Year 2001  
Parent: 26-110006.0000

SHB+	CONS	TYPE	FACT	SQ-FT	VALUE	a	*MAIN
1	F/C	M		1680			ADDTN
1	F	A		576			PORCH
	OFF	P		72	2160		GRAGE
	F	G		672	16130		PORCH
	DK	P		552	8280		

Sale#	#p	sale date	To	Type/Invalid?	Sale\$	co:land	co:bldg
269	1	2005-07-26	WILCOX RODNEY H	1QC *	0	8000	60800
513	1	2000-09-01	WILCOX RODNEY H	1WD	50000	0	0

Year	Land	Bldg	Total	Net Tax
2021	4410	28530	32940	1482.80
2020	4410	28530	32940	1279.62

project	ben acres	/	%	factor
500 HARDIN COUNTY LANDFILL				XA/2025
156 MCCOY 937 - SCIOTO				XA/2025
902 MAIN DISTRICT CONSERVANCY				XA/2025

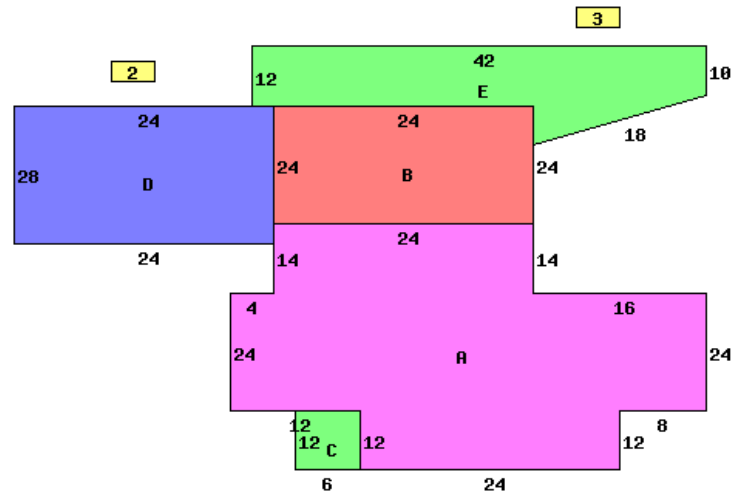

12489 TR 95 43326

Occupancy 1 Single Family	*DWELLING COMPUTATIONS
Story Height 1	Sq-Ft Value
Floor Level	2256 150450
Metal	150450
Plaster/Drywall X	Fireplaces 2000
Floor/Carpet X	Plumbing 1400
Floor/Tile-Lino X	Garages and Carports 16130
Number of Rooms 4	Extra Features 14640
Bedrooms 2	Total Value 184620
Fireplace	PUB ELECTRIC
Openings 1	PUB PAVED ST/RD
Stacks 1	
Central Heat A	Neighborhood:
FORCED AIR	Code: 2600
Plumbing	Dwl/Gar/NC% 1.1100
Standard 1	
Extra 2 Fixture 1	

Bldg Type	SHB+Cons	DixHt	Unit	Blt/Renov	Replace	Phy	Fnc	True
1 DWELLING	1 F/C	2256	Rate	Cond	Value	Dpr	Dpr	Value
2 Shed	*PP	10X14	Area	Grade	184620	.40		122960
3 Pool	*PP		140		0			0
			0		2014	0		0
small acreage	effective	depth	depth	actual	effective	extended	true	
homesite	frontage	depth	factor	rate	rate	value	value	
	.0020			5000	5000	10	10	
	1.0000			15000	15000	15000	15000	
	Total Value							

Call Back:

Sign: PSN Date: 2015-03-31 Lister:

26-110012.0000-v082020R