

LYNN TWP  
KENTON SD

00250

Hardin County, Ohio  
Michael T. Bacon, Auditor

26-070045.0000  
J33

RES  
2025

sale

Eff Rate:- 49.68 — 43.90 — 46.27 — 45.98 — a/r

2022 CAREY CHARLES E & KIM	1986-10-21
2023 CAREY CHARLES E & KIM	1986-10-21
2024 CAREY CHARLES E & KIM	1986-10-21
2025 CAREY CHARLES E & KIMBE	1986-10-21 12093 .60A
15266 CR 115	
KENTON OH 43326	\$37,000

Tax Year	2022	2023	2024	2025	CAMA
Prop Cls	511	511	511	511	511
Acres	.6000	.6000	.6000	.6000	
Land100%	9830	11710	11710	11710	11700
Bldg100%	93140	106340	106340	106340	106330
Totl100%	102970t	118060t	118060t	118060t	118030t
Cauvl00%					
Tax Value:					
Land 35%	3440	4100	4100	4100	4090
Bldg 35%	32600	37220	37220	37220	37220
Totl 35%	36040t	41320t	41320t	41320t	41310t
Hmstd35%	36040	41320	41320	41320	
Owner Oc	34.88	36.46	36.42	36.32	hmstd 4100 l 37220 b
Hmstd RB	392.36	362.10	410.26	422.08	
Net Tax	1223.80	1269.40	1319.66	1296.08	
Sp-Asmnt	24.73	24.73	36.64	36.64	

SHB+	CONS	TYPE	FACT	SQ-FT	VALUE	a	*MAIN
1	F/C	M		1404		b	GRAGE
	F2	G		506	12140	c	PORCH
	RFX	P		114	1140	d	PORCH
	STP	P		114	460	e	PORCH
	DK	P		400	6000		

Sale#	#p	sale date	To	Type/Invalid?	Sale\$	co:land	co:bldg
878	0	1986-10-21		*	37000	0	46430

Year	Land	Bldg	Total	Net Tax
2021	3440	32600	36040	1228.48
2020	3440	32600	36040	1060.12

project	ben acres	/	%	factor
902 MAIN DISTRICT CONSERVANCY				XA/2025
279 SILVER CREEK - SCIOTO RIVER				XA/2025
500 HARDIN COUNTY LANDFILL				XA/2025

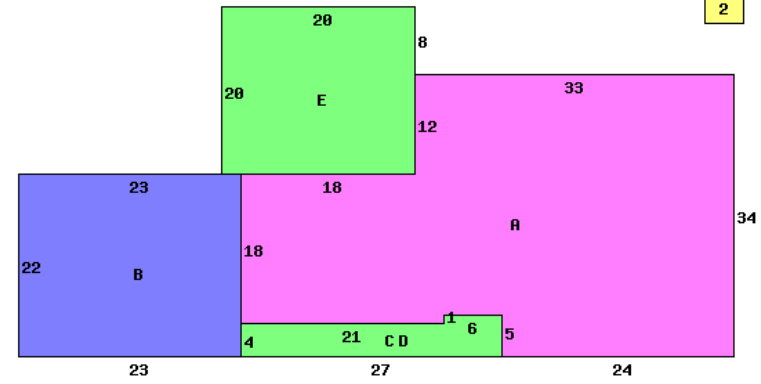

15266 CR 115 43326

Occupancy 1 Single Family	*DWELLING COMPUTATIONS
Story Height 1	Sq-Ft Value
Floor Level	1404 111000
Shingle	Subtotal 111000
Plaster/Drywall	X
Panelled Wall	X
Floor/Pine	X
Floor/Carpet	X
Number of Rooms	6
Bedrooms	3
Central Heat	A
FORCED AIR	
Central A/C	A
Plumbing	
Standard	1
Extra 2 Fixture	1
	PUB ELECTRIC
	PUB GAS
	PRIV WATER
	PRIV SEWER
	PUB PAVED ST/RD
	Topo: ROLLING
	Neighborhood:
	Code: 2600
	Dwl/Gar/NC% 1.1100

Bldg Type	SHB+Cons	DixHt	Unit	Grade	Blt/Renov	Replace	Phy	Fnc	True
1 DWELLING	1 F/C	10X15	150	C	1973GD	136840	.30	Dpr	106330
2 Shed	*PP F				1995AV	0			0
homesite	acres/	effective	depth	actual	effective	extended	true		
	frontage	frontage	depth	rate	rate	value	value		
	.6000	15000	15000	15000	15000	11700	11700		

Call Back:

Sign: PSN Date: 2015-04-02 Lister:

26-070045.0000-v082020R