

LIBERTY TWP
ADA CORP

00240

Hardin County, Ohio
Michael T. Bacon, Auditor

25-240073.0000
J91

RES
2025

sale

2022 CANO ANDREW K & JESSI	2016-09-28
2023 CANO ANDREW K & JESSI	2016-09-28
2024 CANO ANDREW K & JESSI	2016-09-28
2025 CANO ANDREW K & JESSICA	2016-09-28
715 W LIMA ST	1SD
ADA OH 45810	\$218,850

Eff Rate:-	47.64	41.58	41.81	42.27	a/r
Tax Year	2022	2023	2024	2025	2025
Prop Cls	510	510	510	510	510
Acres					
Land100%	19770	20740	20740	20740	20740
Bldg100%	153940	188940	188940	188940	188940
Totl100%	173710t	209690t	209690t	209690t	209690t
Cauvl00%					
Tax Value:					
Land 35%	6920	7260	7260	7260	7260
Bldg 35%	53880	66130	66130	66130	66130
Totl 35%	60800t	73390t	73390t	73390t	73390t
Hmstd35%				69700	69700
Owner Oc				59.44	59.80
Hmstd RB					
Net Tax	2671.06	2799.56	2818.44	2773.64	2790.32
Sp-Asmnt	69.60	79.04	76.04	79.04	

SHB+	CONS	TYPE	FACT	SQ-FT	VALUE		
1 B	F	M		816		a	*MAIN
	STP	P		30	120	b	PORCH
	F2	G		550	13200	c	GRAGE
	DK	P		465	6980	d	PORCH
1	F/C	A		616		e	ADDTN

Sale#	#p	sale date	To	Type/Invalid?	Sale\$	co:land	co:bldg
437	1	2016-09-28	CANO ANDREW K & JESSICA B	1SD	218850	10660	123540
402	1	2014-09-16	MORGAN BRUCE A & ANITA RA	1SD	140000	10660	115860
413	1	2010-10-27	COURTNEY JUSTIN F	1QC *		0	11000
165	1	2005-03-21	COURTNEY JUSTIN F & TABI	1WD	144000	9400	107490
426	1	2001-08-23	RENTERIA MARIO LUIS & TH	1WD	142000	9400	94400
509	1	1998-08-28	ZIMMERMAN ARIC	1WD	130000	10830	82860

Year	Land	Bldg	Total	Net Tax
2021	6920	53880	60800	2940.48
2020	6920	53880	60800	2984.14

project	ben acres	/ %	factor
107 GRASS RUN #933 - HOG CREEK			XA/2025
500 HARDIN COUNTY LANDFILL			XA/2025
110 HOG CREEK MAINLINE - HOG CR.			XA/2025
598 ADA LIGHTS			XV/2025
577 OTTAWA RIVER PROJECT MAINT			XA/2021

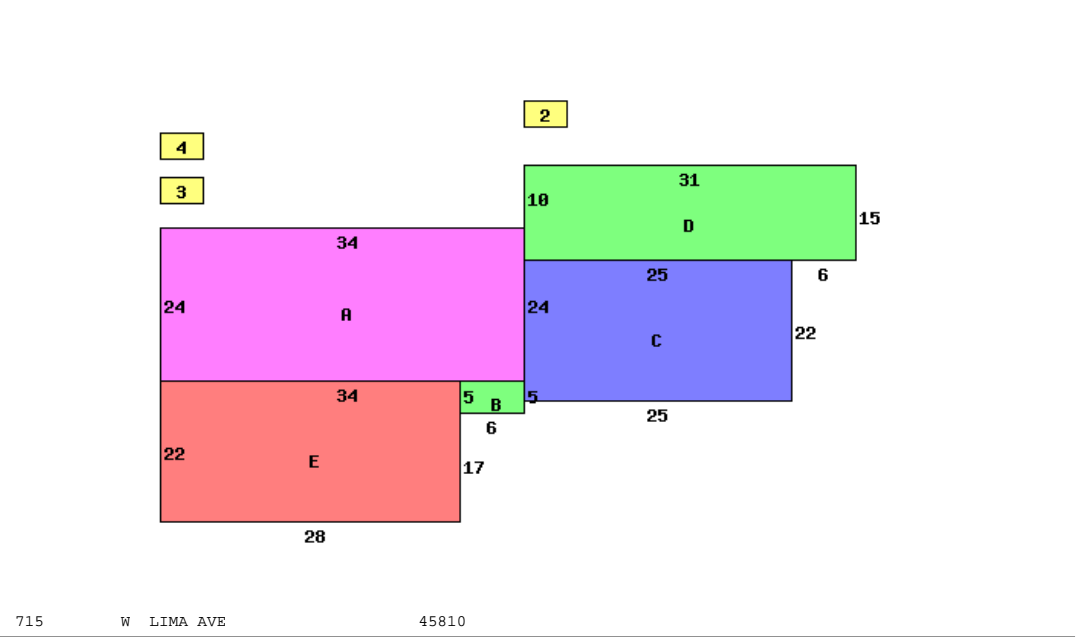

Occupancy	1 Single Family	*DWELLING COMPUTATIONS
Story Height	1	Sq-Ft Value
Floor Level	Main	FRAME 1432 113210
	Basement	816 15260
	Subtotal	128470
Shingle	Roof	GABLE
Plaster/Drywall	X X	816 sq ft Basement Finish 8890
Floor/Pine	X	Air Conditioning 2510
Floor/Carpet	X	Plumbing 3500
Number of Rooms	1 8	Garages and Carports 13200
Bedrooms	3	Extra Features 9180
		Total Value 165750
Central Heat	A	
ELECTRIC		PUB PAVED ST/RD
Central A/C	A	
Plumbing		Neighborhood:
Standard	1	Code: 2510
Extra 3 Fixture	1	Dwl/Gar/NC% 1.1500
Extra 2 Fixture	1	

Bldg Type	SHB+Cons	DixHt	Unit	Blt/Renov	Replace	Phy	Fnc	True
1 DWELLING	1 B F	2248	Rate	Grade	Cond	Value	Dpr	Dpr
2 Pool	CB 0	16X32	512	C	1978VG	198900	.22	178410
3 Shed	*PP	6X6	36		1980AV	25600	.50	.30
4 Shed		12X16	192	D	OLD/	0		0
					2020AV	1840	.15	1560
front lot	acres/	effective	depth	actual	effective	extended	true	
	frontage	frontage	depth	factor	rate	value	value	
		96.00	145	98	220	216	20740	20740