

LIBERTY TWP
ADA CORP

00240

Hardin County, Ohio
Michael T. Bacon, Auditor

25-200200.0000
I149

RES
2025

sale

2022 DIPIETRO NATALIE A	2007-07-03			
2023 DIPIETRO NATALIE A	2007-07-03			
2024 MAGER JOHN N III & MA	2023-11-15			
2025 MAGER JOHN N III & MAGE	2023-11-15	GUYTON ADDT ADA VILLAS		
456 PAMPAS DR	1WD	UNIT 3		
ADA OH 45810	\$0			

Eff Rate:-	47.64	41.58	41.81	42.27	a/r	
Tax Year	2022	2023	2024	2025	2025	CAMA
Prop Cls	550	550	550	550	550	550
Acres						
Land100%	30000	30000	30000	30000	30000	30000
Bldg100%	145740	179860	179860	179860	179860	179870
Totl100%	175740t	209860t	209860t	209860t	209860t	209870t
Cauvl00%						
Tax Value:						
Land 35%	10500	10500	10500	10500	10500	10500
Bldg 35%	51010	62950	62950	62950	62950	62950
Totl 35%	61510t	73450t	73450t	73450t	73450t	73450t
Hmstd35%	61510					
Owner Oc	57.10	63.04				
Hmstd RB						
Net Tax	2645.14	2738.82	2820.74	2835.38	2852.44	
Sp-Asmnt	70.14	79.10	76.10	79.10		

SHB+	CONS	TYPE	FACT	SQ-FT	VALUE		
1	F/C	M		1443		a	*MAIN
	F	F	G	576	16730	b	GRAGE
	OMP	P	P	36	1260	c	PORCH
	DK	P		192	2880	d	PORCH

Sale#	#p	sale date	To	Type/Invalid?	Sale\$	co:land	co:bldg
474	1	2023-11-15	MAGER JOHN N III & MAGER	1WD *	0	30000	179860
340	1	2007-07-03	DIPIETRO NATALIE A	1WD	176497	0	0

Year	Land	Bldg	Total	Net Tax
2021	10500	51010	61510	2906.74
2020	10500	51010	61510	2949.76

project	ben acres	/ %	factor
107 GRASS RUN #933 - HOG CREEK			XA/2025
110 HOG CREEK MAINLINE - HOG CR.			XA/2025
500 HARDIN COUNTY LANDFILL			XA/2025
598 ADA LIGHTS			XV/2025
577 OTTAWA RIVER PROJECT MAINT			XA/2021

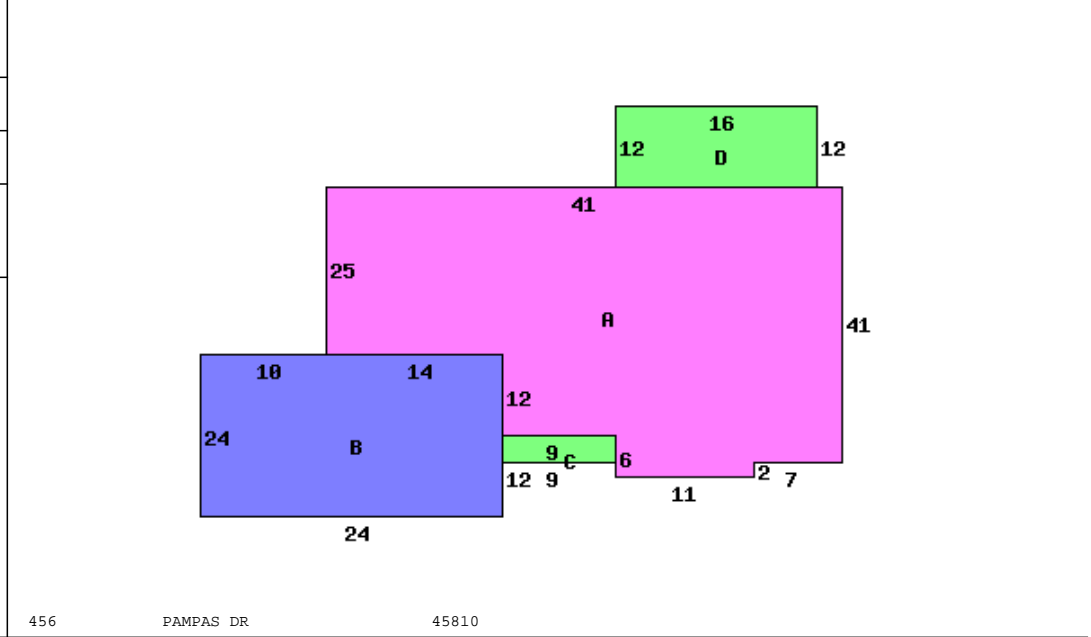

456 PAMPAS DR 45810

Occupancy	5 Condo	*DWELLING COMPUTATIONS
Story Height	1	Sq-Ft Value
Floor Level	Main	FRAME 1443 114080
Shingle	Subtotal	114080
	Roof	GABLE
Plaster/Drywall	D	Air Conditioning 2530
Floor/Hardwood	X	Plumbing 2100
Floor/Tile-Lino	X	Garages and Carports 16730
Number of Rooms	6	Extra Features 5620
Bedrooms	3	Total Value 141060
Central Heat	A	PUB PAVED ST/RD
FORCED AIR		
Heat Pump	A	Neighborhood:
Central A/C	A	Code: 2550
Plumbing		Dwl/Gar/NC% 1.3800
Standard	1	
Extra 3 Fixture	1	

Bldg Type	SHB+Cons	DixHt	Unit	Blt/Renov	Replace	Phy Fnc	True
1 DWELLING	1 F/C			Grade	Cond	Dpr Dpr	Value
		1443		C+	2006AV	.16	179870
site value	acres/	effective	depth	actual	effective	extended	true
	frontage	frontage	depth	rate	rate	value	value
			factor				30000