

LIBERTY TWP
ADA CORP

00240

Hardin County, Ohio
Michael T. Bacon, Auditor

25-200141.0000
I142

RES
2025

sale

2022 HUPE JASON M & JAYMA	2021-08-10
2023 HUPE JASON M & JAYMA	2021-08-10
2024 HUPE JASON M & JAYMA	2021-08-10
2025 HUPE JASON M & JAYMA KU	2021-08-10 HAYS SUB PHASE III LOT 34
1030 BEECH ST	1SD
ADA OH 45810	\$265,000

Eff Rate:-	47.64	41.58	41.81	42.27	a/r
Tax Year	2022	2023	2024	2025	2025
Prop Cls	510	510	510	510	510
Acres					
Land100%	33710	32110	32110	32110	32100
Bldg100%	237370	248110	248110	248110	248110
Totl100%	271090t	280230t	280230t	280230t	280210t
Cauv100%					
Tax Value:					
Land 35%	11800	11240	11240	11240	11240
Bldg 35%	83080	86840	86840	86840	86840
Totl 35%	94880t	98080t	98080t	98080t	98080t
Hmstd35%					
Owner Oc	88.06	84.18	83.76	83.64	84.14
Hmstd RB					
Net Tax	4080.18	3657.20	3682.84	3702.54	3724.82
Sp-Asmnt	95.16	97.56	94.56	97.56	

Orig Tax Year 1997
Parent: 25-200084.0000

SHB+ 1 B	CON	TYPE	FACT	SQ-FT	VALUE	a	*MAIN
	F	M		2248			
	OFF	P		139	4170	b	PORCH
	G	P		676	18930	c	GRAGE
	OH	P		12	460	d	PORCH
	OH	P		7	270	e	PORCH
	OH	P		14	530	f	PORCH
	PAT	P		234	700	g	PORCH

gas fireplace							
Sale#	#p	sale date	To	Type/Invalid?	Sale\$	co:land	co:blgd
403	1	2021-08-10	HUPE JASON M & JAYMA KUHL	1SD	265000	33710	237370
141	1	2015-04-06	HULL TRAVIS K & SAMANTHA	1WD	247500	22510	199940
162	1	2014-05-01	PATTON CATHY L	1WD	245000	22510	199940
22	1	1997-01-13	MCCURDY ROBERT W & MYRNA	1WD	222632	0	0
572	1	1996-09-16	GUYTON BUILDERS	1WD	22000	0	0
Year	Land	Bldg	Total	Net Tax			
2021	11800	83080	94880	4483.68			
2020	11800	83080	94880	4550.08			

project				ben acres	/	%	factor
107	GRASS RUN #933 - HOG CREEK	XA/2025					
500	HARDIN COUNTY LANDFILL	XA/2025					
110	HOG CREEK MAINLINE - HOG CR.	XA/2025					
598	ADA LIGHTS	XV/2025					
577	OTTAWA RIVER PROJECT MAINT	XA/2021					

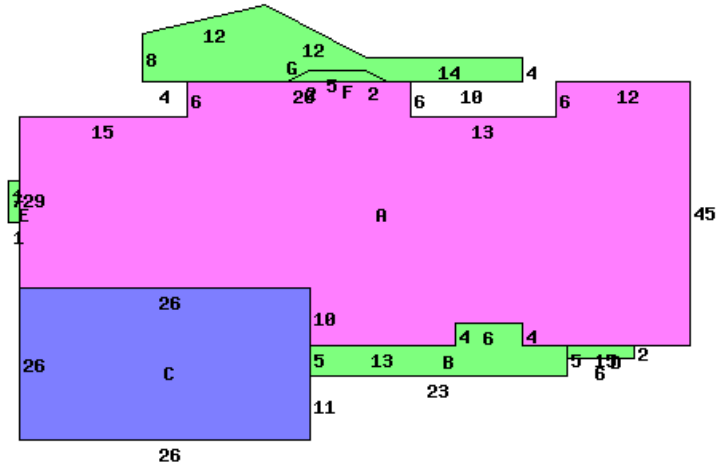

1030 BEECH ST 45810

Occupancy 1 Single Family	*DWELLING COMPUTATIONS	
Story Height 1	Sq-Ft	Value
Floor Level		
Main	FRAME	2248 150500
Basement		1440 26650
Subtotal		177150
Shingle	Roof	GABLE
B 1 2 U A		
Plaster/Drywall	D	Air Conditioning 3930
Unfinished Wall	X	Plumbing 4200
Floor/Hardwood	X	Garages and Carports 18930
Floor/Carpet	X	Extra Features 8650
Floor/Concrete	X	Total Value 212860
Floor/Tile-Lino	X	
Number of Rooms	1 7	PUB PAVED ST/RD
Bedrooms	3	
Central Heat	A	Neighborhood:
FORCED AIR		Code: 2540
Central A/C	A	Dwl/Gar/NC% 1.2100
Plumbing		
Standard	1	
Extra 3 Fixture	1	
Extra 2 Fixture	1	
Extra Fixture	1	

Bldg Type	SHB+Cons	DixHt	Unit	Blt/Renov	Replace	Phy Dpr	Fnc Dpr	True Value
1 DWELLING	1 B F			B	1996GD	.22	.05	248110
front lot	acres/ frontage	effective	depth	actual	effective	extended	true	value
	100.00	173	107	300	321	32100	32100	