

LIBERTY TWP
ADA CORP

00240

Hardin County, Ohio
Michael T. Bacon, Auditor

25-200038.0000
I34

RES
2025

sale

Eff Rate:- 47.64 — 41.58 — 41.81 — 42.27 — a/r

| | |
|----------------------------|-------------------------------------|
| 2022 NAGEL VICTORIA & JOHN | 2019-05-06 |
| 2023 NAGEL VICTORIA & JOHN | 2019-05-06 |
| 2024 NAGEL VICTORIA & JOHN | 2019-05-06 |
| 2025 NAGEL VICTORIA & JOHN | 2019-05-06 |
| 322 WILLEKE AVE | 2019-05-06 HANSONS SUB E PT 100X175 |
| | LSD 518 |
| ADA OH 45810 | \$165,000 |

| | | | | | | |
|------------|---------|---------|---------|---------|---------|---------|
| Tax Year | 2022 | 2023 | 2024 | 2025 | 2025 | CAMA |
| Prop Cls | 510 | 510 | 510 | 510 | 510 | 510 |
| Acres | | | | | | |
| Land100% | 23800 | 25000 | 25000 | 25000 | 25000 | 24990 |
| Bldg100% | 120200 | 152690 | 152690 | 152690 | 152690 | 152680 |
| Totl100% | 144000t | 177690t | 177690t | 177690t | 177690t | 177670t |
| Cauv100% | | | | | | |
| Tax Value: | | | | | | |
| Land 35% | 8330 | 8750 | 8750 | 8750 | 8750 | 8750 |
| Bldg 35% | 42070 | 53440 | 53440 | 53440 | 53440 | 53440 |
| Totl 35% | 50400t | 62190t | 62190t | 62190t | 62190t | 62180t |
| Hmstd35% | | | | | | |
| Owner Oc | | | | 53.04 | 53.36 | |
| Hmstd RB | | | | | | |
| Net Tax | 2214.16 | 2372.32 | 2388.30 | 2347.68 | 2361.80 | |
| Sp-Asmnt | 61.80 | 70.64 | 67.64 | 70.64 | | |

| | | | | | | | |
|------|-----|------|------|-------|-------|---|-------|
| SHB+ | CON | TYPE | FACT | SQ-FT | VALUE | a | *MAIN |
| 1 B | B | M | | 1516 | | | |
| | OPF | P | | 243 | 7290 | b | PORCH |
| | BZ | G | | 584 | 16350 | c | GRAGE |
| 1 | F/C | A | | 480 | | d | ADDTN |
| | DK | P | | 114 | 1710 | e | PORCH |
| | PAT | P | | 446 | 1340 | f | PORCH |

| Sale# | #p | sale date | To | Type/Invalid? | Sale\$ | co:land | co:blgd |
|-------|------|------------|---------------------------|---------------|--------|---------|---------|
| 178 | 1 | 2019-05-06 | NAGEL VICTORIA & JOHN | LSD | 165000 | 22690 | 106400 |
| 207 | 1 | 2017-05-05 | MARTINEZ DAVID & CHRISTIN | LSD | 158000 | 12510 | 105170 |
| 469 | 1 | 2010-10-12 | WINEGARDNER GREGORY A | LWD | 123000 | 13260 | 136140 |
| 693 | 1 | 2003-11-24 | MOSEY ROBIN A | LWD | 132500 | 11340 | 107830 |
| 389 | 1 | 1994-05-10 | ROIDER RUTH M | LWD | 83000 | 0 | 81800 |
| 553 | 1 | 1991-07-16 | | LUN * | 81000 | 0 | 69400 |
| 746 | 1 | 1990-09-19 | | LUN * | 0 | 0 | 69400 |
| 626 | 1 | 1988-08-08 | | LWD | 70000 | 0 | 69400 |
| Year | Land | Bldg | Total | Net Tax | | | |
| 2021 | 8330 | 42070 | 50400 | 2437.50 | | | |
| 2020 | 8330 | 42070 | 50400 | 2473.70 | | | |

| project | ben acres | / | % | factor |
|----------------------------------|-----------|---|---|---------|
| 107 GRASS RUN #933 - HOG CREEK | | | | XA/2025 |
| 500 HARDIN COUNTY LANDFILL | | | | XA/2025 |
| 110 HOG CREEK MAINLINE - HOG CR. | | | | XA/2025 |
| 598 ADA LIGHTS | | | | XV/2025 |
| 577 OTTAWA RIVER PROJECT MAINT | | | | XA/2021 |

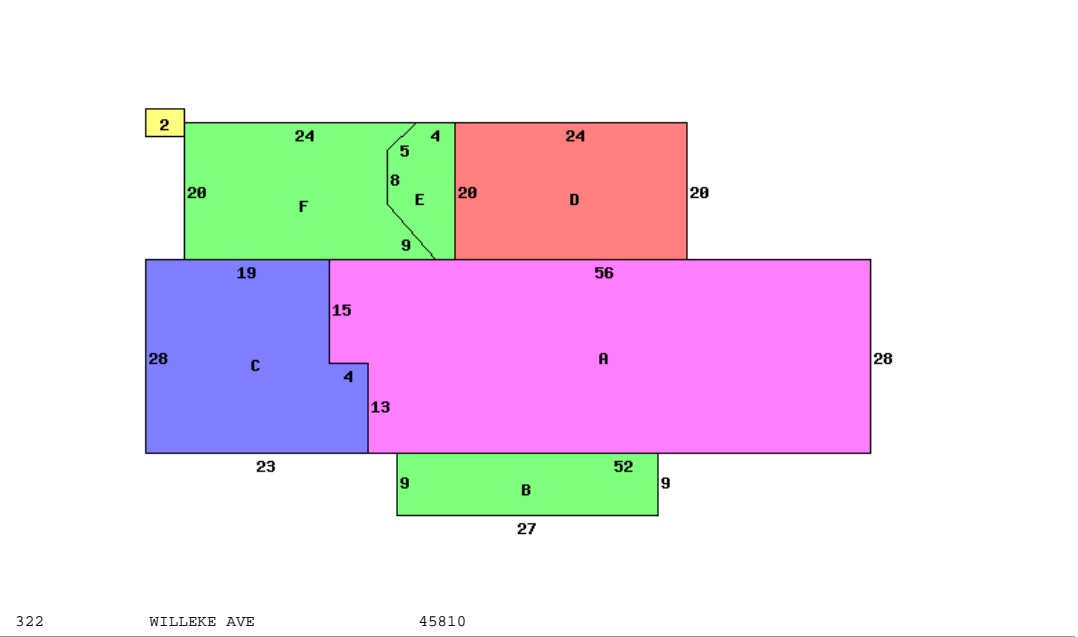

322 WILLEKE AVE 45810

| Occupancy 1 Single Family | | *DWELLING COMPUTATIONS | |
|---------------------------|-----------|------------------------|-------------|
| Story Height | 1 | Sq-Ft | Value |
| Floor Level | Main | BRICK | 1996 151360 |
| | Basement | | 1516 28050 |
| | Subtotal | | 179410 |
| Shingle | Roof | GABLE | |
| | B 1 2 U A | | |
| Plaster/Drywall | X | Air Conditioning | 3530 |
| Panelled Wall | X | Plumbing | 4200 |
| Unfinished Wall | X | Garages and Carports | 16350 |
| Floor/Hardwood | X | Extra Features | 10340 |
| Floor/Carpet | X | Total Value | 213830 |
| Floor/Concrete | X | | |
| Floor/Tile-Lino | X | PUB PAVED ST/RD | |
| Number of Rooms | 1 6 | | |
| Bedrooms | 3 | Neighborhood: | |
| | | Code: | 2520 |
| Central Heat | A | Dwl/Gar/NC% | 1.1900 |
| ELECTRIC | | | |
| Heat Pump | A | | |
| Central A/C | A | | |
| Plumbing | | | |
| Standard | 1 | | |
| Extra 3 Fixture | 2 | | |

| Bldg Type | SHB+Cons | DixHt | Unit | Blt/Renov | Replace | Phy | Fnc | True |
|------------|----------|-----------|-------|-----------|-----------|----------|-------|--------|
| 1 DWELLING | 1 B B | 1996 | Area | Grade | Cond | Value | Dpr | Value |
| 2 Shed | *PP F | 10X10 | 100 | C | 1966AV | 213830 | .40 | 152680 |
| | | | | | 2000AV | 0 | | 0 |
| front lot | acres/ | effective | depth | actual | effective | extended | true | |
| | 105.0000 | 105.00 | 175 | 108 | 220 | 238 | 24990 | 24990 |

| | | | |
|------------|----------------------------|---------|-------------------------|
| Call Back: | Sign: PSN Date: 2015-09-30 | Lister: | 25-200038.0000-v082020R |
|------------|----------------------------|---------|-------------------------|