

LIBERTY TWP
ADA CORP

00240

Hardin County, Ohio
Michael T. Bacon, Auditor

25-200032.0000
I54

RES
2023

sale

Eff Rate:- 53.58 — 52.79 — 47.64 — 41.58 — a/r

2020 MCVVEY IAN M	2019-08-09	
2021 MCVVEY IAN M	2019-08-09	
2022 MCVVEY IAN M	2019-08-09	
2023 MCVVEY IAN M	2019-08-09	HANSONS SUB PT 18 .40A
325 E LIMA AVE	LWD	
ADA OH 45810	\$144,900	01.1-01-20-032

Tax Year	2020	2021	2022	2023	CAMA
Prop Cls	511	511	511	511	511
Acres	.4000	.4000	.4000	.4000	
Land100%	22690	22690	22690	23800	23800
Bldg100%	137230	137230	137230	168170	168170
Totl100%	159910t	159910t	159910t	191970t	191970t
Cauvl00%					
Tax Value:					
Land 35%	7940	7940	7940	8330	8330
Bldg 35%	48030	48030	48030	58860	58860
Totl 35%	55970t	55970t	55970t	67190t	67190t
Hmstd35%					
Owner Oc	62.98	61.94	51.96	57.68	
Hmstd RB					
Net Tax	2684.10	2644.94	2406.88	2505.38	
Sp-Asmnt	65.98	67.98	65.98	74.40	

SHB+	CON	TYPE	FACT	SQ-FT	VALUE	
1 B	B	M		1741		a *MAIN
	OPF	P		145	4350	b PORCH
	B2	G		546	15290	c GRAGE
1	OPF	P		310	9300	d PORCH
	F/C	A		136		e ADDTN

Sale#	#p	sale date	To	Type/Invalid?	Sale\$	co:land	co:bldg
335	1	2019-08-09	MCVEY IAN M	LWD	144900	21600	121830
277	1	2019-08-09	KRUMMREY LARRY R & ANTHON	LAF	0	21600	121830
62	1	2006-02-07	KRUMMREY ARTHUR A TRUSTE	LQC	0	11890	131540
387	1	2005-10-12	KRUMMREY ELIZABETH A TRU	LWD	0	10800	104090
262	1	1989-04-07		LWD	91250	0	81630
229	0	1988-03-31		*	0	0	81630

Year	Land	Bldg	Total	Net Tax
2019	7560	42640	50200	1961.18
2018	7560	42640	50200	1917.22

project	ben acres	/ %	factor
107 GRASS RUN #933 - HOG CREEK			XA/2023
500 HARDIN COUNTY LANDFILL			XA/2023
110 HOG CREEK MAINLINE - HOG CR.			XA/2023
598 ADA LIGHTS			XV/2023
577 OTTAWA RIVER PROJECT MAINT			XA/2021

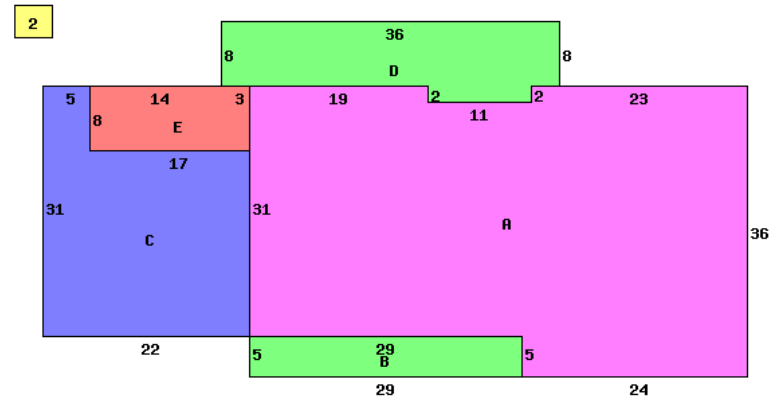

325 E LIMA AVE 45810

Occupancy	1 Single Family	*DWELLING COMPUTATIONS
Story Height	1	Sq-Ft Value
Floor Level	Main	BRICK 1877 146220
	Basement	1741 32210
	Subtotal	178430
Shingle	Roof	HIP
	B 1 2 U A	
Plaster/Drywall	X	870 sq ft Basement Finish 9440
Panelled Wall	X	Fireplaces 4000
Unfinished Wall	X	Plumbing 3500
Floor/Pine	X	Garages and Carports 15290
Floor/Carpet	X X	Extra Features 13650
Floor/Concrete	X	Total Value 224310
Number of Rooms	4 6	
Bedrooms	3	PUB PAVED ST/RD
Fireplace		Neighborhood:
Openings	2	Code: 2520
Stacks	1	Dwl/Gar/NC% 1.1900
Central Heat	A	
ELECTRIC		
Plumbing		
Standard	1	
Extra 3 Fixture	1	
Extra 2 Fixture	1	

Bldg Type	SHB+Cons	DixHt	Unit	Blt/Renov	Replace	Phy	Fnc	True
1 DWELLING	1 B B	FtxFt	Area	Grade	Cond	Dpr	Dpr	Value
2 Shed	*PP 0	8X10	2747	C	1961GD	.37		168170
			80		OLD/	0		0
front lot	acres/	effective	depth	actual	effective	extended	true	
	frontage	frontage	depth	factor	rate	value	value	
	100.0000	100.00	175	108	220	23800	23800	

Plaster/Drywall	X	870 sq ft	Basement Finish	9440
Panelled Wall	X		Fireplaces	4000
Unfinished Wall	X		Plumbing	3500
Floor/Pine	X		Garages and Carports	15290
Floor/Carpet	X X		Extra Features	13650
Floor/Concrete	X		Total Value	224310
Number of Rooms	4 6			
Bedrooms	3		PUB PAVED ST/RD	
Fireplace			Neighborhood:	
Openings	2		Code:	2520
Stacks	1		Dwl/Gar/NC%	1.1900
Central Heat	A			
ELECTRIC				
Plumbing				
Standard	1			
Extra 3 Fixture	1			
Extra 2 Fixture	1			

Call Back:

Sign: PSN Date: 2015-09-30 Lister:

25-200032.0000-v082020R