

LIBERTY TWP
ADA CORP

00240

Hardin County, Ohio
Michael T. Bacon, Auditor

25-170003.0000
L38

RES
2025

sale

2022 MCKEE JAMES D & JEANN
2023 MCKEE JAMES D & JEANN
2024 MCKEE JAMES D & JEANN
2025 MCKEE JAMES D & JEANNE
315 E MONTFORD AVE
ADA OH 45810

JOHNSONS E 3

\$0

Eff Rate:-	47.64	41.58	41.81	42.27	a/r	
Tax Year	2022	2023	2024	2025	2025	CAMA
Prop Cls	510	510	510	510	510	510
Acres						
Land100%	7570	7800	7800	7800	7800	7800
Bldg100%	52460	64770	64770	64770	64770	64770
Totl100%	60030t	72570t	72570t	72570t	72570t	72570t
Cauv100%						
Tax Value:						
Land 35%	2650	2730	2730	2730	2730	2730
Bldg 35%	18360	22670	22670	22670	22670	22670
Totl 35%	21010t	25400t	25400t	25400t	25400t	25400t
Hmstd35%						
Owner Oc	19.50	21.80	21.70	21.66	21.80	
Hmstd RB	376.24	341.94	367.90	383.12	385.40	
Net Tax	527.26	605.18	585.86	575.74	579.22	
Sp-Asmnt	39.76	43.05	40.05	43.05		

SHB+	CONS	TYPE	FACT	SQ-FT	VALUE	a	*MAIN
1	F/C	M		1032			
	OFF	P		112	3360	b	PORCH
	F	G		325	7800	c	GRAGE
1	CARL	G		286	2240	d	GRAGE
	F/C	A		447		e	ADDTN
	DK	P		240	3600	f	PORCH

Year	Land	Bldg	Total	Net Tax
2021	2650	18360	21010	992.86
2020	2650	18360	21010	1007.56

project	ben acres	%	factor
107 GRASS RUN #933 - HOG CREEK			XA/2025
500 HARDIN COUNTY LANDFILL			XA/2025
110 HOG CREEK MAINLINE - HOG CR.			XA/2025
598 ADA LIGHTS			XV/2025
577 OTTAWA RIVER PROJECT MAINT			XA/2021

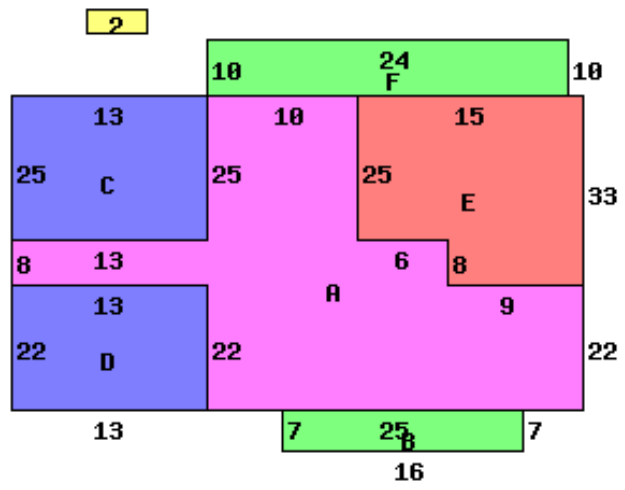

315 E MONTFORD ST 45810

Occupancy 1 Single Family	*DWELLING COMPUTATIONS	
Story Height 1	Sq-Ft	Value
Floor Level	1479	116410
Shingle	Main Subtotal	116410
	Roof	
Plaster/Drywall	D	Garages and Carports 10040
Panelled Wall	X	Extra Features 6960
Floor/Carpet	X	Total Value 133410
Floor/Tile-Lino	L	
Number of Rooms	6	PUB SIDEWALK
Bedrooms	2	
Central Heat	A	Neighborhood:
FORCED AIR		Code: 2500
Plumbing		Dwl/Gar/NC% 1.1900
Standard	1	

Bldg Type	SHB+Cons	DixHt	Unit	Blt/Renov	Replace	Phy Dpr	Fnc Dpr	True Value
1 DWELLING	1 F/C	1479		D+	OLD/GD	.40	.20	64770
2 Shed	*PP	6X8	48		OLD/			0
front lot	acres/ frontage	effective frontage	depth	actual factor	effective rate	extended value	true value	
	60.00	150	100	130	130	7800	7800	