

LIBERTY TWP  
ADA CORP

00240

Hardin County, Ohio  
Michael T. Bacon, Auditor

25-160140.0000  
A40

RES  
2025

sale

Eff Rate:- 47.64 — 41.58 — 41.81 — 42.27 — a/r

2022 WINEGARDNER ZACHARY A	2018-08-13
2023 WINEGARDNER ZACHARY A	2018-08-13
2024 WINEGARDNER ZACHARY A	2018-08-13
2025 WINEGARDNER ZACHARY A	2018-08-13 S-S 1-2
203 E NORTH ST	1WD
ADA OH 45810	\$139,000

Tax Year	2022	2023	2024	2025	2025	CAMA
Prop Cls	510	510	510	510	510	510
Acres	9660	10000	10000	10000	10000	10000
Land100%	118630	139460	139460	139460	139460	139460
Bldg100%	128290t	149460t	149460t	149460t	149460t	149460t
Totl100%						
Cauvl00%						

Orig Tax Year 2006  
Parent: 25-160041.0000

Tax Value:	3380	3500	3500	3500	3500	3500
Land 35%	41520	48810	48810	48810	48810	48810
Bldg 35%	44900t	52310t	52310t	52310t	52310t	52310t
Totl 35%						
Hmstd35%						
Owner Oc						
Hmstd RB						
Net Tax	1972.52	1995.44	2008.86	2019.32	2031.46	
Sp-Asmnt	63.68	69.24	63.24	69.24		

SHB+	CONS	TYPE	FACT	SQ-FT	VALUE	a	*MAIN
1	F	M		1416			
	PAT	P		120	360	b	PORCH
	F	G		506	12140	c	GRAGE
	OFF	P		138	4140	d	PORCH

#: 141 L/W  
251601410000

Sale#	#p	sale date	To	Type/Invalid?	Sale\$	co:land	co:bldg
393	1	2018-08-13	WINEGARDNER ZACHARY A	1WD	139000	9200	105540
224	1	2017-05-17	SHEPHERD EDWARD & CHARLOT	1FD	125000	8910	116140
795	2	2005-12-01	CONLEY ALVENA I	2WD	130000	0	0

Year	Land	Bldg	Total	Net Tax
2021	3380	41520	44900	2171.52
2020	3380	41520	44900	2203.74

project	ben acres	/ %	factor
500 HARDIN COUNTY LANDFILL			XA/2025
107 GRASS RUN #933 - HOG CREEK			XA/2025
598 ADA LIGHTS			XV/2025
110 HOG CREEK MAINLINE - HOG CR.			XA/2025
577 OTTAWA RIVER PROJECT MAINT			XA/2021

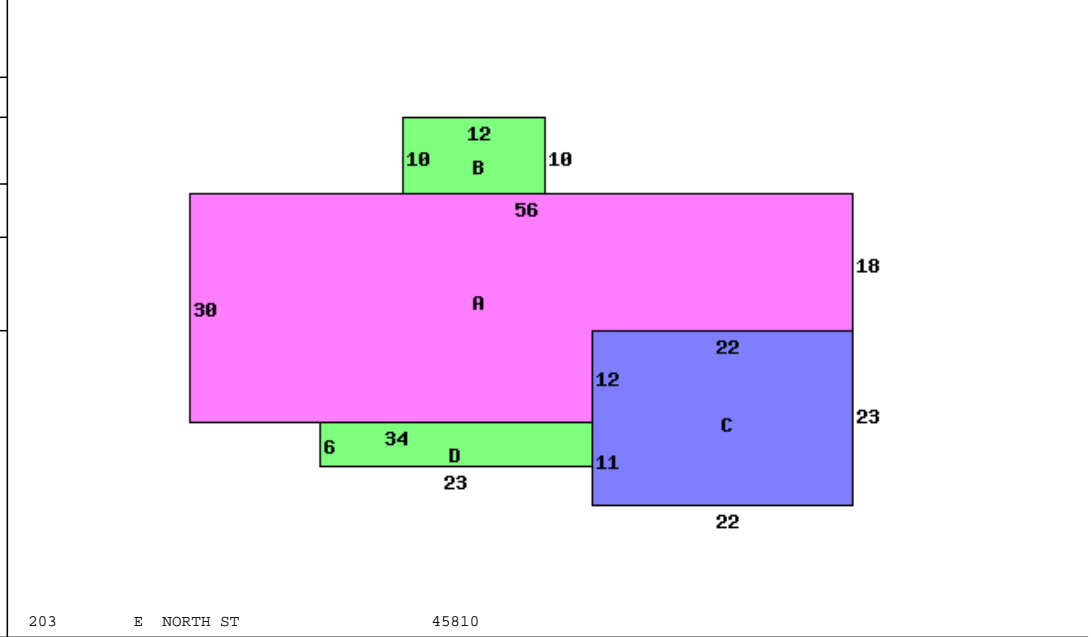

Occupancy 1 Single Family	*DWELLING COMPUTATIONS	
Story Height 1	Sq-Ft	Value
Floor Level	1416	111950
Shingle	Subtotal	111950
	B 1 2 U A	
Plaster/Drywall	D	Air Conditioning 2480
Floor/Carpet	X	Plumbing 2100
Floor/Tile-Lino	X	Garages and Carports 12140
Number of Rooms	6	Extra Features 4500
Bedrooms	3	Total Value 133170
Central Heat	A	PUB PAVED ST/RD
FORCED AIR		
Central A/C	A	Neighborhood:
Plumbing		Code: 2500
Standard	1	Dwl/Gar/NC% 1.1900
Extra 3 Fixture	1	

Bldg Type	SHB+Cons	DixHt	Unit	Blt/Renov	Replace	Phy Fnc	True
1 DWELLING	1 F			C	2005VG	.12	139460
	1416				133170		
front lot	effective	depth	depth	actual	effective	extended	true
	100.00	89	77	130	100	10000	10000

Call Back:

Sign: PSN Date: 2015-09-10 Lister:

25-160140.0000-v082020R