

LIBERTY TWP  
ADA CORP

00240

Hardin County, Ohio  
Michael T. Bacon, Auditor

25-160026.0000  
A26

RES  
2025

sale

Eff Rate:- 47.64 — 41.58 — 41.81 — 42.27 — a/r

2022 LUDANYI JULIANNA R	1998-05-27
2023 LUDANYI JULIANNA R	1998-05-27
2024 LUDANYI JULIANNA R	1998-05-27
2025 LUDANYI JULIANNA R	1998-05-27 MOWANS 6
423 N JOHNSON ST	1QC
ADA OH 45810	\$0

Tax Year	2022	2023	2024	2025	2025	CAMA
Prop Cls	510	510	510	510	510	510
Acres	6890	7110	7110	7110	7110	7100
Land100%	73510	98230	98230	98230	98230	98220
Bldg100%	80400t	105340t	105340t	105340t	105340t	105320t
Totl100%						
Cauv100%						
Tax Value:						
Land 35%	2410	2490	2490	2490	2490	2490
Bldg 35%	25730	34380	34380	34380	34380	34380
Totl 35%	28140t	36870t	36870t	36870t	36870t	36860t
Hmstd35%	28030	36710	36710	36710	36710	
Owner Oc	26.02	31.52	31.36	31.30	31.50	hmstd 2490 l 34220 b
Hmstd RB						
Net Tax	1210.22	1374.94	1384.58	1391.98	1400.34	
Sp-Asmnt	45.11	51.66	48.66	51.66		

SHB+ 1HB	CONS F	TYPE M	FACT	SQ-FT 1034	VALUE	a	*MAIN
1 B	RFX	P		75	750	b	PORCH
1	F/C	A		276		c	ADDTN
	STP	P		288		d	ADDTN
	FFP	P		75	300	e	PORCH
				163	6520	f	PORCH

Sale# 249	#p 1	sale date 1998-05-27	To LUDANYI JULIANNA R	Type/Invalid? 1QC *	Sale\$ 0	co:land 6000	co:blgd 43940
Year 2021	Land 2410	Bldg 25730	Total 28140	Net Tax 1329.92			
2020	2410	25730	28140	1349.60			

project	ben acres	/ %	factor
107 GRASS RUN #933 - HOG CREEK			XA/2025
500 HARDIN COUNTY LANDFILL			XA/2025
110 HOG CREEK MAINLINE - HOG CR.			XA/2025
598 ADA LIGHTS			XV/2025
577 OTTAWA RIVER PROJECT MAINT			XA/2021

2

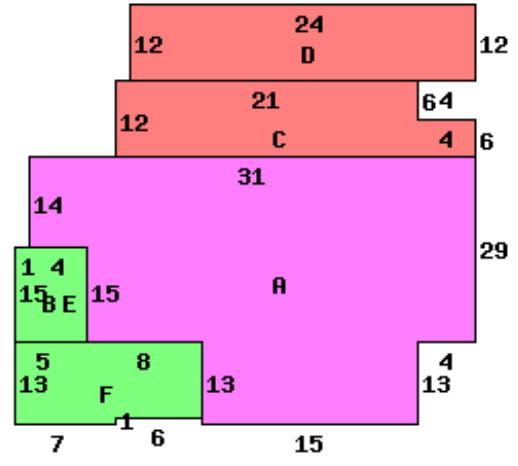

423 N JOHNSON ST 45810

Occupancy 1 Single Family	*DWELLING COMPUTATIONS
Story Height 1T	Sq-Ft Value
Floor Level	
Main	FRAME 1598 125560
Part Upper	FRAME 1034 38580
Basement	195 4110
Subtotal	168250
Shingle	Roof GABLE
Plaster/Drywall	X X Air Conditioning 4640
Unfinished Wall	X Plumbing 2100
Floor/Hardwood	X X Extra Features 7570
Floor/Carpet	X X Total Value 182560
Floor/Tile-Lino	T
Number of Rooms	1 7 4 PUB PAVED ST/RD
Bedrooms	3 PUB SIDEWALK
Central Heat	A Neighborhood:
F-A/ELECT	Code: 2500
Central A/C	A Dwl/Gar/NC% 1.1900
Plumbing	
Standard	1
Extra 3 Fixture	1

Bldg Type	SHB+Cons	DixHt	Unit	Blt/Renov	Replace	Phy	Fnc	True	
1 DWELLING	1HB F	2632	Rate	Cond	Value	Dpr	Dpr	Value	
2 Flat Barn		20X24	480	D	OLD/AV	182560	.55	97760	
				D	OLD/AV	4610	.80	.50	460
front lot	50.0000	50.00	180	109	130	142	7100	7100	