

LIBERTY TWP
ADA CORP

00240

Hardin County, Ohio
Michael T. Bacon, Auditor

25-140079.0000
D14.03

RES
2025

sale

Eff Rate:- 47.64 — 41.58 — 41.81 — 42.27 — a/r

2022 NSIA PEPRA KOFI	2018-02-27
2023 NSIA PEPRA KOFI	2018-02-27
2024 NSIA PEPRA KOFI	2018-02-27
2025 NSIA PEPRA KOFI	2018-02-27
712 AUTUMN DR	2018-02-27 OLD ORCHARD CONDO UNIT 11
ADA OH 45810	1WD
	\$166,600

Tax Year	2022	2023	2024	2025	2025	CAMA
Prop Cls	550	550	550	550	550	550
Acres						
Land100%	10000	20000	20000	20000	20000	20000
Bldg100%	141030	151370	151370	151370	151370	151370
Totl100%	151030t	171370t	171370t	171370t	171370t	171370t
Cauv100%						
Tax Value:						
Land 35%	3500	7000	7000	7000	7000	7000
Bldg 35%	49360	52980	52980	52980	52980	52980
Totl 35%	52860t	59980t	59980t	59980t	59980t	59980t
Hmstd35%						
Owner Oc						
Hmstd RB						
Net Tax	2322.24	2288.02	2303.42	2315.40	2329.34	
Sp-Asmnt	42.66	48.00	45.00	48.00		

Orig Tax Year 2019
Parent: 25-140058.0000

SHB+	CONS	TYPE	FACT	SQ-FT	VALUE			
1	F	M		1494		a	*MAIN	
	PAT	P		110	330	b	PORCH	
	F	G		420	10080	c	GRAGE	
Sale#	#p	sale date	To	NSIA	PEPRA	KOFI	Type/Invalid?	Sale\$
72	1	2018-02-27					1WD	166600
Year	Land	Bldg	Total	Net Tax				
2021	3500	49360	52860	2556.48				
2020	3500	49360	52860	2594.44				
p r o j e c t			ben acres		/ %		factor	
598 ADA LIGHTS					XV/2025			
110 HOG CREEK MAINLINE - HOG CR.					XA/2025			
577 OTTAWA RIVER PROJECT MAINT					XA/2021			

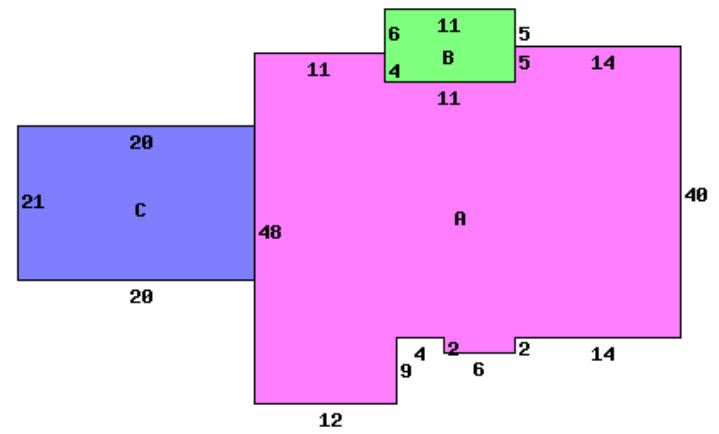

712 AUTUMN DR 45810

Occupancy 5 Condo	*DWELLING COMPUTATIONS	
Story Height 1	Sq-Ft	Value
Floor Level	1494	117590
Shingle	Subtotal	117590
	Main	FRAME
	Roof	GABLE
Plaster/Drywall	D	Air Conditioning
Floor/Hardwood	X	Plumbing
Floor/Carpet	X	Garages and Carports
Number of Rooms	5	Extra Features
Bedrooms	2	Total Value
Central Heat	A	PUB PAVED ST/RD
FORCED AIR		
Central A/C	A	Neighborhood:
Plumbing		Code:
Standard	1	Dwl/Gar/NC%
Extra 3 Fixture	1	2560
		1.0800

Bldg Type	SHB+Cons	DixHt	Area	Unit	Grade	Blt/Renov	Replace	Phy	Fnc	True
1 DWELLING	F	FtxFt	1494	Rate	C+	Cond	Value	Dpr	Dpr	Value
	acres/	effective	depth	actual	effective	extended	true			
site value	frontage	frontage	depth	rate	rate	value	value			
			factor	20000			20000			