

LIBERTY TWP
ADA CORP

00240

Hardin County, Ohio
Michael T. Bacon, Auditor

25-140079.0000
D14.03

RES
2025

sale

2022 NSIA PEPRA KOFI	2018-02-27
2023 NSIA PEPRA KOFI	2018-02-27
2024 NSIA PEPRA KOFI	2018-02-27
2025 NSIA PEPRA KOFI	2018-02-27 OLD ORCHARD CONDO UNIT 11
712 AUTUMN DR	1WD
ADA OH 45810	\$166,600

Eff Rate:-	47.64	41.58	41.81	42.27	a/r
Tax Year	2022	2023	2024	2025	2025
Prop Cls	550	550	550	550	550
Acres					
Land100%	10000	20000	20000	20000	20000
Bldg100%	141030	151370	151370	151370	151370
Totl100%	151030t	171370t	171370t	171370t	171370t
Cauvl00%					
Tax Value:					
Land 35%	3500	7000	7000	7000	7000
Bldg 35%	49360	52980	52980	52980	52980
Totl 35%	52860t	59980t	59980t	59980t	59980t
Hmstd35%					
Owner Oc					
Hmstd RB					
Net Tax	2322.24	2288.02	2303.42	2315.40	2329.34
Sp-Asmnt	42.66	48.00	45.00	48.00	

Orig Tax Year 2019
Parent: 25-140058.0000

SHB+	CONS	TYPE	FACT	SQ-FT	VALUE			
1	F	M		1494		a	*MAIN	
	PAT	P		110	330	b	PORCH	
	F	G		420	10080	c	GRAGE	
Sale#	#p	sale date	To	NSIA	PEPRA	KOFI	Type/Invalid?	Sale\$
72	1	2018-02-27					1WD	166600
Year	Land	Bldg	Total	Net Tax				
2021	3500	49360	52860	2556.48				
2020	3500	49360	52860	2594.44				
p r o j e c t				ben acres	/	%	factor	
598 ADA LIGHTS							XV/2025	
110 HOG CREEK MAINLINE - HOG CR.							XA/2025	
577 OTTAWA RIVER PROJECT MAINT							XA/2021	

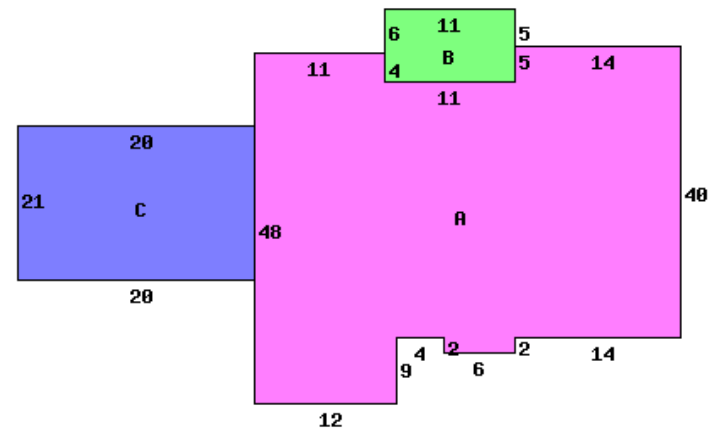

712 AUTUMN DR 45810

Occupancy 5 Condo		*DWELLING COMPUTATIONS
Story Height 1		Sq-Ft Value
Floor Level	Main	FRAME 1494 117590
Shingle	Subtotal	117590
	Roof	GABLE
Plaster/Drywall	D	Air Conditioning 2630
Floor/Hardwood	X	Plumbing 2100
Floor/Carpet	X	Garages and Carports 10080
Number of Rooms	5	Extra Features 330
Bedrooms	2	Total Value 132730
Central Heat	A	PUB PAVED ST/RD
FORCED AIR		
Central A/C	A	Neighborhood:
Plumbing		Code: 2560
Standard	1	Dwl/Gar/NC% 1.0800
Extra 3 Fixture	1	

Bldg Type	SHB+Cons	DixHt	Unit	Blt/Renov	Replace	Phy Fnc	True
1 DWELLING	F	FtxFt	Area	Grade	Value	Dpr Dpr	Value
		1494	1494	C+	2018AV	.04	151370
site value	acres/	effective	depth	actual	effective	extended	true
	frontage	frontage	factor	rate	rate	value	value
				20000			20000