

LIBERTY TWP
ADA CORP

00240

Hardin County, Ohio
Michael T. Bacon, Auditor

25-100061.0000
G89

COM
2023

sale

Eff Rate:- 57.34 — 56.60 — 51.26 — 48.36 — a/r

2020 ADA OHIO PROPERTIES L	2015-04-23
2021 ADA OHIO PROPERTIES L	2015-04-23
2022 ADA OHIO PROPERTIES L	2015-04-23
2023 ADA OHIO PROPERTIES LTD	2015-04-23 JOHNSONS 29
211 S MAIN ST	LWD
ADA OH 45810	\$95,000 01.1-01-10-061

Tax Year	2020	2021	2022	2023	CAMA
Prop Cls	401	401	401	401	401
Acres					
Land100%	15030	15030	15030	7430	7420
Bldg100%	86170	86170	86170	113460	113460
Totl100%	101200t	101200t	101200t	120890t	120880t
Cauvl00%					
Tax Value:					
Land 35%	5260	5260	5260	2600	2600
Bldg 35%	30160	30160	30160	39710	39710
Totl 35%	35420t	35420t	35420t	42310t	42310t
Hmstd35%					
Owner Oc					
Hmstd RB					
Net Tax	2030.92	2004.92	1815.52	2046.22	
Sp-Asmnt	104.58	106.58	104.58	109.74	

SHB+	CON	TYPE	FACT	SQ-FT	VALUE	a	*MAIN
2	F/C	M		1429			ADDTN
1	B/C	A		30			PORCH
	EFF	P		230	9200		PORCH
	OFF	P		635	19050		ADDTN
1	F/C	A		102			ADDTN
	EFF	P		15	600		PORCH
	STP	P		20	80		PORCH
	STP	P		35	140		PORCH

4 APTS							
Sale#	#p	sale date	To	Type/Invalid?	Sale\$	co:land	co:bldg
179	1	2015-04-23	ADA OHIO PROPERTIES LTD	LWD	95000	14310	43430
624	1	1996-10-04	KRAFT EDWIN M	LWD	82000	12600	39400
839	1	1993-09-16	GOSSARD MARLON P	LWD	70000	0	52000

Year	Land	Bldg	Total	Net Tax
2019	5010	30080	35090	2000.62
2018	5010	30080	35090	1969.88

project	ben acres	/ %	factor
107 GRASS RUN #933 - HOG CREEK			XA/2023
500 HARDIN COUNTY LANDFILL			XA/2023
110 HOG CREEK MAINLINE - HOG CR.			XA/2023
577 OTTAWA RIVER PROJECT MAINT			XA/2021
598 ADA LIGHTS			XV/2023

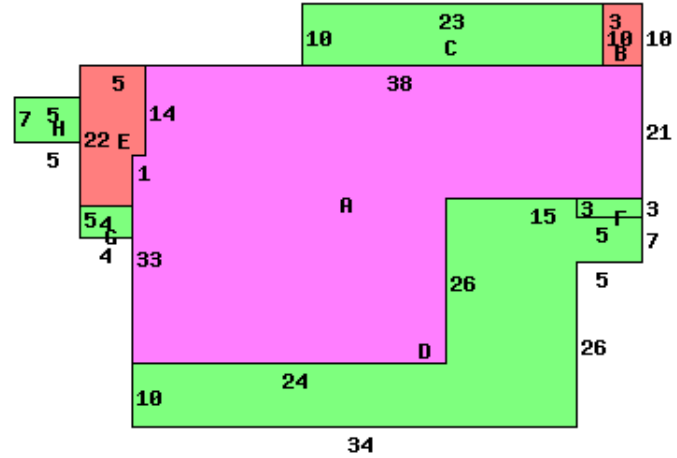

211 S MAIN ST 45810

Occupancy 1 Single Family	*DWELLING COMPUTATIONS	
Story Height 2	Sq-Ft	Value
Floor Level		
Main	FRAME	1561 122650
Full Upper	FRAME	1429 67850
Subtotal		190500
Metal	HIP	
B 1 2 U A		
Plaster/Drywall	X X	3 / Extra Living Units 10500
Floor/Hardwood	X X	Plumbing 6300
Floor/Pine	X	Extra Features 29070
Number of Rooms	9 4	Total Value 236370
Bedrooms	7	
Central Heat	A	PUB SIDEWALK
ELECTRIC		Neighborhood:
Plumbing		Code: 2500
Standard	1	Dwl/Gar/NC% 1.1900
Extra 3 Fixture	3	

Bldg Type	SHB+Cons	DixHt	Unit	Blt/Renov	Replace	Phy	Fnc	True
1 DWELLING	2 F/C	FtxFt	Area	Grade	Cond	Dpr	Dpr	Value
		2990		C	1900FR	283640	.50 .20	113460
	acres/	effective	depth	depth	effective	extended	value	true
front lot	frontage	frontage	factor	factor	rate	rate	value	value
		53.00	177	108	130	140	7420	7420