

LIBERTY TWP  
ADA CORP

00240

Hardin County, Ohio  
Michael T. Bacon, Auditor

25-100012.0000  
K07

COM  
2025

sale

Eff Rate:- 51.26 — 48.36 — 48.55 — 48.75 — a/r

2022 WYSS PATRICIA A	2002-05-14
2023 WYSS PATRICIA A	2002-05-14
2024 WYSS PATRICIA A	2002-05-14
2025 WYSS PATRICIA A	2002-05-14 LEHRS 2ND 1
214 W LINCOLN AVE	3WD
ADA OH 45810	\$300,000

Tax Year	2022	2023	2024	2025	2025	CAMA
Prop Cls	401	401	401	401	401	401
Acres	6310	6510	6510	6510	6510	6500
Land100%	262260	280570	280570	280570	280570	280560
Bldg100%	268570t	287090t	287090t	287090t	287090t	287060t
Totl100%						
Cauv100%						
Tax Value:						
Land 35%	2210	2280	2280	2280	2280	2280
Bldg 35%	91790	98200	98200	98200	98200	98200
Totl 35%	94000t	100480t	100480t	100480t	100480t	100470t
Hmstd35%						
Owner Oc						
Hmstd RB						
Net Tax	4818.18	4859.46	4878.84	4888.54	4898.82	
Sp-Asmnt	112.50	117.36	114.36	117.36		

SHB+	CONS	TYPE	FACT	SQ-FT	VALUE	
2	F/C	X		2168		a OTHER
	OFF	X		120		b OTHER
1	F/C	X		196		c OTHER
	OFF	X		120		d OTHER
	OFF	X		96		e OTHER
1	F	X		196		f OTHER

Sale#	#p	sale date	To	Type/Invalid?	Sale\$	co:land	co:blgd
233	3	2002-05-14	WYSS PATRICIA A	3WD	300000	4000	28310
548	0	1988-07-20		*	10000	0	18200
414	0	1988-06-06		*	0	0	18200

Year	Land	Bldg	Total	Net Tax
2021	2210	91790	94000	5320.76
2020	2210	91790	94000	5389.78

Project	ben acres	/ %	factor
107 GRASS RUN #933 - HOG CREEK			XA/2025
110 HOG CREEK MAINLINE - HOG CR.			XA/2025
500 HARDIN COUNTY LANDFILL			XA/2025
598 ADA LIGHTS			XV/2025
577 OTTAWA RIVER PROJECT MAINT			XA/2021

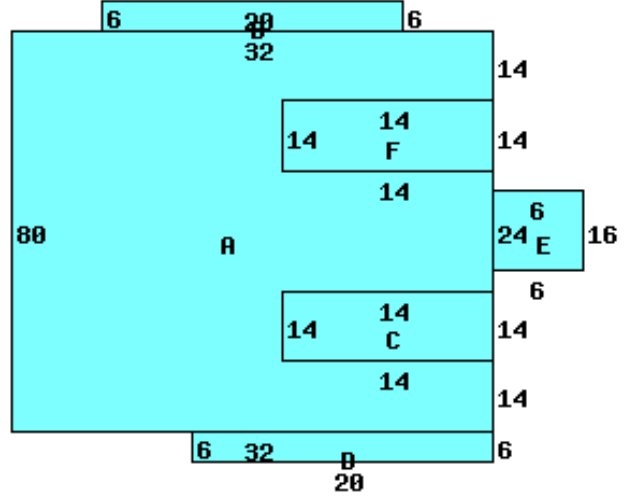

214 W LINCOLN AVE 45810

Occupancy 1 Single Family	*DWELLING COMPUTATIONS	Sq-Ft	Value
Story Height 2			
Floor Level	Full Upper FRAME	2168	87850
Shingle	Roof GABLE		87850
B 1 2 U A			
Plaster/Drywall	D D	Heating	-2470
Floor/Hardwood	X X	Plumbing	-3800
Floor/Pine	X X	Total Value	81580
Number of Rooms	5 4		
Bedrooms	2 3		
		PUB PAVED ST/RD	
		PUB SIDEWALK	
		Neighborhood:	
		Code:	2500
		Dwl/Gar/NC%	1.1900

Bldg Type	SHB+Cons	DixHt	Area	Unit	Grade	Blt/Renov	Replace	Phy	Fnc	True
1 APT	2 F/C	FtxFt	4728	63.80	C	2013AV	301650	.10	Dpr	271490
2 P	OFF		120	30.00	C	2013AV	3600	.10	Dpr	3240
3 P	OFF		96	30.00	C	2013AV	2880	.10	Dpr	2590
4 P	OFF		120	30.00	C	2013AV	3600	.10	Dpr	3240
front lot		effective	50.00	150	100	130	130	6500	6500	