

LIBERTY TWP
ADA CORP

00240

Hardin County, Ohio
Michael T. Bacon, Auditor

25-060049.0000
N71

RES
2025

sale

2022	SHORT MICHAEL L & REB	2017-06-12			
2023	SHORT MICHAEL L & REB	2017-06-12			
2024	SHORT MICHAEL L & REB	2017-06-12			
2025	SHORT MICHAEL L & REBEC 202 E DOBBINS AVE	2017-06-12	AHLEFELDS 2ND 46	1SD	\$114,500
	ADA OH 45810				

Eff Rate:-	47.64	41.58	41.81	42.27	a/r	
Tax Year	2022	2023	2024	2025	2025	CAMA
Prop Cls	510	510	510	510	510	510
Acres						
Land100%	6310	6510	6510	6510	6510	6500
Bldg100%	123540	118110	118110	118110	118110	118110
Totl100%	129860t	124630t	124630t	124630t	124630t	124610t
Cauv100%						
Tax Value:						
Land 35%	2210	2280	2280	2280	2280	2280
Bldg 35%	43240	41340	41340	41340	41340	41340
Totl 35%	45450t	43620t	43620t	43620t	43620t	43610t
Hmstd35%						
Owner Oc						
Hmstd RB						
Net Tax	1996.68	1663.94	1675.16	1683.86	1693.98	
Sp-Asmnt	58.10	56.72	53.72	56.72		

SHB+	CONS	TYPE	FACT	SQ-FT	VALUE	a	*MAIN
2	B	F	M	672			
1	B	F	A	468		b	ADDTN
		OFF	P	116	3480	c	PORCH
		F/C	A	32		d	ADDTN
		WDD	P	172	2580	e	PORCH

Sale#	#p	sale date	To	Type/Invalid?	Sale\$	co:land	co:bldg
268	1	2017-06-12	SHORT MICHAEL L & REBECCA	1SD	114500	5800	111230
200	1	2011-05-20	TROUT JEANETTA E TRUSTEE	1AF *	0	7000	130740
414	1	1999-07-21	TROUT GERALD A & JEANETT	1QC *	0	6000	62540

Year	Land	Bldg	Total	Net Tax
2021	2210	43240	45450	2198.10
2020	2210	43240	45450	2230.76

p r o j e c t		ben acres	/ %	factor
107	GRASS RUN #933 - HOG CREEK			XA/2025
500	HARDIN COUNTY LANDFILL			XA/2025
110	HOG CREEK MAINLINE - HOG CR.			XA/2025
598	ADA LIGHTS			XV/2025
577	OTTAWA RIVER PROJECT MAINT			XA/2021

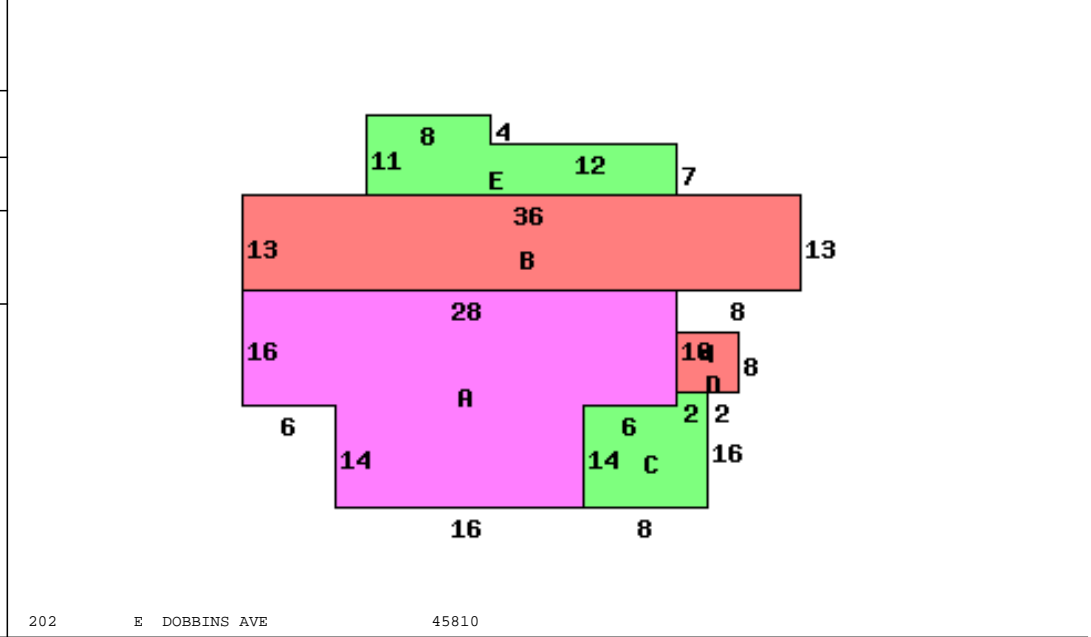

Occupancy	1 Single Family	*DWELLING COMPUTATIONS	
Story Height	2	Sq-Ft	Value
Floor Level	Main	FRAME	1172 103830
	Full Upper	FRAME	672 52250
	Basement		1140 21240
	Subtotal		177320
Shingle	Roof	GABLE	
	B 1 2 U A		
Plaster/Drywall	X X	Air Conditioning	3380
Unfinished Wall	X	Plumbing	2100
Floor/Hardwood	X X	Extra Features	6060
Floor/Carpet	X	Total Value	188860
Number of Rooms	1 4 3		
Bedrooms	3	PUB SIDEWALK	
Central Heat	A	Neighborhood:	
FORCED AIR		Code:	2500
Central A/C	A	Dwl/Gar/NC%	1.1900
Plumbing			
Standard	1		
Extra 3 Fixture	1		

Bldg Type	SHB+Cons	DixHt	Unit	Blt/Renov	Replace	Phy Fnc	True
1 DWELLING	2 B F	FtxFt	Area	Grade	Cond	Dpr Dpr	Value
		1844		C+	OLD/FR	.65	86530
front lot	acres/	effective	depth	depth	actual	extended	true
	frontage	frontage	factor	rate	rate	value	value
		50.00	150	100	130	130	6500

LIBERTY TWP
ADA CORP

00240

Hardin County, Ohio
Michael T. Bacon, Auditor

25-060049.0000
N71

RES
2025

CAMA / Cont: 1

SHB+	CONS	TYPE	FACT	SQ-FT	VALUE		
F	F	M		672		a	*MAIN
	OPF	P		192	5760	b	PORCH
	DK	P		112	1680	c	PORCH
	F2	G		672	16130	d	GRAGE

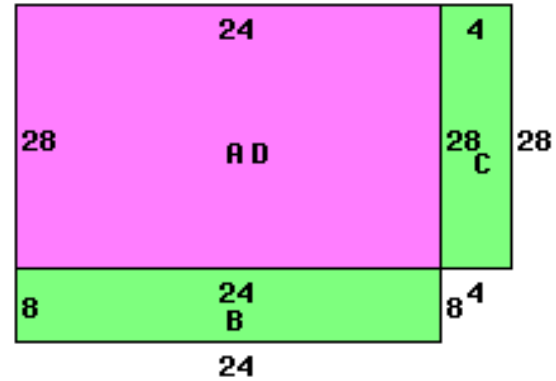

622 S JOHNSON ST 45810

Occupancy 1 Single Family		*DWELLING COMPUTATIONS	
		Sq-Ft	Value
Story Height	1		
Floor Level	Full Upper	672	52250
	Subtotal		52250
Shingle	Roof		
	B 1 2 U A		
Plaster/Drywall	X		
Unfinished Wall	X		
Floor/Carpet	X		
Floor/Tile-Lino	X		
Number of Rooms	1 4		
Bedrooms	2		
Central Heat	A		
FORCED AIR			
Plumbing			
Standard	1		
		Garages and Carports	16130
		Extra Features	7440
		Total Value	75820

Bldg Type	SHB+Cons	DixHt	Area	Unit	Grade	Blt/Renov	Replace	Phy	Fnc	True
2 DWELLING	1 F	FtxFt	672	Rate	C	Cond	Value	Dpr	Dpr	Value
						OLD/FR	75820	.65		31580

Call Back: - - - - Sign: Date: Lister: 25-060049.0000-v082020R