

LIBERTY TWP
ADA CORP

00240

Hardin County, Ohio
Michael T. Bacon, Auditor

25-050123.0000
M100

COM
2025

CAMA / Cont: 1

SHB+	CONS	TYPE	FACT	SQ-FT	VALUE		*MAIN
1	F/C	M		3128		a	
	PAT	P		80	240	b	PORCH
	PAT	P		80	240	c	PORCH
	PAT	P		80	240	d	PORCH

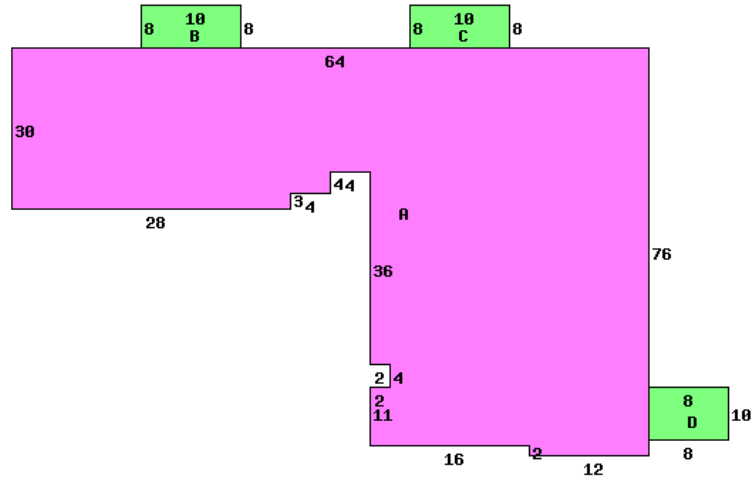

417 E LEHR AVE 45810

Occupancy 3 Tri-plex		*DWELLING COMPUTATIONS	
Story Height	Floor Level	Sq-Ft	Value
1	Main	3128	190180
	Subtotal		190180
	Roof		
Shingle	GABLE		
	B 1 2 U A		
Plaster/Drywall	D	Extra Living Units	7000
Floor/Carpet	X	Plumbing	9100
Floor/Tile-Lino	X	Extra Features	720
		Total Value	207000
Central Heat	A		
FORCED AIR			
Plumbing			
Standard	3		
Extra 3 Fixture	1		

Bldg Type	SHB+Cons	DixHt FtxFt	Area	Unit Rate	Grade	Blt/Renov Cond	Replace Value	Phy Dpr	Fnc Dpr	True Value
4 APTS	1 F/C		3128	53.82	C	1999AV	168350	.35		109430

Call Back: - - - - Sign: Date: Lister: 25-050123.0000-v082020R

CAMA / Cont: 2

SHB+	CONS	TYPE	FACT	SQ-FT	VALUE	a	*MAIN
1	F/C PAT	M P		2673 80	240	b	PORCH

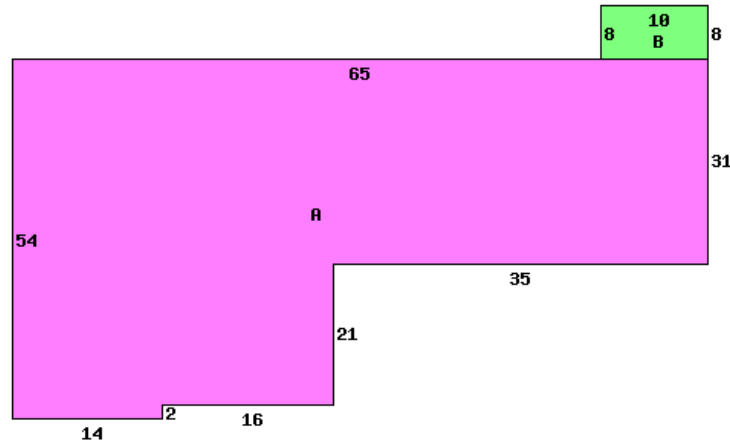

427 LEHR AVE 45810

Occupancy 2 Duplex		*DWELLING COMPUTATIONS	
Story Height	Floor Level	Sq-Ft	Value
1	Main	2673	172440
	Subtotal		172440
	Roof		
Shingle	B 1 2 U A		
Plaster/Drywall	D	Extra Living Units	3500
Floor/Carpet	X	Plumbing	7000
Floor/Tile-Lino	X	Extra Features	240
Number of Rooms	1 1	Total Value	183180
Bedrooms	5		
Central Heat	A		
ELECTRIC			
Plumbing			
Standard	2		
Extra 3 Fixture	1		
Extra 2 Fixture	1		

Bldg Type	SHB+Cons	DixHt FtxFt	Area	Unit Rate	Grade	Blt/Renov Cond	Replace Value	Phy Dpr	Fnc Dpr	True Value
5 APTS			2673	53.80	C	2000AV	143810	.30		100670

Call Back: - - - - Sign: Date: Lister: 25-050123.0000-v082020R