

LIBERTY TWP
ADA CORP

00240

Hardin County, Ohio
Michael T. Bacon, Auditor

25-020044.0000
L144

RES
2025

sale

Eff Rate:- 47.64 — 41.58 — 41.81 — 42.27 — a/r

2022 CRAWFORD SARAH & JOSH	2013-08-07
2023 CRAWFORD SARAH & JOSH	2013-08-07
2024 CRAWFORD SARAH & JOSH	2013-08-07
2025 CRAWFORD SARAH	2024-02-15 JOHNSONS S PT 24-25
224 E LINCOLN ST	1QC
ADA OH 45810	\$0

Tax Year	2022	2023	2024	2025	2025	CAMA
Prop Cls	510	510	510	510	510	510
Acres	4400	4540	4540	4540	4540	4550
Land100%	77860	116940	116940	116940	116940	116930
Bldg100%	82260t	121490t	121490t	121490t	121490t	121480t
Totl100%						
Cauv100%						

2027 CRAWFORD SARAH	2026-01-30
224 E LINCOLN ST	1QC
ADA OH 45810	

Tax Value:						
Land 35%	1540	1590	1590	1590	1590	1590
Bldg 35%	27250	40930	40930	40930	40930	40930
Totl 35%	28790t	42520t	42520t	42520t	42520t	42520t
Hmstd35%						
Owner Oc	26.72	36.50	36.32	36.26	36.48	
Hmstd RB						
Net Tax	1238.06	1585.48	1596.60	1605.14	1614.80	
Sp-Asmnt	45.59	55.90	52.90	55.90		

SHB+	CONS	TYPE	FACT	SQ-FT	VALUE	a	*MAIN
1QB	F	M		658		b	PORCH
	OFF	P		198	5940	c	PORCH
	EFF	P		36	1440	d	ADDTN
1 B	F	A		104		e	ADDTN
1QB	F	A		230		f	PORCH
B	EFF	P		70	2800	g	PORCH
	OFF	P		63	2520	h	PORCH
	DK	P		40	1200	i	PORCH
				150	2250		

Sale#	#p	sale date	To	Type/Invalid?	Sale\$	co:land	co:bldg
64	1	2026-01-30	CRAWFORD SARAH	1QC *	0	4540	116940
93	1	2024-02-15	CRAWFORD SARAH	1QC *	0	4540	116940
389	1	2013-08-07	CRAWFORD SARAH & JOSHUA	1WD	68000	4060	62430
285	1	1992-04-01		1UN	39000	0	29400

Year	Land	Bldg	Total	Net Tax
2021	1540	27250	28790	1360.52
2020	1540	27250	28790	1380.64

Project	ben acres	/ %	factor
107 GRASS RUN #933 - HOG CREEK			XA/2025
500 HARDIN COUNTY LANDFILL			XA/2025
110 HOG CREEK MAINLINE - HOG CR.			XA/2025
598 ADA LIGHTS			XV/2025
577 OTTAWA RIVER PROJECT MAINT			XA/2021

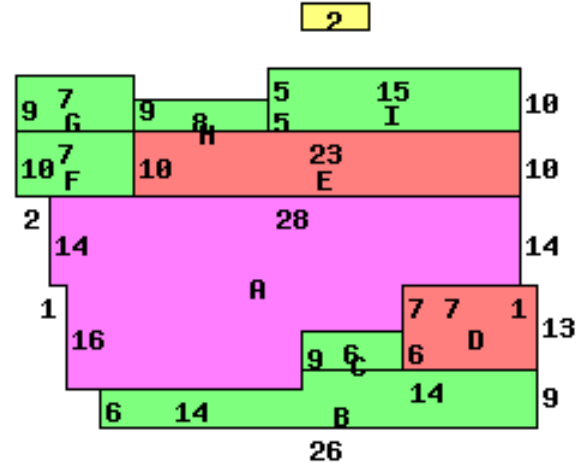

224 E LINCOLN AVE 45810

Occupancy 1 Single Family	*DWELLING COMPUTATIONS	
Story Height 1Q	Sq-Ft	Value
Floor Level		
Main	FRAME	992 104140
Qtr Story	FRAME	888 14200
Basement		1062 19800
Subtotal		138140
Shingle	Roof	GABLE
Plaster/Drywall	X	X
Unfinished Wall	X	
Floor/Hardwood	X	X
Floor/Carpet	X	
Number of Rooms	1	6
Bedrooms	2	2
Central Heat	A	
HOT WATER		
Central A/C	A	
Plumbing		
Standard	1	
Extra 3 Fixture	1	
Air Conditioning		3350
Plumbing		2100
Extra Features		16150
Total Value		159740
Neighborhood:		
Code:		2500
Dwl/Gar/NC%		1.1900

Bldg Type	SHB+Cons	DixHt	Unit	Blt/Renov	Replace	Phy	Fnc	True
1 DWELLING	1 BAF	FtxFt	Area	Grade	Cond	Value	Dpr	Dpr
2 Garage		14X24	992	C	OLD/GD	159740	.40	114050
			336	C	OLD/FR	8060	.70	2880
front lot	acres/	effective	depth	actual	effective	extended	true	
	frontage	frontage	depth	factor	rate	value	value	
	35.0000	35.00	151	100	130	4550	4550	