

LIBERTY TWP
ADA CORP

00240

Hardin County, Ohio
Michael T. Bacon, Auditor

25-010075.0000
L85

RES
2025

sale

2022 SALTZMAN RENTALS LLC	2021-06-23	
2023 SALTZMAN RENTALS LLC	2021-06-23	
2024 SALTZMAN RENTALS LLC	2021-06-23	
2025 SALTZMAN RENTALS LLC	2021-06-23 ORIGINAL PT 38-39	
125 E HIGHLAND AVE	16	
ADA OH 45810	\$0	

Eff Rate:-	47.64	41.58	41.81	42.27	a/r	
Tax Year	2022	2023	2024	2025	2025	CAMA
Prop Cls	530	530	530	530	530	530
Acres						
Land100%	8830	9110	9110	9110	9110	9100
Bldg100%	57230	76970	76970	76970	76970	76970
Totl100%	66060t	86090t	86090t	86090t	86090t	86070t
Cauv100%						
Tax Value:						
Land 35%	3090	3190	3190	3190	3190	3190
Bldg 35%	20030	26940	26940	26940	26940	26940
Totl 35%	23120t	30130t	30130t	30130t	30130t	30120t
Hmstd35%						
Owner Oc						
Hmstd RB						
Net Tax	1015.70	1149.34	1157.10	1163.10	1170.10	
Sp-Asmnt	77.34	82.60	79.60	82.60		

SHB+	CONS	TYPE	FACT	SQ-FT	VALUE	a	*MAIN
1T	F/C	M		958		b	ADDN
1	F/C	A		357		c	PORCH
1	OFF	P		90	2700	d	ADDN
F	F	A		41		e	ADDN
	F	A		70		f	PORCH
	CAN	P		56	450	g	PORCH
	PAT	P		56	170	h	PORCH
	PAT	P		209	630		

3-14-14 John Joseph Saltzman Rev Trust
6-29-18 Jerrold J & Michelle M Saltzman Trust

Sale#	#p	sale date	To	Type/Invalid?	Sale\$	co:land	co:bldg
267	16	2021-06-23	SALTZMAN RENTALS LLC	16 *	0	8830	57230
40	15	2020-01-31	SALTZMAN JERROLD J	15 *	0	8400	50570
39	15	2020-01-31	SALTZMAN JERROLD J & MICH	15 *	0	8400	50570
252	1	2018-06-29	SALTZMAN JERROLD J & MICH	1WD *	0	8400	50570
118	11	2014-03-14	SALTZMAN JOHN JOSEPH &	11 *	0	8110	48490

Year	Land	Bldg	Total	Net Tax
2021	3090	20030	23120	1118.14
2020	3090	20030	23120	1134.76

project	ben acres	%	factor
500 HARDIN COUNTY LANDFILL			XA/2025
107 GRASS RUN #933 - HOG CREEK			XA/2025
598 ADA LIGHTS			XV/2025
110 HOG CREEK MAINLINE - HOG CR.			XA/2025
577 OTTAWA RIVER PROJECT MAINT			XA/2021

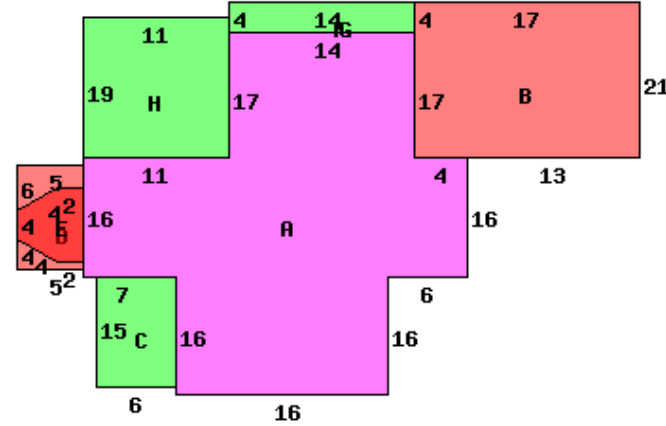

125 E HIGHLAND AVE 45810

Occupancy 1 Single Family	*DWELLING COMPUTATIONS
Story Height 1T	Sq-Ft Value
Floor Level	
Main	FRAME 1356 107860
Full Upper	FRAME 70 9060
Part Upper	FRAME 958 44790
Subtotal	161710
Shingle	Roof GABLE
Plaster/Drywall	X X 2 / Extra Living Units 7000
Floor/Pine	X X Plumbing 7000
Floor/Carpet	X Extra Features 3950
Floor/Tile-Lino	X Total Value 179660
Number of Rooms	5 4
Bedrooms	2 2 PUB SIDEWALK
Central Heat	A Neighborhood: Code: 2500
Plumbing Standard	3 Dwl/Gar/NC% 1.1900

Bldg Type	SHB+Cons	DixHt	Unit	Blt/Renov	Replace	Phy	Fnc	True
1 DWELLING	1T F/C	FtxFt	Area Rate	Grade	Cond Value	Dpr	Dpr	Value
		2384		C	OLD/AV 179660	.55	.20	76970
front lot	acres/ frontage	effective frontage	depth	depth factor	actual rate	effective rate	extended value	true value
		70.00	150	100	130	130	9100	9100