

LIBERTY TWP  
ADA SD

00230

Hardin County, Ohio  
Michael T. Bacon, Auditor

24-340029.0000  
AA12

RES  
2025

sale

Eff Rate:- 46.64 — 40.58 — 40.81 — 41.27 — a/r

|      |                        |            |                     |
|------|------------------------|------------|---------------------|
| 2022 | LONG EMILY & ALLISON   | 2017-07-24 |                     |
| 2023 | LONG EMILY & ALLISON   | 2017-07-24 |                     |
| 2024 | LONG EMILY & ALLISON   | 2017-07-24 |                     |
| 2025 | LONG EMILY & ALLISON E | 2017-07-24 | PT E 1/2 NW 1/4 S34 |
|      | 3414 CR 60             | 1SD        | 1.00A               |
|      | ADA OH 45810           | \$147,000  |                     |

|            |         |         |         |         |         |         |
|------------|---------|---------|---------|---------|---------|---------|
| Tax Year   | 2022    | 2023    | 2024    | 2025    | 2025    | CAMA    |
| Prop Cls   | 511     | 511     | 511     | 511     | 511     | 511     |
| Acres      | 1.0000  | 1.0000  | 1.0000  | 1.0000  | 1.0000  |         |
| Land100%   | 12600   | 25000   | 25000   | 25000   | 25000   | 25000   |
| Bldg100%   | 127940  | 146260  | 146260  | 146260  | 146260  | 146260  |
| Totl100%   | 140540t | 171260t | 171260t | 171260t | 171260t | 171260t |
| Cauv100%   |         |         |         |         |         |         |
| Tax Value: |         |         |         |         |         |         |
| Land 35%   | 4410    | 8750    | 8750    | 8750    | 8750    | 8750    |
| Bldg 35%   | 44780   | 51190   | 51190   | 51190   | 51190   | 51190   |
| Totl 35%   | 49190t  | 59940t  | 59940t  | 59940t  | 59940t  | 59940t  |
| Hmstd35%   |         |         |         |         |         |         |
| Owner Oc   | 44.42   | 49.96   | 49.70   | 49.62   | 49.92   |         |
| Hmstd RB   |         |         |         |         |         |         |
| Net Tax    | 2072.32 | 2182.58 | 2198.26 | 2210.30 | 2223.92 |         |
| Sp-Asmnt   | 24.00   | 24.00   | 21.00   | 24.40   |         |         |

|      |      |      |      |       |       |   |       |
|------|------|------|------|-------|-------|---|-------|
| SHB+ | CONS | TYPE | FACT | SQ-FT | VALUE | a | *MAIN |
| 1 B  | B    | M    |      | 1598  |       | b | GRAGE |
|      | B2   | G    |      | 506   | 14170 | c | PORCH |
|      | PAT  | P    |      | 140   | 420   | d | PORCH |
|      | OFF  | P    |      | 140   | 4200  |   |       |

| Sale# | #p | sale date  | To                        | Type/Invalid? | Sale\$ | co:land | co:bldg |
|-------|----|------------|---------------------------|---------------|--------|---------|---------|
| 352   | 1  | 2017-07-24 | LONG EMILY & ALLISON E WH | 1SD           | 147000 | 10510   | 127600  |
| 120   | 1  | 2011-04-07 | WILE BRADLEY M & AMELIA M | 1SD           | 137000 | 10490   | 134490  |
| 352   | 1  | 2005-06-06 | BRANCH JESSICA & KEITHEN  | 1             | 138000 | 8000    | 104940  |
| 531   | 1  | 2001-10-22 | RICHARDSON KEVIN & WENDY  | 1WD           | 125000 | 7710    | 87460   |
| 379   | 1  | 1996-06-28 | SPIVEY LARRY R & LAURA J  | 1WD           | 86500  | 13800   | 67000   |
| 160   | 1  | 1991-03-11 |                           | 1UN *         | 63000  | 0       | 70110   |
| 60    | 0  | 1987-01-27 |                           | *             | 60000  | 0       | 70110   |

| Year | Land | Bldg  | Total | Net Tax |
|------|------|-------|-------|---------|
| 2021 | 4410 | 44780 | 49190 | 2261.50 |
| 2020 | 4410 | 44780 | 49190 | 2315.92 |

| Project                          | ben acres | % | factor  |
|----------------------------------|-----------|---|---------|
| 107 GRASS RUN #933 - HOG CREEK   |           |   | XA/2025 |
| 500 HARDIN COUNTY LANDFILL       |           |   | XA/2025 |
| 110 HOG CREEK MAINLINE - HOG CR. |           |   | XA/2025 |
| 577 OTTAWA RIVER PROJECT MAINT   |           |   | XA/2021 |

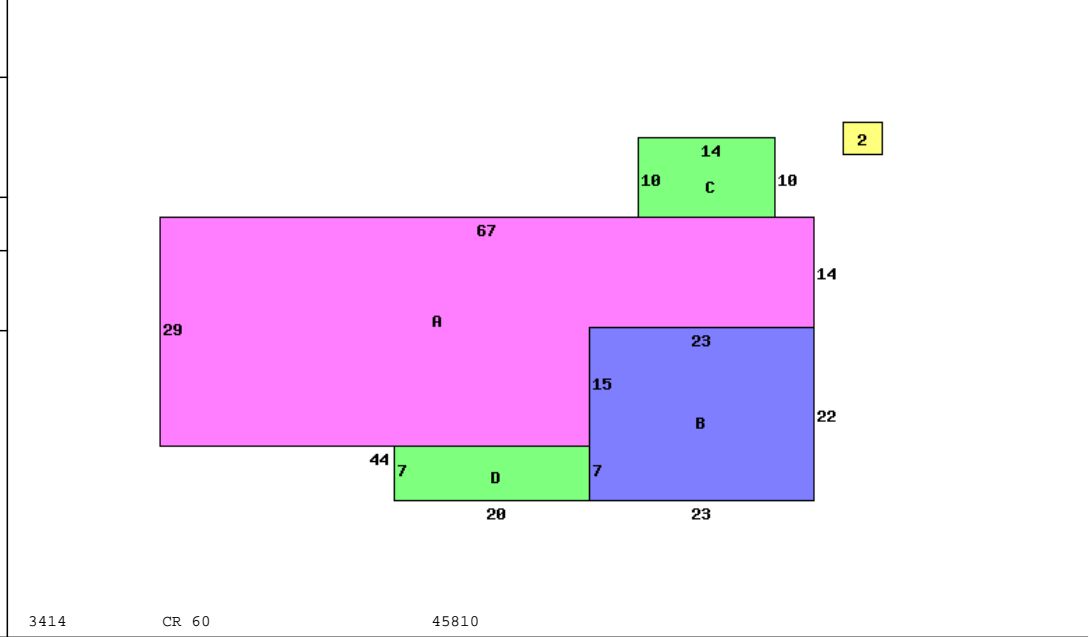

|                           |                        |                      |        |
|---------------------------|------------------------|----------------------|--------|
| Occupancy 1 Single Family | *DWELLING COMPUTATIONS |                      |        |
| Story Height 1            | Sq-Ft                  | Value                |        |
| Floor Level               |                        |                      |        |
|                           | Main                   | BRICK                |        |
|                           | Basement               |                      |        |
|                           | Subtotal               | 1598 138280          |        |
| Shingle                   | Roof                   | GABLE                |        |
|                           | Subtotal               | 1598 29560           |        |
|                           | Roof                   |                      |        |
| Plaster/Drywall           | D                      | Fireplaces           | 2000   |
| Floor/Carpet              | X                      | Air Conditioning     | 2830   |
| Floor/Concrete            | X                      | Plumbing             | 2100   |
| Floor/Tile-Lino           | L                      | Garages and Carports | 14170  |
| Number of Rooms           | 1 6                    | Extra Features       | 4620   |
| Bedrooms                  | 3                      | Total Value          | 193560 |
| Fireplace                 |                        | PUB ELECTRIC         |        |
| Openings                  | 1                      | PRIV WATER           |        |
| Stacks                    | 1                      | PRIV SEWER           |        |
| Central Heat              | A                      | PUB PAVED ST/RD      |        |
| FORCED AIR                |                        |                      |        |
| Central A/C               | A                      | Neighborhood:        |        |
| Plumbing                  |                        | Code:                | 2400   |
| Standard                  | 1                      | Dwl/Gar/NC%          | 1.2700 |
| Extra 3 Fixture           | 1                      |                      |        |

| Bldg Type  | SHB+Cons | DixHt              | Area  | Unit Rate   | Grade          | Blt/Renov      | Cond       | Replace Value | Phy Dpr | Fnc Dpr | True Value |
|------------|----------|--------------------|-------|-------------|----------------|----------------|------------|---------------|---------|---------|------------|
| 1 DWELLING | 1 B B    | 1598               |       |             | C              | 1976GD         |            | 193560        | .30     | .15     | 146260     |
| 2 Shed     | *NV      | 12X12              | 144   |             |                | OLD/           |            | 0             |         |         | 0          |
| homesite   | 1.0000   | effective frontage | depth | actual rate | effective rate | extended value | true value |               |         |         |            |

|            |                            |         |                         |
|------------|----------------------------|---------|-------------------------|
| Call Back: | Sign: PSN Date: 2015-09-01 | Lister: | 24-340029.0000-v082020R |
|------------|----------------------------|---------|-------------------------|