

LIBERTY TWP
ADA SD

00230

Hardin County, Ohio
Michael T. Bacon, Auditor

24-340029.0000
AA12

RES
2025

sale

Eff Rate:- 46.64 — 40.58 — 40.81 — 41.27 — a/r

2022 LONG EMILY & ALLISON	2017-07-24
2023 LONG EMILY & ALLISON	2017-07-24
2024 LONG EMILY & ALLISON	2017-07-24
2025 LONG EMILY & ALLISON E	2017-07-24 PT E 1/2 NW 1/4 S34
3414 CR 60	1SD 1.00A
ADA OH 45810	\$147,000

Tax Year	2022	2023	2024	2025	2025	CAMA
Prop Cls	511	511	511	511	511	511
Acres	1.0000	1.0000	1.0000	1.0000	1.0000	
Land100%	12600	25000	25000	25000	25000	25000
Bldg100%	127940	146260	146260	146260	146260	146260
Totl100%	140540t	171260t	171260t	171260t	171260t	171260t
Cauv100%						
Tax Value:						
Land 35%	4410	8750	8750	8750	8750	8750
Bldg 35%	44780	51190	51190	51190	51190	51190
Totl 35%	49190t	59940t	59940t	59940t	59940t	59940t
Hmstd35%						
Owner Oc	44.42	49.96	49.70	49.62	49.92	
Hmstd RB						
Net Tax	2072.32	2182.58	2198.26	2210.30	2223.92	
Sp-Asmnt	24.00	24.00	21.00	24.40		

SHB+ 1 B	CONS B	TYPE B2	FACT PAT	SQ-FT 1598	VALUE 14170	a *MAIN
	B2	G	P	506	420	b GRAGE
	PAT	P	P	140	420	c PORCH
	OFF	P	P	140	4200	d PORCH

Sale#	#p	sale date	To	Type/Invalid?	Sale\$	co:land	co:bldg
352	1	2017-07-24	LONG EMILY & ALLISON E WH	1SD	147000	10510	127600
120	1	2011-04-07	WILE BRADLEY M & AMELIA M	1SD	137000	10490	134490
352	1	2005-06-06	BRANCH JESSICA & KEITHEN	1	138000	8000	104940
531	1	2001-10-22	RICHARDSON KEVIN & WENDY	1WD	125000	7710	87460
379	1	1996-06-28	SPIVEY LARRY R & LAURA J	1WD	86500	13800	67000
160	1	1991-03-11		1UN *	63000	0	70110
60	0	1987-01-27		*	60000	0	70110

Year	Land	Bldg	Total	Net Tax
2021	4410	44780	49190	2261.50
2020	4410	44780	49190	2315.92

Project	ben acres	%	factor
107 GRASS RUN #933 - HOG CREEK			XA/2025
500 HARDIN COUNTY LANDFILL			XA/2025
110 HOG CREEK MAINLINE - HOG CR.			XA/2025
577 OTTAWA RIVER PROJECT MAINT			XA/2021

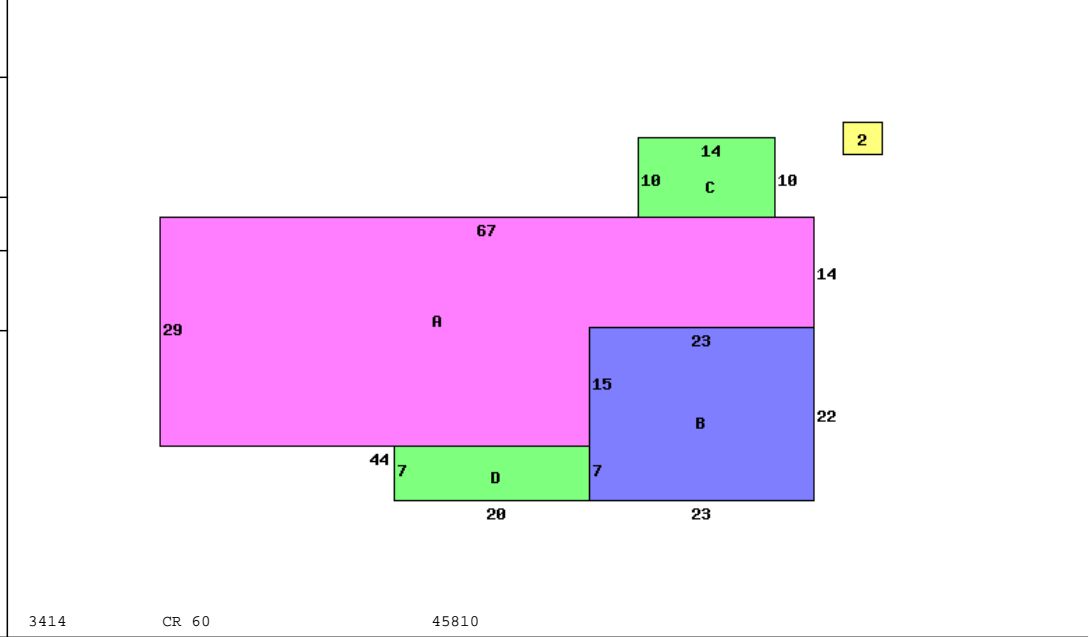

Occupancy 1 Single Family	*DWELLING COMPUTATIONS	
Story Height 1	Sq-Ft	Value
Floor Level	1598	138280
Main	1598	29560
Basement		167840
Subtotal		
Shingle	Roof	GABLE
Plaster/Drywall	D	Fireplaces 2000
Floor/Carpet	X	Air Conditioning 2830
Floor/Concrete	X	Plumbing 2100
Floor/Tile-Lino	L	Garages and Carports 14170
Number of Rooms	1 6	Extra Features 4620
Bedrooms	3	Total Value 193560
Fireplace		PUB ELECTRIC
Openings	1	PRIV WATER
Stacks	1	PRIV SEWER
Central Heat	A	PUB PAVED ST/RD
FORCED AIR		
Central A/C	A	Neighborhood:
Plumbing		Code: 2400
Standard	1	Dwl/Gar/NC% 1.2700
Extra 3 Fixture	1	

Bldg Type	SHB+Cons	DixHt	Area	Unit Rate	Grade	Blt/Renov	Cond	Replace Value	Phy Dpr	Fnc Dpr	True Value
1 DWELLING	1 B B	1598			C	1976GD		193560	.30	.15	146260
2 Shed	*NV	12X12	144			OLD/		0			0
homesite	1.0000	effective frontage	depth	actual rate	effective rate	extended value	true value				

Call Back:	Sign: PSN Date: 2015-09-01	Lister:	24-340029.0000-v082020R
------------	----------------------------	---------	-------------------------