

LIBERTY TWP
ADA SD

00230

Hardin County, Ohio
Michael T. Bacon, Auditor

24-330038.0000
JJ32

RES
2025

sale

Eff Rate:- 46.64 — 40.58 — 40.81 — 41.27 — a/r

| | |
|-----------------------------|----------------------------------|
| 2022 HALL GARY G & ANGELA | 1998-05-14 |
| 2023 HALL GARY G & ANGELA | 1998-05-14 |
| 2024 HALL GARY G & ANGELA | 1998-05-14 |
| 2025 HALL GARY G & ANGELA N | 1998-05-14 PT NW4 NW4 S33 1.439A |
| 2094 CR 60 | 1WD |
| ADA OH 45810 | \$85,000 |

| | | | | | | |
|----------|---------|---------|---------|---------|---------|---------|
| Tax Year | 2022 | 2023 | 2024 | 2025 | 2025 | CAMA |
| Prop Cls | 511 | 511 | 511 | 511 | 511 | 511 |
| Acres | 1.4390 | 1.4390 | 1.4390 | 1.4390 | 1.4390 | |
| Land100% | 13910 | 27200 | 27200 | 27200 | 27200 | 27200 |
| Bldg100% | 115630 | 127490 | 127490 | 127490 | 127490 | 127490 |
| Totl100% | 129540t | 154690t | 154690t | 154690t | 154690t | 154690t |
| Cauvl00% | | | | | | |

Orig Tax Year 1999
Parent: 24-330001.0000

| | | | | | | |
|------------|---------|---------|---------|---------|---------|----------------------|
| Tax Value: | 4870 | 9520 | 9520 | 9520 | 9520 | 9520 |
| Land 35% | 40470 | 44620 | 44620 | 44620 | 44620 | 44620 |
| Bldg 35% | 45340t | 54140t | 54140t | 54140t | 54140t | 54140t |
| Totl 35% | 44290 | 52560 | 52560 | 52560 | 52560 | 52560 |
| Hmstd35% | 40.00 | 43.80 | 43.58 | 43.50 | 43.78 | hmstd 8750 l 43810 b |
| Owner Oc | | | | | | |
| Hmstd RB | 1911.04 | 1972.72 | 1986.86 | 1997.74 | 2010.04 | |
| Net Tax | | | | | | |
| Sp-Asmnt | 27.00 | 27.00 | 24.00 | 27.00 | | |

| | | | | | | | |
|------|------|------|------|-------|-------|---|-------|
| SHB+ | CONS | TYPE | FACT | SQ-FT | VALUE | a | *MAIN |
| 1 | F/C | M | | 1260 | | b | PORCH |
| | EFP | P | | 108 | 4320 | c | PORCH |
| | OPF | P | | 32 | 960 | d | PORCH |
| 1 | DK | P | | 720 | 10800 | e | ADDTN |
| | F/C | A | | 576 | | | |

| | | | | | | | |
|-------|----|------------|------------------------|---------------|--------|---------|---------|
| Sale# | #p | sale date | To | Type/Invalid? | Sale\$ | co:land | co:blgd |
| 271 | 1 | 1998-05-14 | HALL GARY G & ANGELA N | 1WD | 85000 | 0 | 0 |

| | | | | |
|------|------|-------|-------|---------|
| Year | Land | Bldg | Total | Net Tax |
| 2021 | 4870 | 40470 | 45340 | 2104.08 |
| 2020 | 4870 | 40470 | 45340 | 2135.82 |

| | | | |
|----------------------------------|-----------|---|---------|
| project | ben acres | % | factor |
| 500 HARDIN COUNTY LANDFILL | | | XA/2025 |
| 107 GRASS RUN #933 - HOG CREEK | | | XA/2025 |
| 110 HOG CREEK MAINLINE - HOG CR. | | | XA/2025 |
| 322 HUBBELL - HOG CREEK | | | XA/2025 |
| 577 OTTAWA RIVER PROJECT MAINT | | | XA/2021 |

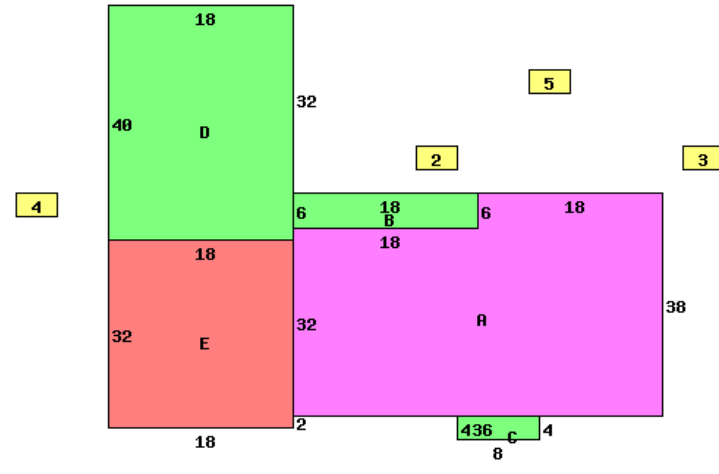

2094 CR 60 45810

| | | | |
|---------------------------|------------------------|------------------|-------------|
| Occupancy 1 Single Family | *DWELLING COMPUTATIONS | Sq-Ft | Value |
| Story Height 1 | | | |
| Floor Level | Main | FRAME | 1836 131400 |
| | Subtotal | | 131400 |
| Shingle | Roof | GABLE | |
| | B 1 2 U A | | |
| Plaster/Drywall | D | Air Conditioning | 3210 |
| Floor/Carpet | X | Plumbing | 2100 |
| Floor/Tile-Lino | L | Extra Features | 16800 |
| Number of Rooms | 7 | Total Value | 153510 |
| Bedrooms | 3 | | |
| Central Heat | A | PUB ELECTRIC | |
| Heat Pump | A | PRIV WATER | |
| Central A/C | A | PRIV SEWER | |
| Plumbing | | PUB PAVED ST/RD | |
| Standard | 1 | Neighborhood: | |
| Extra 3 Fixture | 1 | Code: | 2400 |
| | | Dwl/Gar/NC% | 1.2700 |

| | | | | | | | | |
|---------------|----------|-----------|--------|-----------|-----------|----------|-------|--------|
| Bldg Type | SHB+Cons | DixHt | Unit | Blt/Renov | Replace | Phy | Fnc | True |
| 1 DWELLING | 1 F/C | 1836 | | 1968AV | 153510 | .40 | | 116980 |
| 2 Upground C | *SV | 12X24 | 288 | OLD/FR | 400 | | | 400 |
| 3 Garage | | 24X32 | 768 | 1964AV | 18430 | .65 | | 8190 |
| 4 Flat Barn | | 40X50 | 2000 | 1945FR | 19200 | .80 | .50 | 1920 |
| 5 Shed | *PP | 10X12 | 0 | OLD/ | 0 | | | 0 |
| | acres/ | effective | depth | actual | effective | extended | true | |
| homesite | 1.0000 | frontage | depth | rate | rate | value | value | |
| small acreage | .4390 | | factor | 5000 | 5000 | 2200 | 2200 | |