

LIBERTY TWP
ADA SD

00230

Hardin County, Ohio
Michael T. Bacon, Auditor

24-330017.0000
JJ40

RES
2025

sale

Eff Rate:- 46.64 — 40.58 — 40.81 — 41.27 — a/r

| | | | | | |
|------|------------------------|------------|---------------------|--|--|
| 2022 | BUSCH CHARLES L & JOY | 2009-07-29 | | | |
| 2023 | BUSCH CHARLES L & JOY | 2009-07-29 | | | |
| 2024 | BUSCH CHARLES L & JOY | 2009-07-29 | | | |
| 2025 | GRAESSLE CONNIE S ETAL | 2024-06-04 | PT W 1/2 SW 1/4 S33 | | |
| | 5628 CR 35 | 2QC | 2.323A | | |
| | ADA OH 45810 | \$0 | | | |

| | | | | | | |
|------------|---------|---------|---------|---------|---------|-----------------------|
| Tax Year | 2022 | 2023 | 2024 | 2025 | 2025 | |
| Prop Cls | 511 | 511 | 511 | 511 | 511 | CAMA |
| Acres | 2.3200 | 2.3200 | 2.3200 | 2.3200 | 2.3200 | 511 |
| Land100% | 16570 | 31600 | 31600 | 31600 | 31600 | 31600 |
| Bldg100% | 247230 | 292630 | 292630 | 292630 | 292630 | 292620 |
| Totl100% | 263800t | 324230t | 324230t | 324230t | 324230t | 324220t |
| Cauv100% | | | | | | |
| Tax Value: | | | | | | |
| Land 35% | 5800 | 11060 | 11060 | 11060 | 11060 | 11060 |
| Bldg 35% | 86530 | 102420 | 102420 | 102420 | 102420 | 102420 |
| Totl 35% | 92330t | 113480t | 113480t | 113480t | 113480t | 113480t |
| Hmstd35% | 90940 | 111170 | 111170 | 111170 | 111170 | |
| Owner Oc | 82.14 | 92.64 | 92.16 | 92.02 | 92.60 | hmstd 8750 l 102420 b |
| Hmstd RB | 368.58 | 333.90 | 359.32 | | | |
| Net Tax | 3522.40 | 3800.18 | 3804.40 | 4186.52 | 4212.30 | |
| Sp-Asmnt | 30.00 | 30.00 | 24.00 | 31.27 | | |

| SHB+ | CONS | TYPE | FACT | SQ-FT | VALUE | a | *MAIN |
|------|------|------|------|-------|-------|---|-------|
| 1 | B | M | | 1640 | | b | ADDTN |
| 1 | B | A | | 462 | | c | ADDTN |
| 1 | B | A | | 352 | | d | GRAGE |
| | B2 | G | | 462 | 12940 | e | PORCH |
| | EMP | P | | 312 | 14040 | f | ADDTN |
| 1 | B | F | | 680 | | g | PORCH |
| | BAY | P | | 21 | 800 | h | PORCH |
| | BAY | P | | 33 | 1250 | i | PORCH |
| | PAT | P | | 848 | 2540 | | |

#: 22, L/W
243300220000 1.13a

| Sale# | #p | sale date | To | Type/Invalid? | Sale\$ | co:land | co:blgd |
|-------|----|------------|---------------------------|---------------|--------|---------|---------|
| 248 | 2 | 2024-06-04 | GRAESSLE CONNIE S ETAL | 2QC * | 0 | 31600 | 292630 |
| 216 | 2 | 2009-07-29 | BUSCH CHARLES L & JOYCE D | 2QC * | 0 | 14460 | 219340 |

| Year | Land | Bldg | Total | Net Tax |
|------|------|-------|-------|---------|
| 2021 | 5800 | 86530 | 92330 | 3878.06 |
| 2020 | 5800 | 86530 | 92330 | 3936.58 |

| project | ben acres | / % | factor |
|----------------------------------|-----------|-----|---------|
| 107 GRASS RUN #933 - HOG CREEK | | | XA/2025 |
| 500 HARDIN COUNTY LANDFILL | | | XA/2025 |
| 110 HOG CREEK MAINLINE - HOG CR. | | | XA/2025 |
| 577 OTTAWA RIVER PROJECT MAINT | | | XA/2021 |

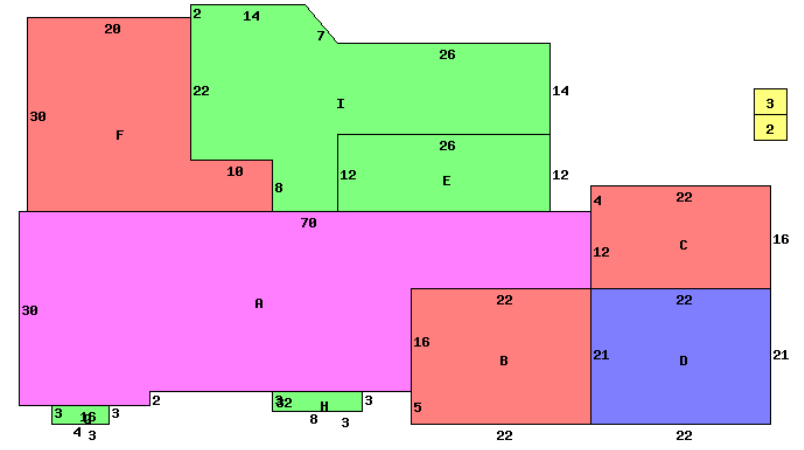

5628 CR 35 45810

| Occupancy 1 Single Family | | | *DWELLING COMPUTATIONS | |
|---------------------------|----|------------|------------------------|--------|
| Story Height | 1 | | Sq-Ft | Value |
| Floor Level | | Main BRICK | 3134 | 209600 |
| | | Basement | 2320 | 42640 |
| | | Subtotal | | 252240 |
| Shingle | | Roof GABLE | | |
| Plaster/Drywall | X | | Fireplaces | 2000 |
| Panelled Wall | X | | Air Conditioning | 5390 |
| Unfinished Wall | X | | Plumbing | 4200 |
| Floor/Hardwood | X | | Garages and Carports | 12940 |
| Floor/Carpet | X | | Extra Features | 18630 |
| Number of Rooms | 16 | | Total Value | 295400 |
| Bedrooms | 3 | | | |
| Fireplace | | | PUB ELECTRIC | |
| Openings | 1 | | PRIV WATER | |
| Stacks | 1 | | PRIV SEWER | |
| Central Heat | A | | PUB PAVED ST/RD | |
| FORCED AIR | | | Neighborhood: | |
| Central A/C | A | | Code: | 2400 |
| Plumbing | | | Dwl/Gar/NC% | 1.2700 |
| Standard | 1 | | | |
| Extra 3 Fixture | 2 | | | |

| Bldg Type | SHB+Cons | DixHt | Area | Unit Rate | Grade | Blt/Renov | Replace | Phy Dpr | Fnc Dpr | True Value |
|---------------|----------|-----------|-------|-----------|-----------|-----------|---------|---------|---------|------------|
| 1 DWELLING | 1 B B | | 3134 | | B | 1966AV | 384020 | .40 | | 292620 |
| 2 SHED | *PP | 8X12 | 96 | | | OLD/ | 0 | | | 0 |
| 3 P | *PP OFP | 3X8 | 24 | | | OLD/ | 0 | | | 0 |
| homesite | | effective | depth | actual | effective | extended | true | | | |
| small acreage | 1.0000 | frontage | depth | rate | rate | value | value | | | |
| | 1.3200 | | | 5000 | 5000 | 6600 | 6600 | | | |

Call Back:

Sign: PSN Date: 2015-09-09 Lister:

24-330017.0000-v082020R