

LIBERTY TWP
ADA SD

00230

Hardin County, Ohio
Michael T. Bacon, Auditor

24-310032.0000
HH13.01

RES
2025

sale

Eff Rate:- 46.64 — 40.58 — 40.81 — 41.27 — a/r

| | |
|----------------------------|---------------------------------|
| 2022 TOLAND RONALD M & JEN | 2021-11-05 |
| 2023 BOUGHAN HAYDEN | 2022-03-07 |
| 2024 BOUGHAN HAYDEN | 2022-03-07 |
| 2025 BOUGHAN HAYDEN | 2022-03-07 PT NE4 NE4 S31 2.00A |
| 0854 CR 60 | 1WD |
| ADA OH 45810 | \$50,000 |

| | | | | | | |
|----------|--------|--------|--------|---------|---------|---------|
| Tax Year | 2022 | 2023 | 2024 | 2025 | 2025 | CAMA |
| Prop Cls | 511 | 511 | 511 | 511 | 511 | 511 |
| Acres | 2.0000 | 2.0000 | 2.0000 | 2.0000 | 2.0000 | |
| Land100% | 15260 | 29400 | 29400 | 29400 | 29400 | 29410 |
| Bldg100% | 2740 | 3200 | 3200 | 153710 | 153710 | 153720 |
| Totl100% | 18000t | 32600t | 32600t | 183110t | 183110t | 183130t |
| Cauv100% | | | | | | |

Orig Tax Year 2022
Parent: 24-310009.0000

| | | | | | | |
|------------|--------|--------|--------|---------|---------|----------------------|
| Tax Value: | 5340 | 10290 | 10290 | 10290 | 10290 | 10290 |
| Land 35% | 960 | 1120 | 1120 | 53800 | 53800 | 53800 |
| Bldg 35% | 6300t | 11410t | 11410t | 64090t | 64090t | 64100t |
| Totl 35% | | | | 61780 | 61780 | |
| Hmstd35% | | | | 51.46 | 51.46 | |
| Owner Oc | | | | | | hmstd 8750 l 53030 b |
| Hmstd RB | | | | | | |
| Net Tax | 497.04 | 424.98 | 427.90 | 2416.38 | 2379.84 | |
| Sp-Asmnt | 18.00 | 18.00 | 18.00 | 18.00 | | |

| | | | | | | | |
|------|------|------|------|-------|-------|---|-------|
| SHB+ | CONS | TYPE | FACT | SQ-FT | VALUE | a | *MAIN |
| 2HB | F | M | | 1002 | | b | ADDN |
| 1 | F/C | A | | 280 | | c | PORCH |
| | DK | P | | 50 | 750 | d | GRAGE |
| | F | G | | 1008 | 24190 | e | PORCH |
| | OFF | P | | 278 | 8340 | | |

| | | | | | | | |
|-------|----|------------|---------------------------|---------------|--------|---------|---------|
| Sale# | #p | sale date | To | Type/Invalid? | Sale\$ | co:land | co:blgd |
| 106 | 1 | 2022-03-07 | BOUGHAN HAYDEN | 1WD | 50000 | 0 | 2740 |
| 594 | 1 | 2021-11-05 | TOLAND RONALD M & JENNIFE | 1FD | 40000 | 0 | 0 |

| | | | | |
|------|------|------|-------|---------|
| Year | Land | Bldg | Total | Net Tax |
| 2021 | 4520 | 960 | 5480 | 260.10 |

project
500 HARDIN COUNTY LANDFILL XA/2025 ben acres / % factor

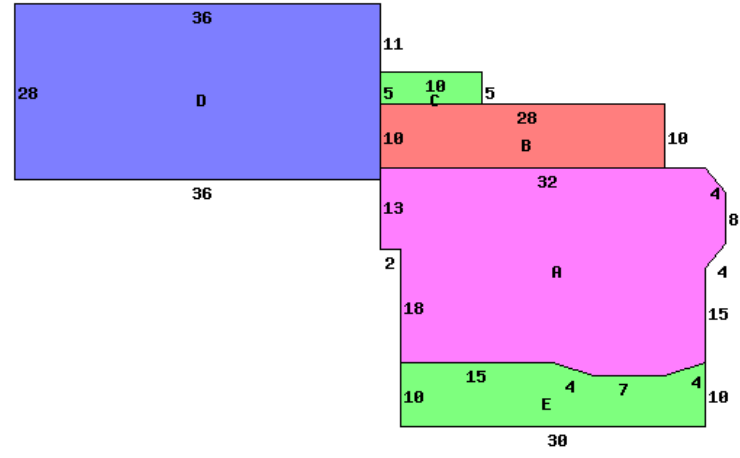

0854 CR 60 45810

| | |
|---------------------------|----------------------------|
| Occupancy 1 Single Family | *DWELLING COMPUTATIONS |
| Story Height 2H | Sq-Ft Value |
| Floor Level | |
| Main | FRAME 1282 105980 |
| Full Upper | FRAME 1002 60470 |
| Part Upper | FRAME 1002 37390 |
| Basement | 1002 18680 |
| Subtotal | 222520 |
| B 1 2 U A | |
| Unfinished Wall | Air Conditioning 5810 |
| Bedrooms | Plumbing 3500 |
| | Garages and Carports 24190 |
| Central Heat | Extra Features 9090 |
| FORCED AIR | Total Value 265110 |
| Central A/C | |
| Plumbing | |
| Standard | Neighborhood: 1 |
| Extra 3 Fixture | Code: 1 2400 |
| Extra 2 Fixture | Dwl/Gar/NC% 1 1.2700 |

| | | | | | | | | |
|--------------|----------|-------|------|-----------|---------|-----|-----|--------|
| Bldg Type | SHB+Cons | DixHt | Unit | Blt/Renov | Replace | Phy | Fnc | True |
| 2 Flat Barn | | 32X46 | Area | Cond | Value | Dpr | Dpr | Value |
| 7 Milk House | *NV | 10X14 | 140 | OLD/VP | 0 | | | 0 |
| 8 Lean-To | *SV | 24X32 | 768 | OLD/VP | 600 | | | 600 |
| 9 Lean-To | *SV | 18X70 | 1260 | OLD/VP | 100 | | | 100 |
| 10 Lean-To | *SV | 20X22 | 440 | OLD/VP | 100 | | | 100 |
| 11 DWELLING | 2HB F | | 3286 | 1913AV | 265110 | .55 | | 151510 |

| | | | | | | |
|----------|-----------|-------|--------|-----------|----------|-------|
| acres/ | effective | depth | actual | effective | extended | true |
| frontage | frontage | depth | rate | rate | value | value |
| .8821 | | | 5000 | 5000 | 4410 | 4410 |
| homesite | 1.0000 | | 25000 | 25000 | 25000 | 25000 |
| road | .1179 | | | | | |