

LIBERTY TWP  
ADA SD

00230

Hardin County, Ohio  
Michael T. Bacon, Auditor

24-280114.0000  
EE53.01

RES  
2025

sale

2023 UMPHRESS SUSAN J ETAL  
2024 UMPHRESS SUSAN J ETAL  
2025 HALL BLAKE A  
4249 SR 235  
ADA OH 45810  
2024-01-03 PT SE4 NE4 NE5 S28 .551A  
LWD  
\$100,000

Orig Tax Year 2025  
Parent: 24-280027.0000

Eff Rate:- 40.58 40.81 41.27 a/r

Tax Year	2023	2024	2025	2025	CAMA
Prop Cls	511	511	511	511	511
Acres			.5510	.5510	
Land100%		10510	19510	19510	19500
Bldg100%		115800	115800	115800	115790
Totl100%		126310t	135310t	135310t	135290t
Cauvl00%					
Tax Value:					
Land 35%		3680	6830	6830	6830
Bldg 35%		40530	40530	40530	40530
Totl 35%		44210t	47360t	47360t	47350t
Hmstd35%					
Owner Oc		36.66	39.20	39.44	
Hmstd RB		359.32			
Net Tax		1262.04	1746.42	1757.18	
Sp-Asmnt		18.00	18.00		

SHB+	CONS	TYPE	FACT	SQ-FT	VALUE		
1T	F/C	M		978		a	*MAIN
1	F/C	A		224		b	ADDTN
1	OFF	P		60	1800	c	PORCH
1	F/C	A		180		d	ADDTN
	EFF	P		60	2400	e	PORCH
	F2	G		672	16130	f	GRAGE
1	PAT	P		56	170	g	PORCH
1	F/C	A		56		h	ADDTN
1	F	A		102		i	ADDTN

gas fireplace

Sale#	#p	sale date	To	Type/Invalid?	Sale\$	co:land	co:bldg
3	1	2024-01-03	HALL BLAKE A	LWD	100000	0	0

Project  
500 HARDIN COUNTY LANDFILL XA/2025  
577 OTTAWA RIVER PROJECT MAINT XA/2021  
ben acres / % factor

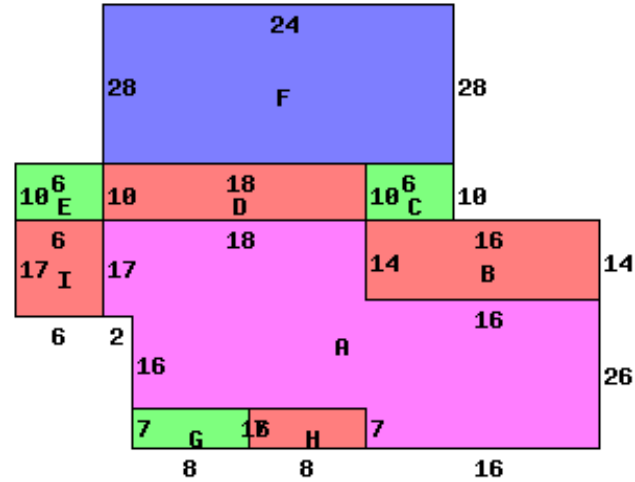

4249 SR 235 45810

Occupancy 1 Single Family		*DWELLING COMPUTATIONS	
Story Height	1T	Sq-Ft	Value
Floor Level	Main	FRAME	1540 121630
	Part Upper	FRAME	978 45720
	Subtotal		167350
Shingle	Roof	GABLE	
	B 1 2 U A		
Plaster/Drywall	X X	Plumbing	2100
Panelled Wall	X X	Garages and Carports	16130
Floor/Hardwood	X	Extra Features	4370
Floor/Pine	X X	Total Value	189950
Number of Rooms	3 3		
Bedrooms	3		
Central Heat	A	Neighborhood:	
HOT WATER		Code:	2400
Plumbing		Dwl/Gar/NC%	1.2700
Standard	1		
Extra 3 Fixture	1		

Bldg Type	SHB+Cons	DixHt	Area	Unit	Grade	Blt/Renov	Replace	Phy	Fnc	True
1 DWELLING	1T F/C	FtxFt	2518	Rate	C	Cond	Value	Dpr	Dpr	Value
		effective	depth	depth	actual	effective	extended	value	true	value
homesite	acres/	frontage	depth	factor	rate	rate	value	value	value	value
	.5510				25000	25000	19500	19500	19500	19500