

LIBERTY TWP
ADA SD

00230

Hardin County, Ohio
Michael T. Bacon, Auditor

24-280026.0000
EE54

RES
2025

sale

Eff Rate:- 46.64 — 40.58 — 40.81 — 41.27 — a/r

2022	HALL KENNETH A & AMY	2009-05-15		
2023	HALL KENNETH A & AMY	2009-05-15		
2024	HALL KENNETH A & AMY	2009-05-15		
2025	HALL KENNETH A & AMY C	2009-05-15	S 1/2 NE 1/4 NE 1/4 100 X	
	4223 SR 235		1SD 240 S28 .55A	
	ADA OH 45810	\$0		

Tax Year	2022	2023	2024	2025	2025	
Prop Cls	511	511	511	511	511	CAMA
Acres	.5500	.5500	.5500	.5500	.5500	511
Land100%	9830	19510	19510	19510	19510	19500
Bldg100%	239710	305510	305510	305510	305510	305520
Totl100%	249540t	325030t	325030t	325030t	325030t	325020t
Cauvl00%						
Tax Value:						
Land 35%	3440	6830	6830	6830	6830	6830
Bldg 35%	83900	106930	106930	106930	106930	106930
Totl 35%	87340t	113760t	113760t	113760t	113760t	113760t
Hmstd35%	86680	113080	113080	113080	113080	
Owner Oc	78.30	94.24	93.74	93.60	94.18	hmstd 6830 l 106250 b
Hmstd RB						
Net Tax	3680.08	4142.90	4172.66	4195.48	4221.34	
Sp-Asmnt	24.00	24.00	21.00	24.00		

SHB+	CONS	TYPE	FACT	SQ-FT	VALUE		
1 B	F	M		2108		a	*MAIN
	F	G		484	11620	b	GRAGE
	OFF	P		28	840	c	PORCH
	OFF	P		140	4200	d	PORCH

Sale#	#p	sale date	To	Type/Invalid?	Sale\$	co:land	co:bldg
143	1	2009-05-15	HALL KENNETH A & AMY C	1SD *	0	8170	84290
559	1	2008-11-13	HALL KENNETH A	1WD	148500	8180	84290
322	1	1999-06-11	GREEN KENT	1WD	125000	8570	55310

Year	Land	Bldg	Total	Net Tax
2021	3440	83900	87340	4051.66
2020	3440	83900	87340	4208.16

Project	ben acres	/ %	factor
107 GRASS RUN #933 - HOG CREEK			XA/2025
500 HARDIN COUNTY LANDFILL			XA/2025
110 HOG CREEK MAINLINE - HOG CR.			XA/2025
577 OTTAWA RIVER PROJECT MAINT			XA/2021

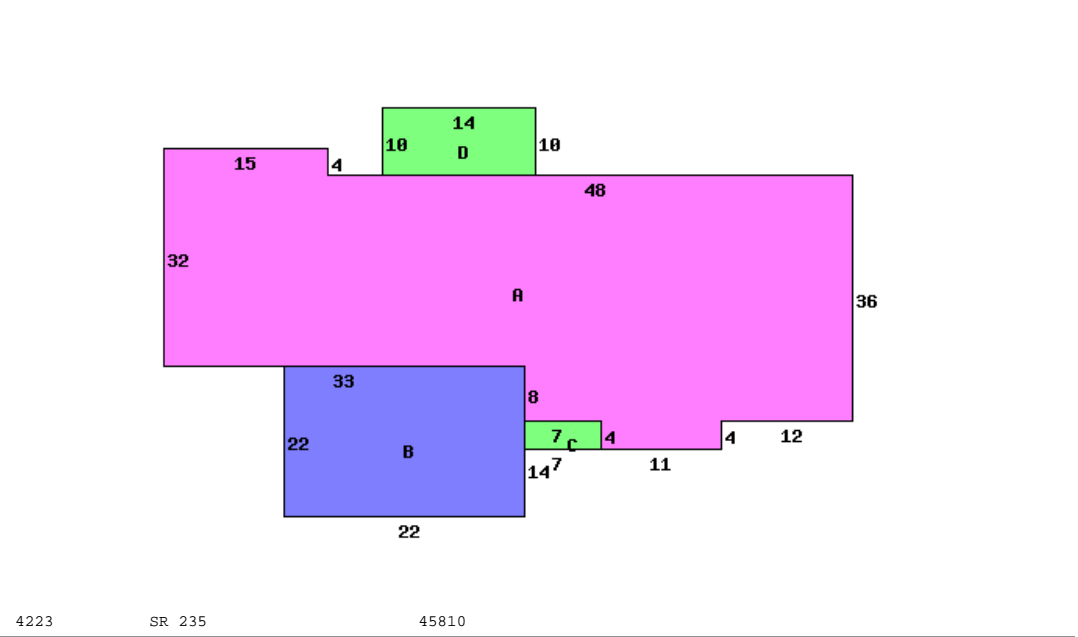

Occupancy 1 Single Family		*DWELLING COMPUTATIONS
Story Height 1		Sq-Ft Value
Floor Level	Main	FRAME 2108 142670
	Basement	2108 38850
	Subtotal	181520
Shingle	B 1 2 U A	
Plaster/Drywall	D	Air Conditioning 3670
Wood Joist Frame	X	Plumbing 3500
Floor/Hardwood	X	Garages and Carports 11620
Floor/Carpet	X	Extra Features 5040
Floor/Tile-Lino	X	Total Value 205350
Number of Rooms	1 5	
Bedrooms	3	PUB ELECTRIC
		PUB GAS
Insulation	X	PRIV WATER
Central Heat	A	PUB SEWER
ELEC/GAS		PUB PAVED ST/RD
Central A/C	A	
Plumbing		Neighborhood:
Standard	1	Code: 2400
Extra 3 Fixture	1	Dwl/Gar/NC% 1.2700
Extra 2 Fixture	1	

Bldg Type	SHB+Cons	DixHt	Area	Unit	Blt/Renov	Replace	Phy	Fnc	True
2 Shed		12X20	240	Rate	Grade	Cond	Value	Dpr	Dpr
3 DWELLING	1 B F		2108		B-	2019AV	2300	.15	1960
		acres/	effective	depth	actual	effective	extended	true	
		frontage	frontage	depth	rate	rate	value	value	
		.5500		factor	25000	25000	19500	19500	

homesite	
----------	--

Call Back:

Sign: PSN Date: 2015-09-03 Lister:

24-280026.0000-v082020R