

LIBERTY TWP
ADA SD

00230

Hardin County, Ohio
Michael T. Bacon, Auditor

24-220034.0000
S19

RES
2025

sale

Eff Rate:- 46.64 — 40.58 — 40.81 — 41.27 — a/r

2022 ROBERSON KELLI R	2001-01-17
2023 ROBERSON KELLI R	2001-01-17
2024 ROBERSON KELLI R	2001-01-17
2025 ROBERSON KELLI R	2001-01-17 PT NE1/4 S22 6.799A
3670 SR 81	2QC
ADA OH 45810	\$0

Tax Year	2022	2023	2024	2025	2025	CAMA
Prop Cls	511	511	511	511	511	511
Acres	6.8000	6.8000	6.8000	6.8000	6.8000	
Land100%	35770	67570	67570	67570	67570	67560
Bldg100%	294400	355340	355340	355340	355340	355330
Totl100%	330170t	422910t	422910t	422910t	422910t	422890t
Cauv100%						

2026 ROSE RHYS M & LAURIA R	2025-05-01
3670 SR 81	2SD
ADA OH 45810	

Tax Value:	12520	23650	23650	23650	23650	23650
Land 35%	103040	124370	124370	124370	124370	124370
Bldg 35%	115560t	148020t	148020t	148020t	148020t	148010t
Totl 35%	88980	111730	111730	111530	111530	
Hmstd35%	80.36	93.12	92.62	92.32	92.90	hmstd 8750 l 102780 b
Owner Oc						
Hmstd RB	4892.38	5420.10	5458.62	5488.48	5522.30	
Net Tax						
Sp-Asmnt	27.42	29.56	26.56	33.84		

SHB+ 2 BA	CONS B	TYPE M	FACT	SQ-FT 2118	VALUE 9770	a *MAIN
	OMP	P		279	9770	b PORCH
	STP	P		12	50	c PORCH
	OMP	P		167	5850	d PORCH

Sale#	#p	sale date	To	Type/Invalid?	Sale\$	co:land	co:bldg
169	2	2025-05-01	ROSE RHYS M & LAURIA R	2SD	675000	67570	355340
22	2	2001-01-17	ROBERSON KELLI R	2QC *	0	27000	235430
192	2	1999-05-06	CEDMEK ASSET MANAGEMENT	2QC *	0	34910	170030
847	2	1995-09-07	ROBERSON CRAIG R & KELLI	2WD	235000	34910	160570

Year	Land	Bldg	Total	Net Tax
2021	12520	109720	122240	5705.64
2020	12520	109720	122240	5770.92

p r o j e c t		ben acres	/ %	factor
107	GRASS RUN #933 - HOG CREEK			XA/2025
110	HOG CREEK MAINLINE - HOG CR.			XA/2025
500	HARDIN COUNTY LANDFILL			XA/2025
577	OTTAWA RIVER PROJECT MAINT			XA/2021

5 6 2 7 3

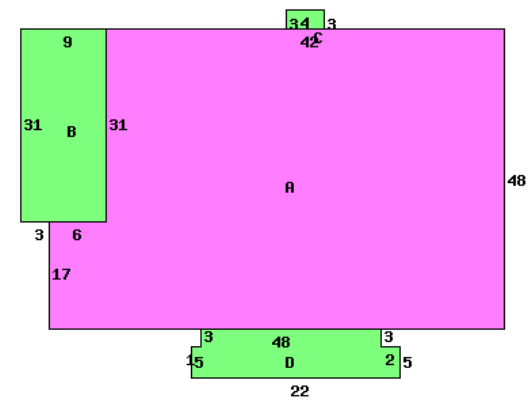

3670 SR 81 45810

Occupancy 1 Single Family		*DWELLING COMPUTATIONS	
Story Height	2	Sq-Ft	Value
Floor Level	Main	BRICK	2118 157690
	Full Upper	BRICK	2118 94680
	Qtr Story	BRICK	2118 7530
	Basement		2118 39040
	Subtotal		298940
Slate	Roof	HIP	

Bldg Type	SHB+Cons	DixHt	Unit	Blt/Renov	Replace	Phy	Fnc	True
1 DWELLING	2 B B	4236		C+	1908GD	.40		279700
2 Garage		26X44 1144		C	1908GD	.60		13950
3 Flat Barn	F 0	36X72 2592		D	OLD/VG	.80	.50	2490
5 Pole Build		48X32 1536		C	2002AV	.55		10020 CONCRET FL
6 P	OPF	6X7 42		C	2002AV	.55		570
7 Shed		14X14 196		D	1989AV	.65		660

Plaster/Drywall		Fireplaces		4000
Unfinished Wall	X	Air Conditioning		7380
Floor/Pine	X X	Plumbing		7700
Number of Rooms	1 5 4 1	Extra Features		15670
Bedrooms	4 1	Total Value		333690

homesite	acres/ frontage	effective frontage	depth	actual rate	effective rate	extended value	true value
homesite	1.0000			25000	25000	25000	25000
small acreage	4.5500			5000	3860	17560	17560
road	.2500						
homesite	1.0000			25000	25000	25000	25000

Fireplace		PUB ELECTRIC	
Openings	2	PUB GAS	
Stacks	2	PUB WATER	
Central Heat	A	PRIV SEWER	
HOT WATER		PUB PAVED ST/RD	
Central A/C	A		
Plumbing		Neighborhood:	
Standard	1	Code:	2400
Extra 3 Fixture	3	Dwl/Gar/NC%	1.2700
Extra 2 Fixture	1		

LIBERTY TWP
ADA SD

00230

Hardin County, Ohio
Michael T. Bacon, Auditor

24-220034.0000
S19

RES
2025

CAMA / Cont: 1

SHB+	CONS	TYPE	FACT	SQ-FT	VALUE		
1 B	F	M		1121		a	*MAIN
	EFP	P		48	1920	b	PORCH
	OFF	P		126	3780	c	PORCH

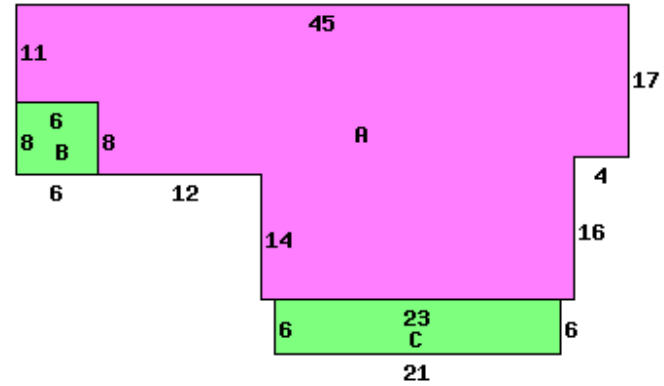

3670 SR 81 45810

Occupancy 1 Single Family		*DWELLING COMPUTATIONS	
		Sq-Ft	Value
Story Height	1		
Floor Level	Main	FRAME	1121 103460
	Basement		560 10660
	Subtotal		114120
Shingle	Roof	GABLE	
	B 1 2 U A		
Plaster/Drywall	X	Extra Features	5700
Unfinished Wall	X	Total Value	119820
Floor/Pine	X		
Number of Rooms	1 4		
Bedrooms	2		
Central Heat	A		
HOT WATER			
Plumbing			
Standard	1		

Bldg Type	SHB+Cons	DixHt	Area	Unit	Blt/Renov	Replace	Phy	Fnc	True
		FtxFt		Rate	Grade	Value	Dpr	Dpr	Value
8 DWELLING	1 B F		1121		C-	1930FR	107840	.65	47940

Call Back: - - - - Sign: Date: Lister: 24-220034.0000-v082020R