

LIBERTY TWP  
ADA SD

00230

Hardin County, Ohio  
Michael T. Bacon, Auditor

24-160017.0000  
G03

RES  
2025

sale

2022 ALLEN III ROBERT & JA  
2023 ALLEN III ROBERT & JA  
2024 ALLEN III ROBERT & JA  
2025 ALLEN III ROBERT & JANI  
2511 SR 235  
ADA OH 45810

N PT NE 1/4 SE 1/4 S16  
7.00A

\$0

Eff Rate:-	46.64	40.58	40.81	41.27	a/r	
Tax Year	2022	2023	2024	2025	2025	CAMA
Prop Cls	511	511	511	511	511	511
Acres	7.0000	7.0000	7.0000	7.0000	7.0000	
Land100%	36460	68740	68740	68740	68740	68750
Bldg100%	177340	196710	196710	196710	196710	196700
Totl100%	213800t	265460t	265460t	265460t	265460t	265450t
Cauv100%						
Tax Value:						
Land 35%	12760	24060	24060	24060	24060	24060
Bldg 35%	62070	68850	68850	68850	68850	68850
Totl 35%	74830t	92910t	92910t	92910t	92910t	92910t
Hmstd35%	47350	59240	59240	59240	59240	
Owner Oc	42.76	49.38	49.12	49.04	49.34	hmstd 8750 l 50490 b
Hmstd RB						
Net Tax	3177.30	3411.20	3435.32	3453.94	3475.24	
Sp-Asmnt	21.00	21.00	18.00	21.00		

SHB+	CONS	TYPE	FACT	SQ-FT	VALUE	a	*MAIN
1HB	F	M		1548		b	ADDTN
1	F/C	A		234		c	PORCH
	FFP	P		24	960	d	GRAGE
	F3	G		888	21310	e	PORCH
	OFF	P		88	2640	f	PORCH
	PAT	P		504	1510		

Sale#	#p	sale date	To	Type/Invalid?	Sale\$	co:land	co:blgd
571	0	1988-07-27		*	40000	0	64800
Year	Land	Bldg	Total	Net Tax			
2021	12760	62070	74830	3500.44			
2020	12760	62070	74830	3534.78			

project	ben acres	/ %	factor
110 HOG CREEK MAINLINE - HOG CR.			XA/2025
500 HARDIN COUNTY LANDFILL			XA/2025
577 OTTAWA RIVER PROJECT MAINT			XA/2021

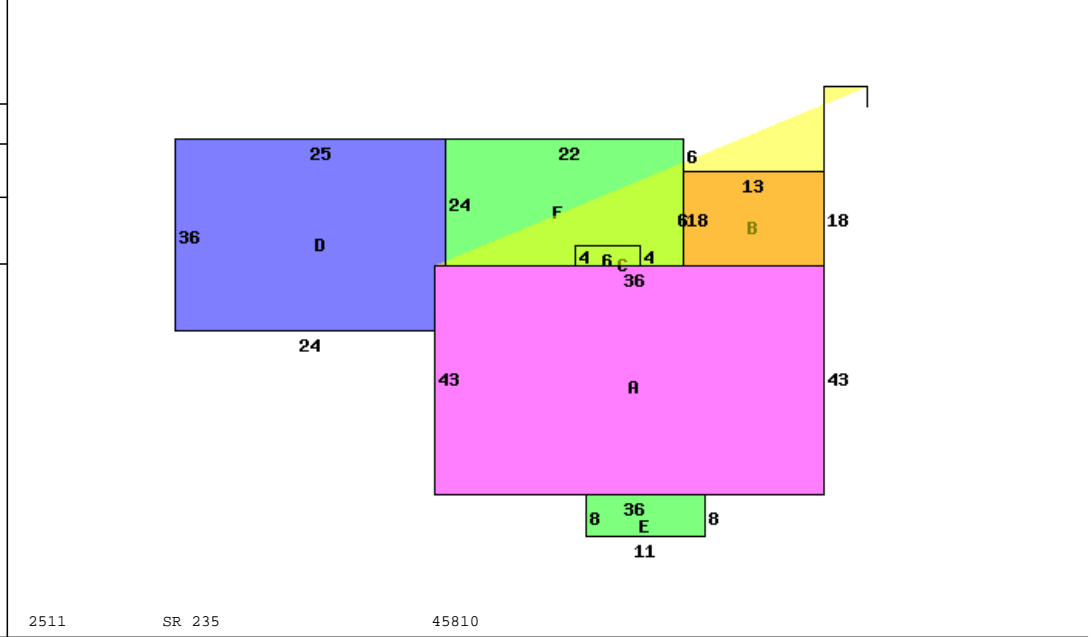

Occupancy	1 Single Family	*DWELLING COMPUTATIONS
Story Height	1H	Sq-Ft Value
Floor Level	Main	FRAME 1782 130070
	Part Upper	FRAME 1548 45250
	Basement	1161 21630
	Subtotal	196950
Shingle	Roof	GABLE
Plaster/Drywall	X X	Fireplaces 4000
Unfinished Wall	X	Plumbing 2100
Floor/Carpet	X X	Garages and Carpets 21310
Floor/Tile-Lino	X	Extra Features 5110
Number of Rooms	1 7 4	Total Value 229470
Bedrooms	3	
Fireplace		PUB ELECTRIC
Openings	2	PUB GAS
Stacks	2	PRIV WATER
Central Heat	A	PRIV SEWER
HOT WATER		PUB PAVED ST/RD
Plumbing		Neighborhood:
Standard	1	Code: 2400
Extra 3 Fixture	1	Dwl/Gar/NC% 1.2700

Bldg Type	SHB+Cons	DixHt	Unit	Blt/Renov	Replace	Phy Fnc	True
1 DWELLING	1HB F	PtxFt Area	Rate	Cond	Value	Dpr Dpr	Value
6 Pole Barn		60X36 3330		C+ OLD/AV	252420	.55	144260
		2160		C 1997AV	25920	.55	11660
homesite	acres/	effective	depth	actual	effective	extended	true
small acreage	frontage	frontage	depth	rate	rate	value	value
homesite	1.0000	25000	25000	25000	25000	25000	25000
	5.0000	5000	3750	18750	18750		
	1.0000	25000	25000	25000	25000		

2511	SR 235	45810
------	--------	-------

CAMA / Cont: 1

SHB+	CONS	TYPE	FACT	SQ-FT	VALUE		
1H	F/C	M		252		a	*MAIN
1	F/C	A		396		b	ADDTN
	STP	P		16	60	c	PORCH

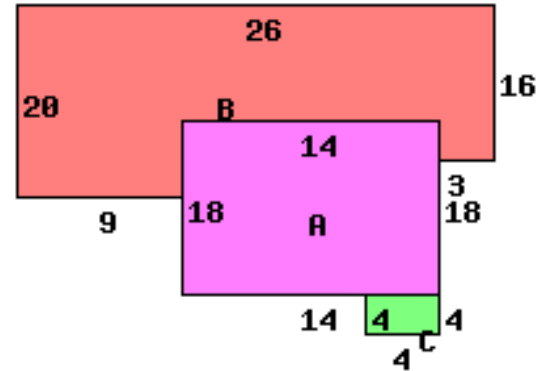

2511 SR 235 45810

Occupancy 1 Single Family		*DWELLING COMPUTATIONS	
		Sq-Ft	Value
Story Height	1H		
Floor Level	Main	FRAME	648 86550
	Part Upper	FRAME	252 15330
			Subtotal 101880
Metal	Roof	GABLE	
	B 1 2 U A		
Plaster/Drywall	X X	Extra Features	60
Floor/Carpet	X X	Total Value	101940
Number of Rooms	3 1		
Bedrooms	1		
Central Heat	A		
HOT WATER			
Plumbing			
Standard	1		

Bldg Type	SHB+Cons	DixHt	Area	Unit	Grade	Blt/Renov	Replace	Phy	Fnc	True
7 DWELLING	1H F/C	FtxFt		Rate		Cond	Value	Dpr	Dpr	Value
			900		D-	OLD/AV	71360	.55		40780

Call Back: - - - - Sign: Date: Lister: 24-160017.0000-v082020R